

XL78 ROCKPICKER OPERATORS MANUAL

This page intentionally left blank

Table of Contents

Warranty

PRESIDENT'S MESSAGE

Safety Precautions

1.0 Safety Messages

1.1 Decal Location and Placement (Part No. 70620)

2.0 Introduction & Pre-Delivery

2.1 General Description of XL-78 Rock Picker

2.2 Pre-Delivery Check List

3.0 Operating Instructions

3.1 Field Preparation

3.2 Pre-Start Instructions

3.3 Transporting Instructions

3.4 Apron Height Adjustment & Bucket Dumping

3.5 Field Instructions

3.6 Bucket Lock

4.0 Maintenance Instructions

4.1 Grease Locations

4.2 Rockpicker Reel Spring Removal

5.0 OPTIONS

5.1 Selector Valve Option (Part No. RPOSV(89042))

5.2 Clearance Light Option (Part No. RPOCL (89108))

5.2.1 Front Light Harness Assembly (Part No. 49889)

5.2.2 Rear Light Harness Assembly (Part No. 70646)

6.0 Specifications

Dealer Information

Identification Numbers

Dealer Checklist

Warranty

Highline New Agricultural Equipment Limited Warranty

*Effective January 1, 2004 One (1) Year / 12 Months
Parts and Labour*

Highline Manufacturing Ltd. (hereinafter "Highline") warrants this new Agricultural product of Highline's manufacturer to be free from defects in material and workmanship, under normal use and service for one (1) full year after initial purchase/retail sale. Highline will warrant its product for one (1) year parts and labour, if performed by a qualified Dealer. This Limited Warranty shall apply only to complete machines of Highline's manufacture, parts are covered by a separate Limited Warranty.

EQUIPMENT AND ACCESSORIES NOT OF HIGHLINE'S MANUFACTURE ARE WARRANTED ONLY TO THE EXTENT OF THE ORIGINAL MANUFACTURER'S WARRANTY AND SUBJECT TO THEIR ALLOWANCE TO HIGHLINE ONLY IF FOUND DEFECTIVE BY SUCH MANUFACTURER.

During the Limited Warranty period specified above, any defect in material or workmanship in any warranted item of Highline Agricultural Equipment not excluded below shall be repaired or replaced at Highline's option without charge by any authorized independent Highline Dealer. An authorized Dealer must make the warranty repair or replacement. Labour in accordance with Highline's labour reimbursement policy. Highline reserves the right to supply remanufactured replacement parts as it deems appropriate.

RETAIL PURCHASER RESPONSIBILITY: This Limited Warranty requires proper maintenance and periodic inspections of the Agricultural Equipment as indicated in the Operator's Manual furnished with each new Agricultural Equipment. The cost of routine or required maintenance and services is the responsibility of the retail purchaser. The retail purchaser is required to keep documented evidence that these services were performed. This Highline New Agricultural Equipment Limited Warranty may be subject to cancellation if the above requirements are not performed

EXCLUSIONS AND LIMITATIONS

The warranties contained herein shall **NOT APPLY TO:**

- (1) Any defect which was caused (in Highline's sole judgement) by other than normal use and service of the Agricultural Equipment, or by any of the following: (i) accident (ii) misuse or negligence (iii) overloading (iv) lack of reasonable and proper maintenance (v) improper repair or installation (vi) unsuitable storage (vii) non-Highline approved alteration or modification (viii) natural calamities (ix) vandalism (x) parts or accessories installed on Agricultural Equipment which were not manufactured or installed by Highline authorized Dealers (xi) the elements (xii) collision or other accident.
- (2) Any Agricultural Equipment whose identification numbers or marks have been altered or removed.
- (3) Any Agricultural Equipment which any of the required or recommended periodic inspection or services have been performed using parts not manufactured or supplied by Highline or meeting Highline Specifications including, but without limitation, lubricants (oil, grease), belt lacings, and hydraulic fluids.
- (4) Equipment used for rental, custom work, industrial and construction or if equipment is used for any other purpose than the intended agricultural application.
- (5) Any Agricultural Equipment used in demonstrations not performed by a Highline Dealer. Warranty will be at the discretion of Highline for all other demonstration warranty.
- (6) **New Agricultural Equipment delivered to the retail purchaser in which the warranty registration has not been completed and returned to Highline within ten (10) days from the date of purchase.**
- (7) Any defect that was caused (in Highline's sole judgement) by operation of the Agricultural Equipment not abiding by standard operating procedures outlined in the Operator's Manual.
- (8) Tire Limited Warranties and support are the responsibility of the respective product's manufacturer.
- (9) Transportation costs, if any, of transporting to the Highline Dealer.
- (10) In no event shall Highline's liability exceed the purchase price of the product.
- (11) Highline shall not be liable to any person under any circumstances for any incidental or consequential damages (including but not limited to, loss of profits, out of service time and damage to equipment which this equipment may be attached) occurring for any reason at any time.
- (12) Diagnostic and overtime labour premiums are not covered under this Limited Warranty Policy.
- (13) Depreciation damage caused by normal wear, lack of reasonable and proper maintenance, failure to follow operating instructions, misuse, and/or lack of proper protection during storage.
- (14) Accessory systems and electronics not of Highline's manufacture are warranted only to the extent of such manufacturer's respective Limited Warranty if any.
- (15) Wear items which are listed by product group below:

COMMON WEAR ITEMS: roller chain, sprockets, clutches, shear bolts, clutch components, chains, gearbox housings bolts/torqued parts, flails, feed roller belting, coupler chain, DRV couplers, bogie wheels, apron tines and hoses.

PARTS WARRANTY

Parts replaced in the warranty period will receive the balance of the one year New Agricultural Equipment Limited Warranty. Replacement parts after the original machine warranty are warranted to be free from defects of material for ninety (90) days or the part will be repaired or replaced, without labour coverage for removal and reinstallation.

EXCLUSION OF WARRANTIES. UNLESS OTHERWISE REQUIRED BY LAW, AND EXCEPT FOR THE WARRANTIES EXPRESSLY AND SPECIFICALLY MADE HEREIN, HIGHLINE MAKES NO OTHER WARRANTIES, AND ANY POSSIBLE LIABILITY OF HIGHLINE HEREIN UNDER IS IN LIEU OF ALL OTHER WARRANTIES, EXPRESS, IMPLIED, OR STATUTORY, INCLUDING, BUT NOT LIMITED TO, ANY WARRANTIES OF MERCHANTABILITY OR FITNESS FOR A PARTICULAR PURPOSE. HIGHLINE RESERVES THE RIGHT TO MODIFY, ALTER AND IMPROVE ANY PRODUCT WITHOUT INCURRING ANY OBLIGATION TO REPLACE ANY PRODUCT PREVIOUSLY SOLD WITH SUCH MODIFICATION. NO PERSON IS AUTHORIZED TO GIVE ANY OTHER WARRANTY, OR TO ASSUME ANY ADDITIONAL OBLIGATION ON HIGHLINE'S BEHALF.

PRESIDENT'S MESSAGE

CONGRATULATIONS ON YOUR PURCHASE OF THE XL78 ROCKPICKER MANUFACTURED BY HIGHLINE MANUFACTURING LTD. WE ARE A COMPANY WITH OVER 25 YEARS EXPERIENCE IN THE FARM IMPLEMENT MANUFACTURING INDUSTRY.

THIS OPERATOR'S MANUAL HAS BEEN PREPARED TO PROVIDE INFORMATION NECESSARY FOR SAFE AND EFFICIENT OPERATION OF YOUR ROCKPICKER. IN THE MANUAL YOU WILL FIND SAFETY PROCEDURES, INSTALLATION INSTRUCTIONS, MAINTENANCE ROUTINES AND DETAILED PARTS DIAGRAMS.

SHOULD THE NEED FOR ACQUIRING REPLACEMENT PARTS ARISE CALL YOUR HIGHLINE DEALER. IF YOUR DEALER DOES NOT HAVE THE PARTS YOU NEED IN STOCK, HIGHLINE'S PARTS DEPARTMENT IS READY TO PROMPTLY SHIP THE REQUIRED PARTS TO YOUR DEALER. ALSO, IF YOU FIND THAT YOU REQUIRE INFORMATION NOT COVERED IN THIS MANUAL, PLEASE FEEL FREE TO CONSULT YOUR LOCAL DEALER OR HIGHLINE MANUFACTURING LTD. HIGHLINE'S SERVICE DEPARTMENT IS ALWAYS READY TO BACK UP YOUR DEALERSHIP'S SERVICE PERSONNEL.

IN OUR CONTINUOUS EFFORT TO DESIGN AND MANUFACTURE EQUIPMENT THAT MEETS THE EVER-CHANGING NEEDS OF FARMERS, IMPROVEMENTS ARE MADE FROM TIME TO TIME. HIGHLINE MANUFACTURING LTD. RESERVES THE RIGHT TO MAKE THOSE CHANGES AND IMPROVEMENTS WHEN PRACTICAL TO DO SO WITHOUT INCURRING ANY OBLIGATION TO MAKE SUCH CHANGES AND IMPROVEMENTS ON MACHINES PREVIOUSLY SOLD. HIGHLINE MANUFACTURING LTD. THANKS AND CONGRATULATES YOU FOR SELECTING AN XL78 AS YOUR MACHINE OF CHOICE.

SINCERELY,

GERRY BOURGAULT, PRESIDENT
HIGHLINE MANUFACTURING LTD.

PO Box 307, VONDA, SASKATCHEWAN, S0K 4N0

PHONE 1-800-665-2010 FAX (306) 258-2010

INTERNET ADDRESS: [HTTP://WWW.HIGHLINEMFG.COM](http://www.highlinemfg.com)

Safety Precautions

WORK SAFELY – FOLLOW THESE INSTRUCTIONS

CAREFUL OPERATION IS THE BEST INSURANCE AGAINST AN ACCIDENT!

- Always disengage PTO and hydraulic motors before dismounting tractor.
- Do not operate unless guards are in place.
- Keep yourself and others clear of rotating parts to prevent injury.
- Never allow anyone to stand near rock picker while dumping or picking rocks.
- Never attempt to manually remove rocks from tines while hydraulic motor is engaged.
- Lower transport locks before raising bucket. To remove transport locks, raise apron slightly and lower brackets. DO NOT lift bucket when transport locks are in position otherwise severe damage WILL occur.
- Relieve pressure in hydraulic lines before disconnecting lines or performing maintenance on the hydraulic system.

1.0 Safety Messages

General safety messages appear in this Safety Messages section. Specific safety messages are located in appropriate sections of the manual where a potential hazard may occur if the instructions or procedures are not followed.

Understand Safety Alert Symbol

This is the safety alert symbol. This symbol placed on your machine or in the manual is used to alert you to the potential for bodily injury or death.



Understand Signal Words.

A signal word “**Danger**”, “**Warning**”, or “**Caution**” is used with the safety alert symbol.

Safety signs with signal word “**Danger**”, “**Warning**” or “**Caution**” are located near specific hazards.

Danger – Imminent hazards which, if not avoided, will result in serious personal injury or death.

Warning – Potential hazards or unsafe practices which, if not avoided, could result in serious personal injury or death.

Caution – Potential hazards or unsafe practices which, if not avoided, could result in minor personal injury or product or property damage.

Read, Understand, and Follow Safety Instructions

Read, understand and follow all instructions and safety messages included in this manual and on decals attached to the machine. These instructions and safety messages contain important information.

Allow only responsible, properly instructed individuals to operate and service the machine.

Failure to follow the instructions and safety messages in this manual and on the decals attached to the machine could result in serious injury or death.

Keep all safety and instruction decals in good condition. Replace any missing or damaged decals.



Keep Machine in Good Condition

Be sure the machine is in good operating condition and that all safety devices are installed and functioning properly.

Visually inspect the machine daily before starting the machine.

Make no modifications to your equipment unless specifically recommended or requested by Highline Manufacturing Ltd.

Keep Spectators Away From Machine

Keep all spectators and other workers away from the machine and work area while in operation.

Avoid Moving Parts

Contact with moving parts can cause death or serious injury.

Keep away from power-driven parts such as the reel.

Wear close-fitting clothing and confine long hair. Avoid wearing jewelry, such as rings, wrist watches, necklaces, or bracelets.

Avoid High Pressure Leaks

Pressurized fluid can penetrate body tissue and result in serious injury or death. Leaks can be invisible. Relieve pressure before working on system. When searching for a leak, use an object like cardboard – not your hand. Fluid injected under the skin must be removed immediately by a surgeon familiar with this type of injury.

Avoid Tire Explosion

Tire explosion can result if the following procedures are not followed:

- Maintain correct tire pressure. Do not inflated tire above recommended pressure.
- Low tire pressure can cause internal tire damage. Inflate to recommended pressure.
- Replace any tire with cuts or bubbles. Replace any damaged rims.
- Do not weld or heat wheel assembly. Heating will increase tire pressure.

Working on the Rock Picker

For your safety and safety of others, the Shutdown Procedure, described below, must be followed before dismounting from the tractor for inspecting, lubricating, cleaning, unplugging, servicing, or repairing the rock picker.

Warning: Failure to follow any of the above safety instructions, or those that follow within this manual, could result in serious injury or death. This machine is to be used only for those purposes for which it was intended, as explained in this Operator's manual.

Safety Decal Maintenance

Safety decals located on your machine contain important and useful information that will help you operate your equipment safely.

Decals will remain in good condition by following the instructions below:

- Keep decals clean. Use only soap and water – not mineral spirits, abrasive cleaners, or other similar cleaners that will damage or destroy the decal
- Replace any damaged or missing decals. When attaching decals, the temperature of the mounting surface must be at least 5°C (40°F). The mounting surface must also be clean and dry.
- When replacing a machine component with a decal attached, replace the decal also.
- Replacement decals can be purchased from your Highline equipment dealer.

SHUTDOWN PROCEDURE

Important: For your safety and the safety of others, this procedure must be followed before dismounting from the tractor for repairing, servicing, cleaning, and/or lubricating the rock picker.

A variation of this procedure may be used if so instructed within this manual, or the tractor manual, or if an emergency requires it.

- Step 1: Reduce the engine speed to idle.
- Step 2: Fully lower bucket and apron.
- Step 3: Disengage the PTO clutch and tractor hydraulics.
- Step 4: Set the tractor park brake.
- Step 5: Shut off tractor engine and remove key.



Warning: Never carry riders on towed machine. Falling from machine can cause serious injury or death.

Danger: Contact with pickup reel can cause serious injury or death. Keep away from moving pickup reel.



Warning: Raised bucket can fall and crush, causing serious injury or death. Before working under raised bucket, always lock the bucket for service. Do not work under loaded bucket.

Danger: Do not transport the rock picker on public roadways with rocks in the bucket. Rocks may fall out of the bucket, resulting in an accident. Deposit the rocks on a pile in the field, or load them directly onto a truck or trailer.

Warning: Do not transport the rock picker with the bucket raised. Machine damage is possible.

Warning: Always use both locks provided with the machine.

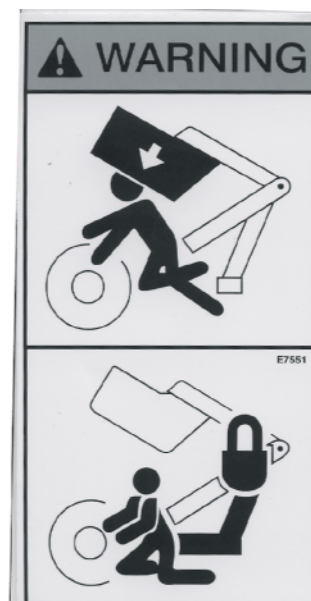

1.1 Decal Location and Placement (Part No. 70620)

ITEM NO.	PART NO.	DESCRIPTION	QTY.
1	30577	DECAL,RED REFL,2X9	2
2	30578	DECAL,AMBER REFL,2X9	2
3	32981	DECAL,PIMA	1
4	92598	DECAL,HIGHLINE,XL78,FRONT	1
5	92599	DECAL,HIGHLINE,XL78,BACK	1
6	92600	DECAL,HIGHLINE,XL78,LEFT	1
* 7	92601	DECAL,HIGHLINE,XL78,RIGHT	1
8	E7550	DECAL,DANGER,REEL_CRUSH	2
9	E7551	DECAL,WARNING,BUCKET_CRUSH	2
10	E7552	DECAL,WARNING,OWNERS_MANUAL	1
11	E7553	DECAL,WARNING,STOP_ENGINE/SERVICE	1
12	30208	PLT,SERIAL #	1

*Not shown

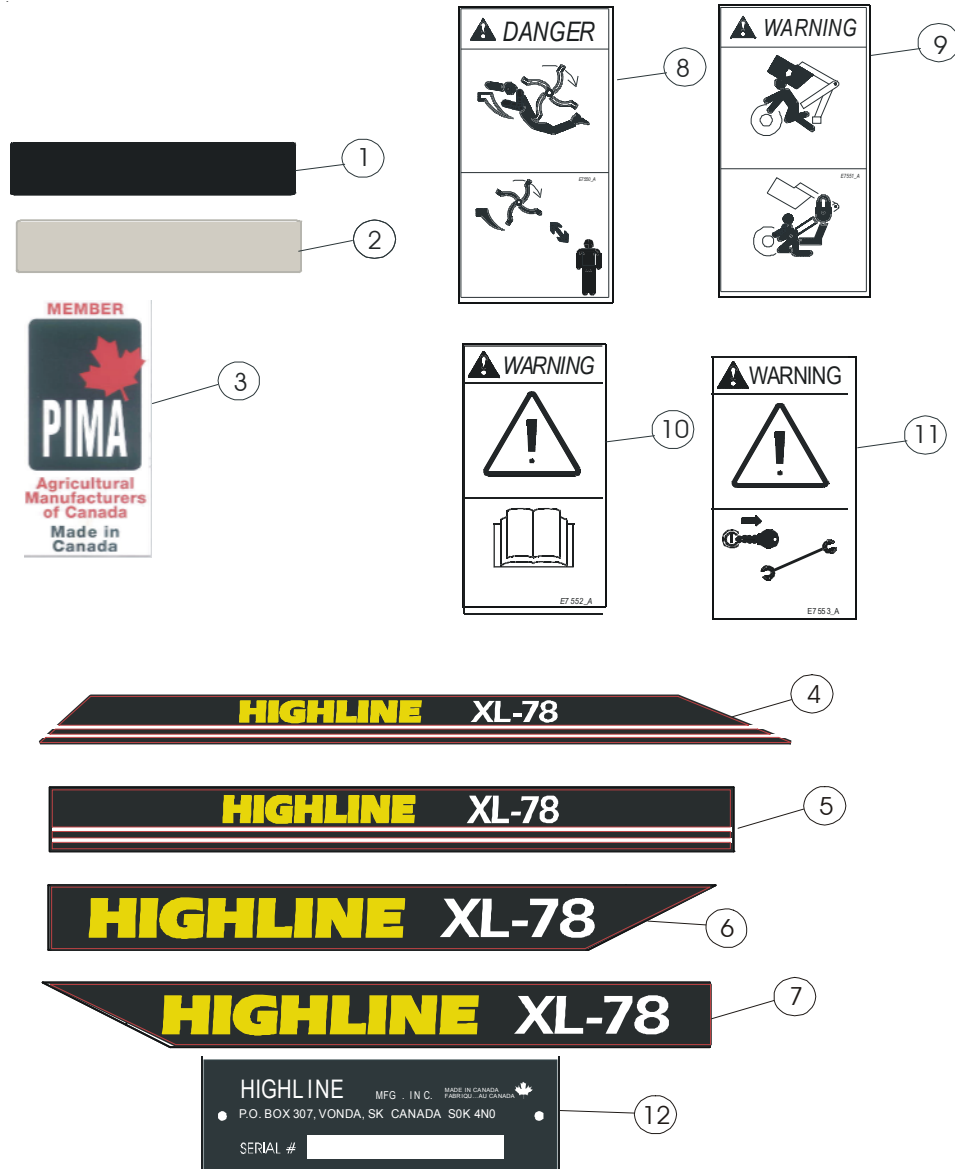



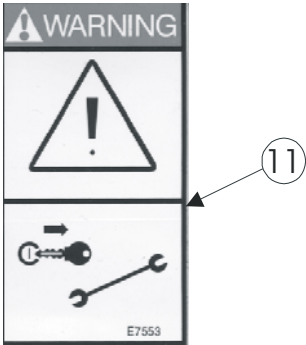
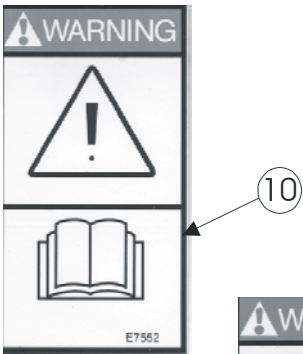
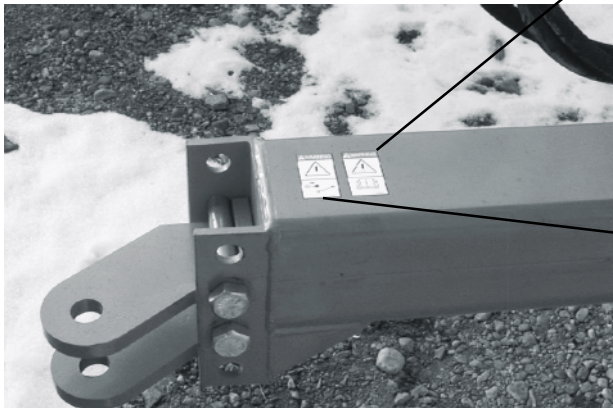
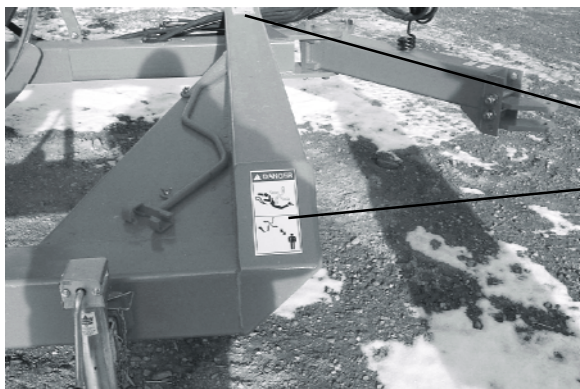

2.0 Introduction & Pre-Delivery

2.1 General Description of XL-78 Rock Picker

The XL-78 rock picker covers a width of 84" and has a dumping height of 90". One set of hydraulic lines are used for dumping and lowering the picker's collecting apron. The rock picker reel is hydraulically driven by the second circuit and the reel may be reversed if the rock picker becomes plugged.

2.2 Pre-Delivery Check List

The following is a list of parts required if the XL-78 rock picker has not been assembled prior to delivery. If any parts are not included, contact your authorized Highline dealer or **Highline Manufacturing Ltd.**

Qty.	Description	Part Number
1	XL78 ROCKPICKER	
2	TIRE ASSY, 21 IN, 10 PLY	33036
2	AXLE ASSEMBLY	70601
8	BOLT, HEX, 3/4" X 2-1/2", UNC, GR5	31040
8	NUT, NYLOCK, 3/4", UNC	31175
8	WASHER, LOCK, 3/4", PLATED	31246

3.0 Operating Instructions

3.1 Field Preparation

Field preparation plays a major role in the picking performance of the XL-78. For best picking conditions, the field should be cultivated prior to picking. This operation brings stones to the surface and buries field residue.

3.2 Pre-Start Instructions

Transport locks need to be lowered before operation. To lower transport locks, raise apron slightly and lower transport locks towards the front of the machine. DO NOT lower apron when transport locks are in position otherwise severe damage WILL occur.

Figure 1 - Locks in Transport Position

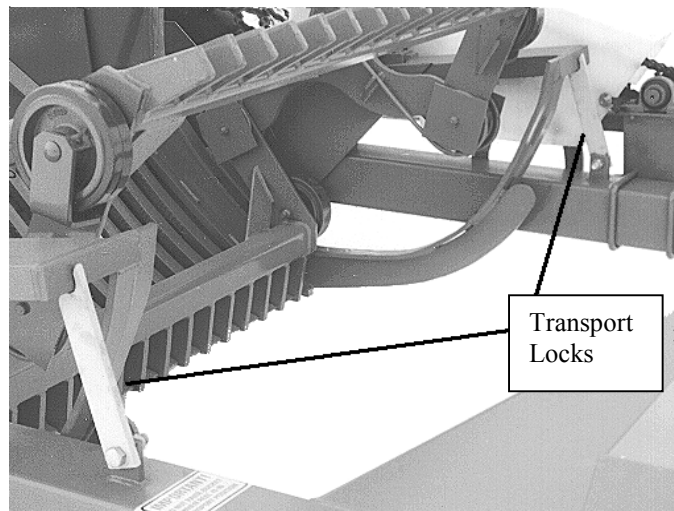

3.3 Transporting Instructions

To transport the XL-78 rock picker, the operator must install the transport locks and raise the apron to prevent dragging. To put transport locks in place, turn the locks back and raise the apron until the transport locks catch on the apron frame. To lower transport locks, raise apron until locks are free and turn them forward. See figure 1 above.

For road transport, the hitch can be turned to reduce the travel width of the rock picker. To change the position of the hitch, remove wedge (Figure 2) and turn the hitch. The wedge is then placed back into position and ready for field or transport.

WARNING:*ON MACHINES WITH HYDRAULICALLY OPERATED HITCH IS INSTALLED THE WEDGE MUST STILL BE USED TO PREVENT CYLINDER LUG CRACKING/BREAKAGE. YOU MUST REMOVE WEDGE BEFORE OPERATING CYLINDER TO PREVENT EXTENSIVE DAMAGE TO THE MACHINE.

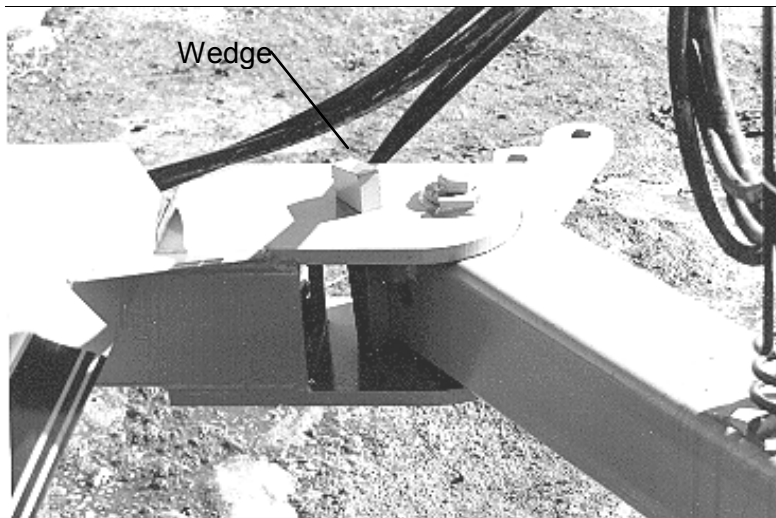
Figure 2 - Hitch Wedge

3.4 Apron Height Adjustment & Bucket Dumping

The apron (Figure 3) height is adjustable through the hydraulic cylinders. By retracting the cylinders completely, the apron will be at its highest picking level. The working height of the apron will depend upon the soil conditions and the size of rocks. By extending the cylinder, the apron will lower. Extending the cylinder more will raise the bucket into dumping position.

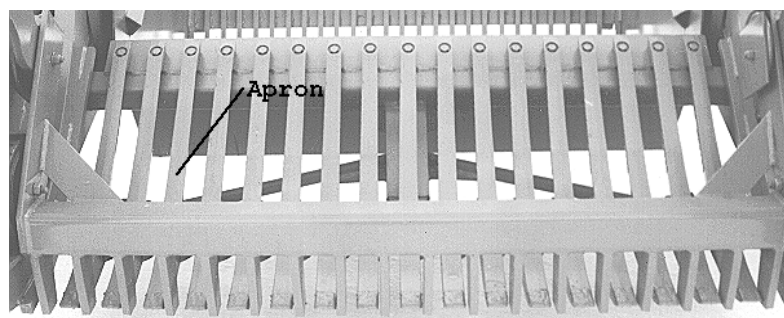
Figure 3 - Front View of Apron

3.5 Field Instructions

For proper operation, the XL-78 should run at a field speed of 3-4 mph (4.8-6.5 km/h) with the reel rotating at 35 rpm. When picking large rocks, field speed should be decreased to reduce possible damage due to large impacts. The operating height of the apron varies depending on the size of stones picked. For small stones, the apron should be as low as possible to the ground and be raised to a suitable level for larger stones.

3.6 Bucket Lock

Two bucket locks are stored at the back of the machine. These locks fit on the cylinder shafts and prevent the bucket from falling when raised to perform maintenance on the Rockpicker. Highline Manufacturing Ltd. does not recommend working under a loaded bucket.

To use locks:

1. Unload bucket of all accumulated rocks.
2. Raise bucket high enough so locks fit on cylinder shafts.
3. Remove locks from storage location as shown below.
4. Install one lock on each cylinder and secure in place with retaining pin.

To remove locks:

1. Raise bucket to remove pressure from locks.
2. Remove locks from cylinders and return them to their storage position.

Both locks must be removed before hydraulic pressure is applied to lower the bucket. WARNING: FAILURE TO REMOVE BOTH LOCKS MAY RESULT IN DAMAGE TO THE ROCKPICKER.

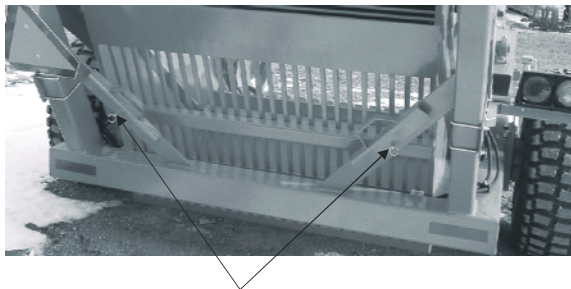

4.0 Maintenance Instructions

- To ensure a long operating life of your XL-78 Rock Picker, follow this maintenance procedure.
- Check and adjust tire air pressure to 27 psi. If tire pressure is not maintained, severe tire damage may result. Wheel bolts torqued to 85-100 lbs ft dry.
- Check gearbox oil and add #90 gear oil if needed. Fill to bottom fill plug located on face of gearbox. Approx 1 litre of oil.
- Periodically check all bolts and set screws for tightness.
- Grease the following points as described:

4.1 Grease Locations

Figure 4 - Hitch Grease Location

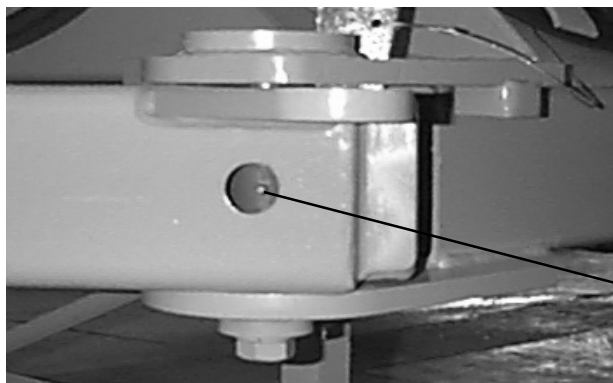

GREASE NO.	DESCRIPTION	FREQUENCY
1	Hitch Pivot	50 hrs/Weekly

Figure 5 - Reel Greasing Location



GREASE NO.	DESCRIPTION	FREQUENCY
2	Reel Bearings	100 hrs/Yearly

Figure 6 - Apron and Tire Maintenance Locations



GREASE NO.	DESCRIPTION	FREQUENCY
3	Apron Pivot	10 hrs/Daily
4	Wheel Hub	100 hrs/Yearly

3

4

Figure 7 - Dump Mechanism Grease Locations

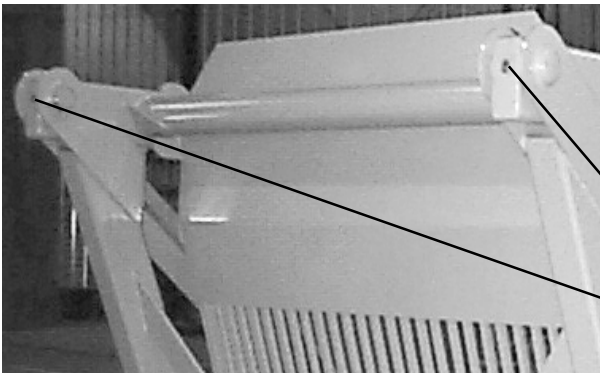

GREASE NO.	DESCRIPTION	FREQUENCY
5	Front Bucket Pivot	50 hrs/Weekly

5

4.2 Rockpicker Reel Spring Removal

1. Loosen 9/16 reel pivot bolt to allow internal movement of spring. See Figure 1

Figure 1

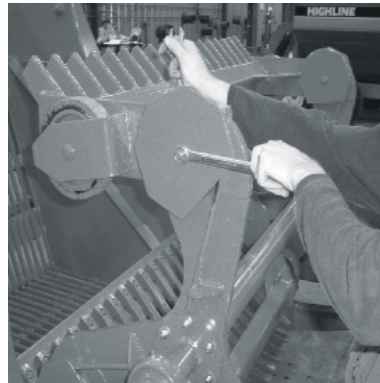

2. Remove spring tool from storage location and place as shown in Figure 2.

Figure 2



3. Apply downwards force to release spring from catch as shown in Figure 3&4.

Figure 3

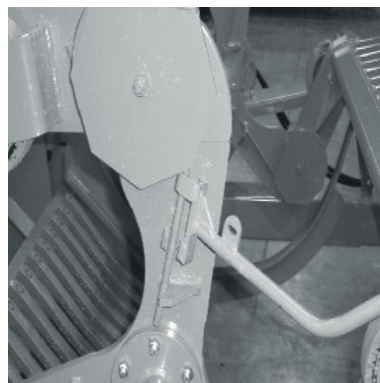
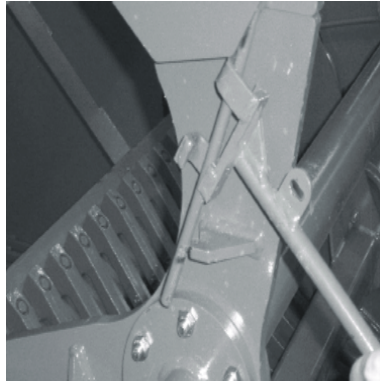

Figure 4



4. Slowly allow spring to return to released position as shown in Figure 5&6.
Release both springs on dual spring reel when replacing a broken/worn spring.

Figure 5

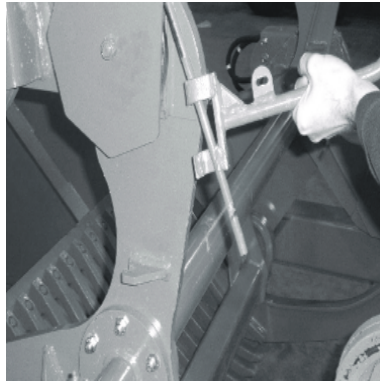
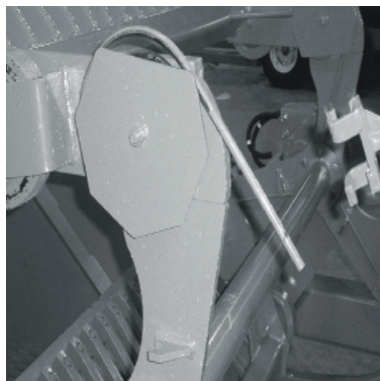

Figure 6



5. Remove bolt and spring retainer plate. Remove old/broken spring.
6. Install new spring and re-install bolt and spring retainer plate leaving bolt slightly loose.
7. Re-tension springs by reversing Step 1-4.
8. Retighten 9/16 bolt to hold spring retainers tight.
9. Return spring tool to storage location and re-secure with wing nut.

5.0 OPTIONS

5.1 Selector Valve Option (Part No. RPOSV(89042))

ITEM NO.	PART NO.	DESCRIPTION	QTY.
1	70605	WLDT, GUARD, DBL_VALVE, RP	1
2	E6174	PIPE, SMLS, 7/8x.188x1L	2
3	E6879	BRACKET, DBL_VALVE_MOUNT, RP	1
4	30152	HYD, FIT, ADAPTER, 8MB-8FJX	2
5	30215	HYD, FIT, ADAPTER, 8MB-8MJ	4
6	31965	HYD, VALVE, DOUBLE_SELECTOR	1
7	33236	KNOB, VALVE_SELECTOR, 3/8-16 UNC	1
8	33237	HYD, HOSE, 3/8X36, 8FJX-8FJX, 1W	1
9	90313	HYD, HOSE, 3/8X18, 8FJX-8FJX, 1W	1
10	31781	BOLT, HEX, 3/8X3-1/2, UNC, GR5, ZP	2
11	31176	NUT, NYLOCK, 3/8, UNC, ZP	2
12	31163	NUT, HEX, 1/2, UNC, GR5, ZP	1

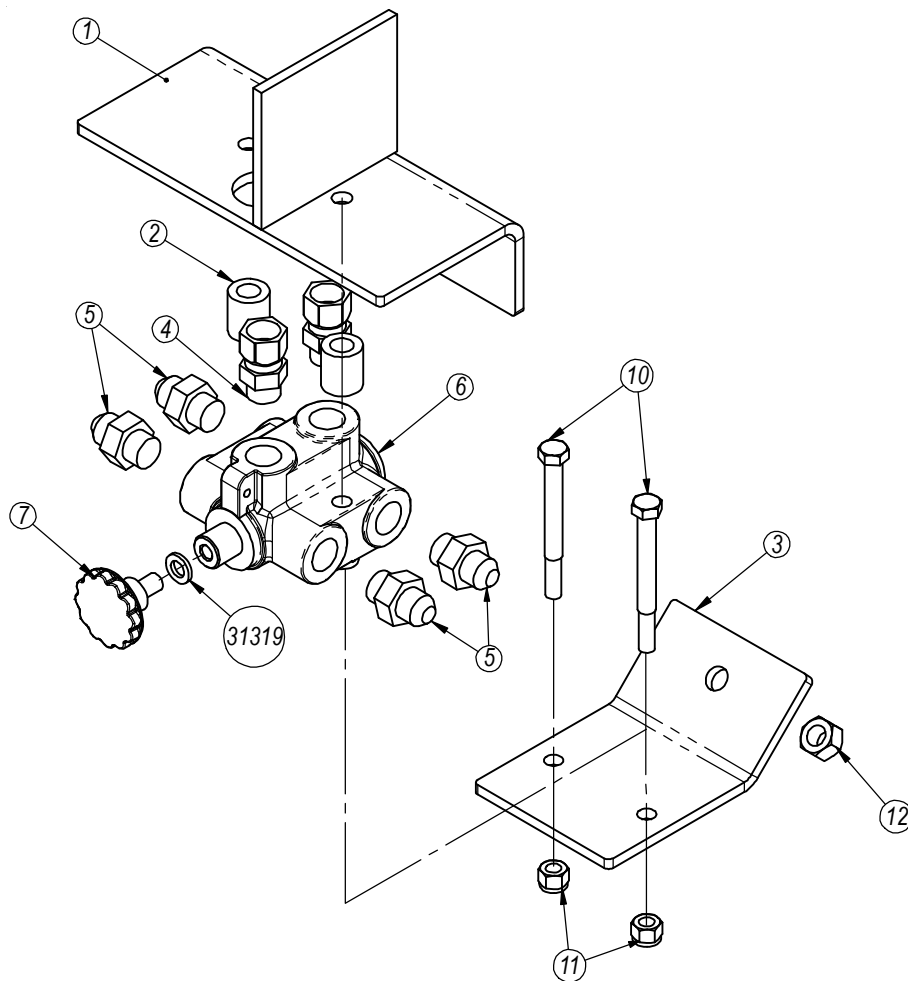

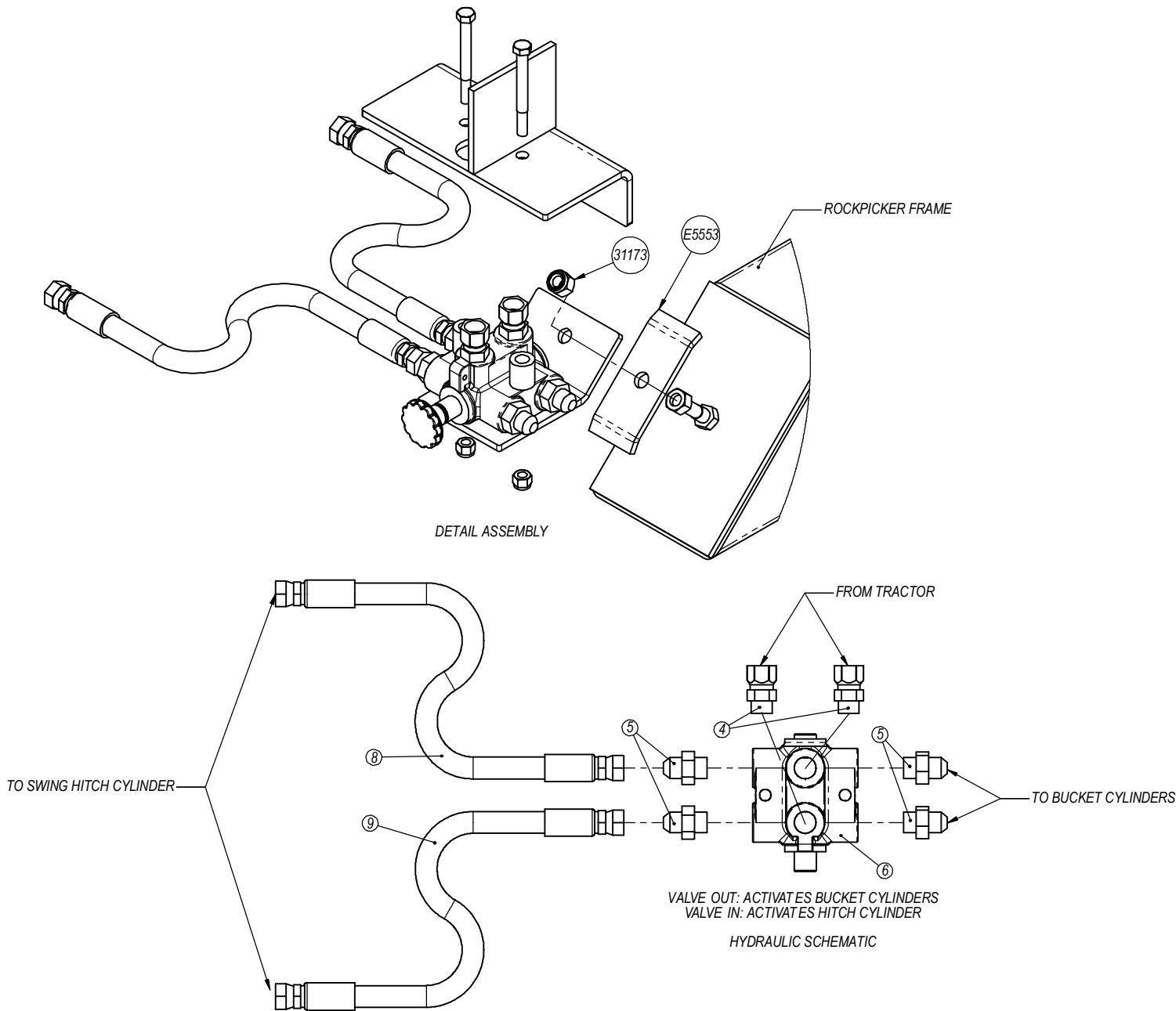

5.2 Clearance Light Option (Part No. RPOCL (89108))

ITEM NO.	PART NO.	DESCRIPTION	QTY.
1	48109	BRACKET,LIGHT,RIGHT,RP	1
2	48110	BRACKET,LIGHT,LEFT,RP	1
3	49889	ASSY,HARNESS,ELEC,FRT,VMR,HL	1
4	70646	ASSY,HARN,LIGHTS,RP,REAR	1
5	E7743	MOUNT,LIGHT,GROMMET,X2	2
6	E7744	MOUNT,LIGHT,GROMMET,X1	2
7	30294	SCREW,TEK,1/4X1	2
8	31649	ELEC,CLAMP,CABLE,1/2	1
9	31650	ELEC,CLAMP,CABLE,3/4	1
10	31951	ELEC_LIGHT,AMBER,4DIA,S/T/T	4
11	31952	ELEC_LIGHT,RED,4DIA,S/T/T	2
12	31953	GROMMET,LIGHT,4X4-1/2	6
13	33928	ELEC,MODULE,AG,VMR SUPP	1
14	31033	BOLT,HEX,1/4X3/4,UNC,GR5,ZP	8
15	31686	BOLT,U,SQ,3/8-16,6x5	4
16	31174	NUT,NYLOCK,1/4,UNC,ZP	8
17	31176	NUT,NYLOCK,3/8,UNC,ZP	8
18	31351	WASHER,FLAT,3/8,ZP	8
19	E3794(0.87	ELEC,LOOM,1/2,SPLIT,CORRUGATED	2
20	31613	TIE,CABLE,NYLON,BLACK,11 1/2"	12

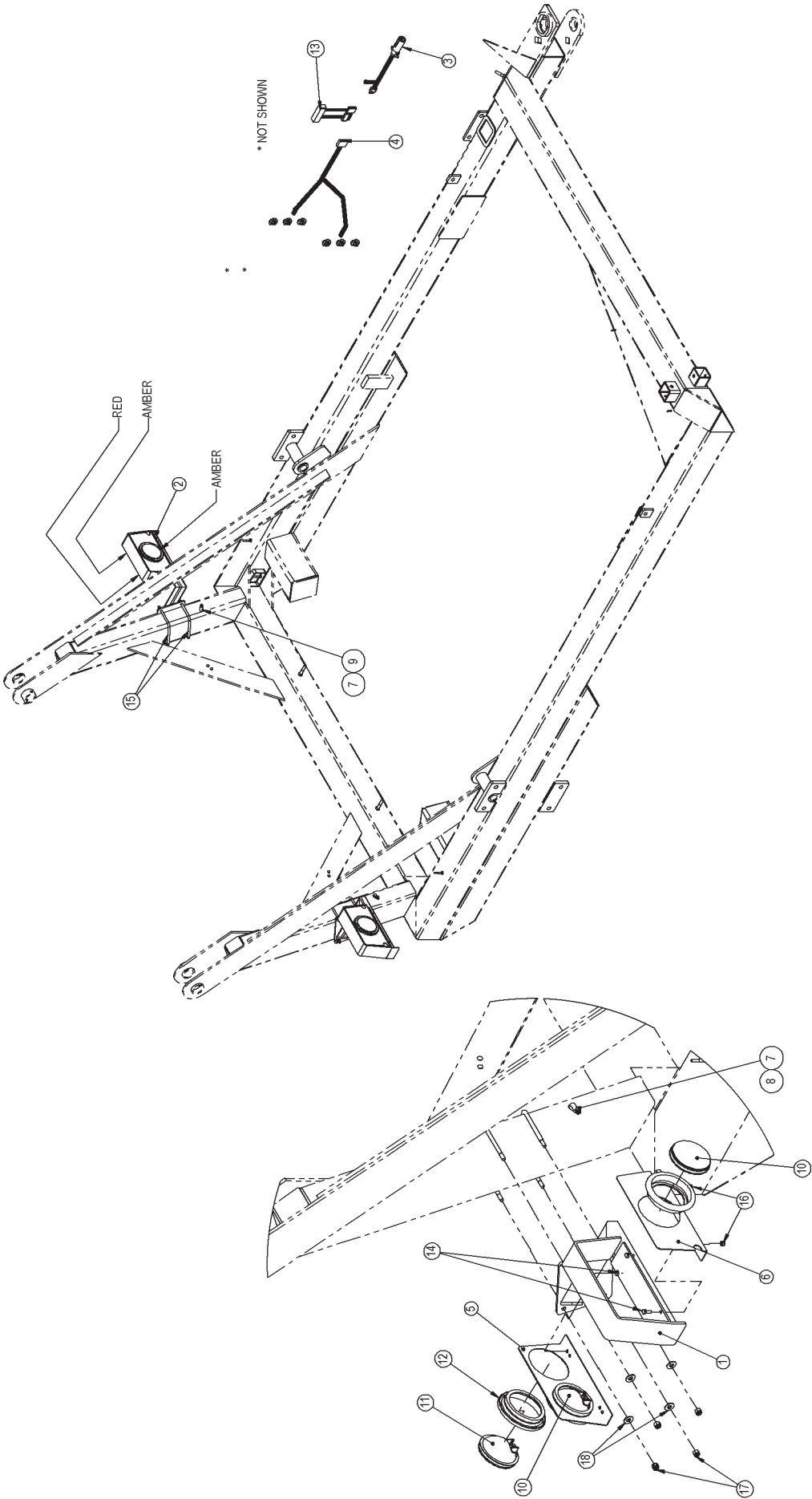

5.2.1 Front Light Harness Assembly (Part No. 49889)

ITEM NO.	PART NO.	DESCRIPTION	QTY.
1	30556	ELEC,CONN,7 WIRE,FEMALE	1
2	31976	ELEC,HEAT_SHRINK,DUAL_WALL,TUBE,1/4X48	2
3	31977	ELEC,CONN,BUTT,16-14GA,NON_INSULATED	2
4	33537	ELEC_SEAL,WP,CABLE	1
5	33540	ELEC_SLEEVE,WP,F,14/16	1
6	33934	ELEC,CONN,4,W/P,TOWER,K01	1
7	37686	ELEC,PLUG,2_POLE,10GA	1
8	37981(17.5	ELEC,WIRE,14GA,STRAND,WHITE	1
9	92149(8.5)	ELEC,WIRE,16GA,STRAND,BLACK	1
10	92153(9)	ELEC,WIRE,16GA,STRAND,GREEN	1
11	92154(9)	ELEC,WIRE,16GA,STRAND,YELLOW	1
12	92155(9)	ELEC,WIRE,16GA,STRAND,BROWN	1
13	92143(9)	ELEC,LOOM,1/2,SPLIT,CORRIGATED	1
14	92170	TIE,CABLE,4",BLACK	4

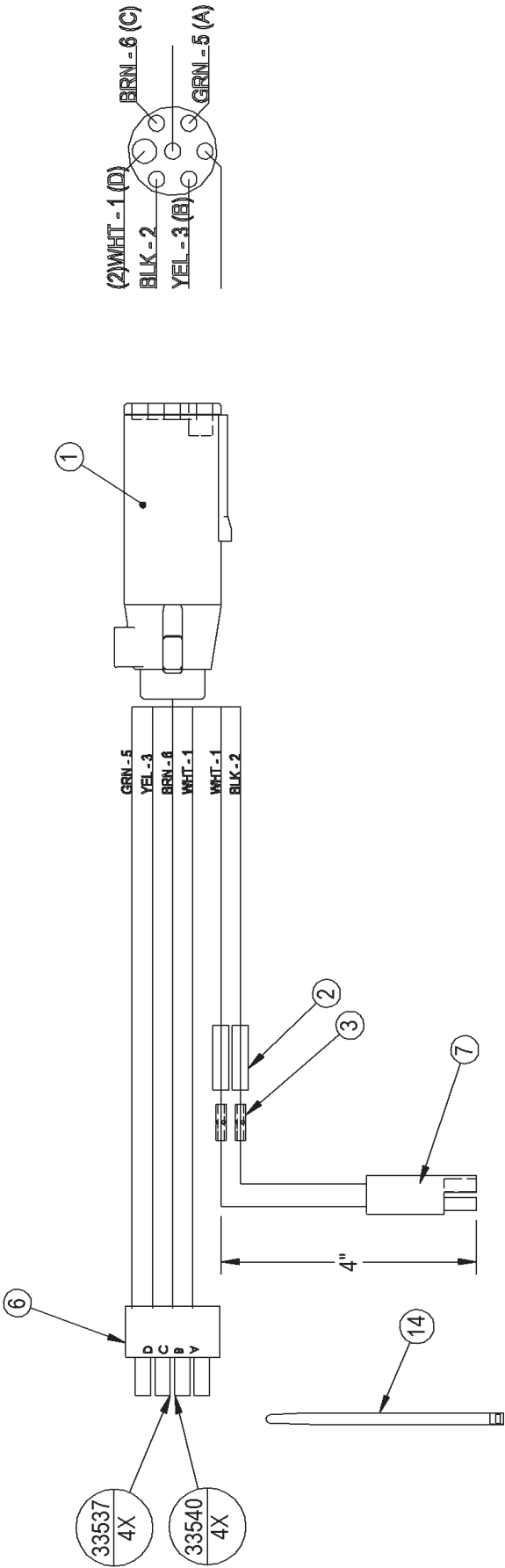

5.2.2 Rear Light Harness Assembly (Part No. 70646)

ITEM NO.	PART NO.	DESCRIPTION	QTY.
1	31853	ELEC,PLUG,STOP/TURN,RIGHT ANGL	6
2	31976	ELEC,HEAT_SHRINK,DUAL_WALL,TUBE,1/4X48	10
3	31977	ELEC,CONN,BUTT,16-14GA,NON_INSULATED	4
4	31978	ELEC,CONN,BUTT,12-10GA,NON_INSULATED	6
5	33537	ELEC_SEAL,WP,CABLE	6
6	33541	ELEC_PIN,WP,M,14/16	6
7	33933	ELEC,CONN,6,W/P,SHROUD,K01	1
8	92170	TIE,CABLE,4",BLACK	8
9	92150(28.5	ELEC,WIRE,16GA,STRAND,WHITE	1
10	92149(19.5	ELEC,WIRE,16GA,STRAND,BLACK	1
11	92151(25)	ELEC,WIRE,16GA,STRAND,RED	1
12	92153(25)	ELEC,WIRE,16GA,STRAND,GREEN	1
13	92154(19.5	ELEC,WIRE,16GA,STRAND,YELLOW	1
14	92155(28.5	ELEC,WIRE,16GA,STRAND,BROWN	1
15	92143(31)	ELEC,LOOM,1/2,SPLIT,CORRUGATED	1

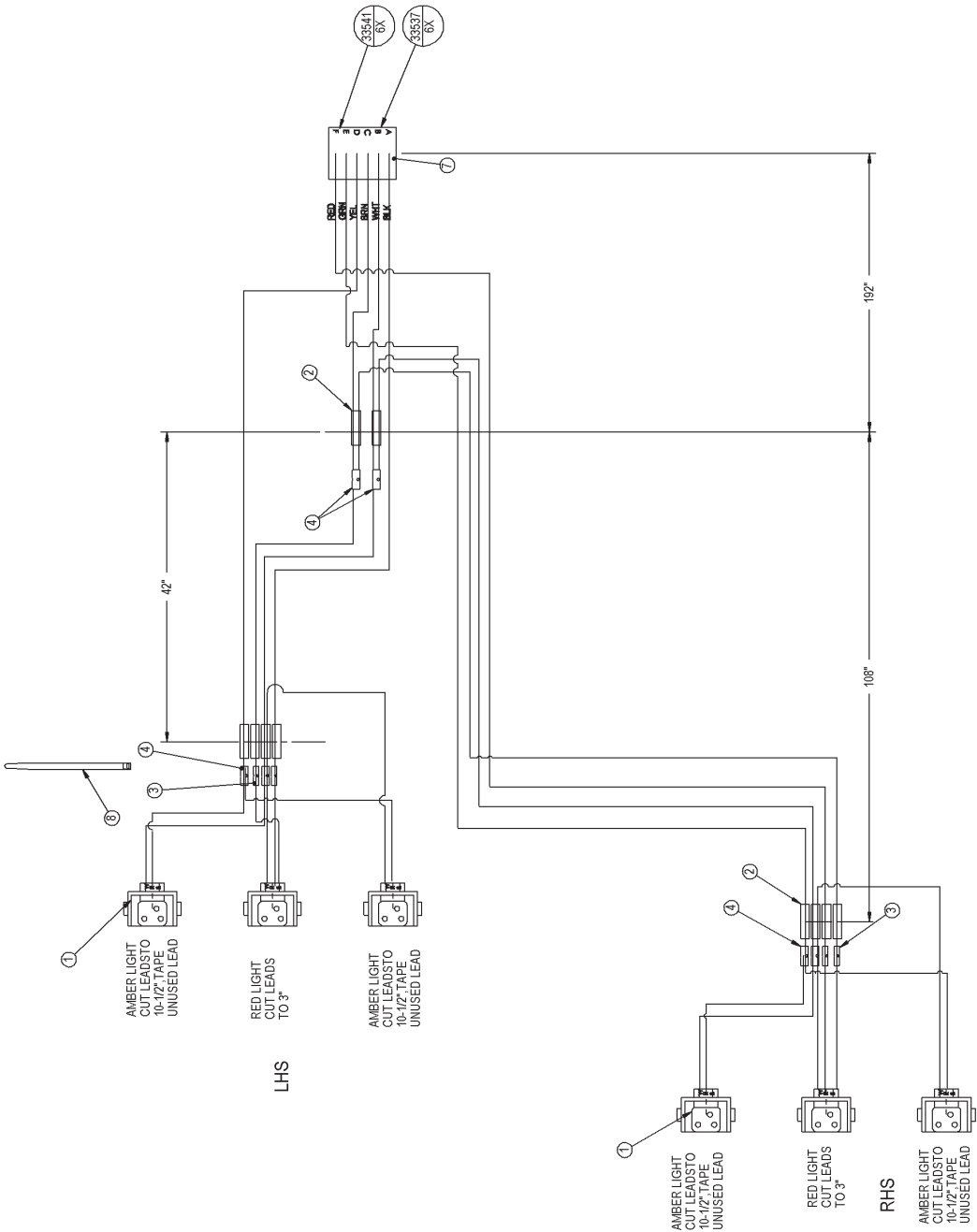

6.0 Specifications

Weight:	Approximately 7250 lbs (3290 kg)
Total Length:	17'3"
Total Width:	12'6"
Total Height:	5'8"
Picking Width:	84"
Dumping Height:	Approximately 90"
Ground Clearance:	11"
Maximum Capacity:	3.3 cubic yards (2.52 cubic meters)
Tires:	21.5L x 16.1 Softrac Tires
Tire Pressure:	27 psi
Horsepower Required:	90-150 Horsepower 18 gpm flow required
Hydraulic Outlets:	2
Hydraulic Pressure:	2500 psi (20,680 kPa)

Dealer Information

Dealer: _____

Address: _____

City: _____

Province / State: _____

Postal Code / Zip Code: _____

Phone: _____



Identification Numbers

Model Number: _____

Serial Number: _____

This page intentionally left blank

Dealer Checklist

Rock Picker Dealer Checklist

Checked	Check List Item
	Run the reel and raise and lower the bucket to ensure that all components run freely without binding and are free of excessive impact. Check all hydraulic components for leaks and test hydraulic line lock.
	If required - Tail/warning lights installed with machine.
	SMV sign installed.
	Tongue pivot lock pin with tether installed.
	Apron transport lock bars installed.
	Ensure hitch arm moves freely from working position to transport position and that the hitch wedge can be installed in both positions.
	Ensure all grease points are lubricated.
	Check tire pressure and adjust as required.(as specified on tire).
	Cycle all cylinders a minimum of three times, check for leaks and clearance problems.
	Hydraulic motors to be operated and checked for leaks and free movement.
	Check tire hubs for proper bearing adjustments.
	Owners manual shipped with machine.