

Re-locate Scale Head to Left or Right Hand Platform on Towed TMR Mixers



WARNING

Shut down the tractor and remove the key before repairing, servicing, lubricating or cleaning the machine.

Relieve all hydraulic pressure in the hoses. Disconnect the hydraulic hoses from the tractor before going near the machine.

Securely block the machine to avoid any movement while doing the work.



WARNING

DO NOT enter the tub while the mixers are turning.

Entering the tub when the mixers are turning will result in death or serious injury.

DO NOT contact the rotating screws.

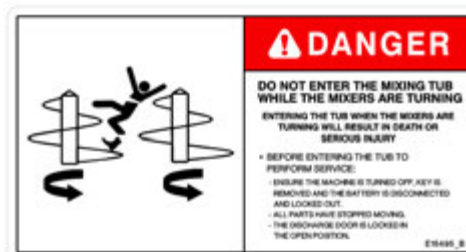

This instruction details the re-location of the scale head to the either the left hand (LH) or right hand (RH) platform side rail on units built prior to 2025.

Remove

1. Disconnect the scale head. Cut cable ties as required to move and disconnect the cables.

Refer to [Figure 1](#) for steps [2](#) - [4](#).

2. Remove the cotter pin and washer (1) from the bottom of the scale head mount arm (2).
 - a. Set aside for reuse.
3. Loosen the hex bolt and nut (3) from the swivel base (4).
4. Carefully remove the scale head and mount arm (2) and washer from the swivel base (4).
 - a. Set aside for reuse.

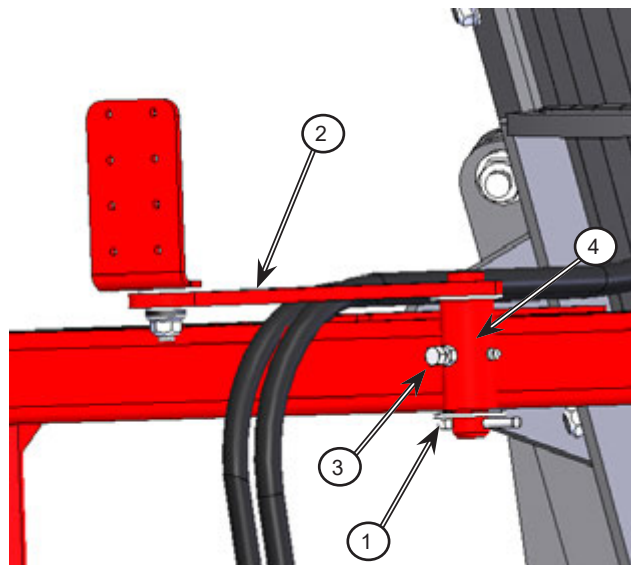

Figure 1: Remove the scale head mount arm
(Scale head not shown for clarity)

Note: The scale head mount arm and display holder on your unit may look different than what is shown in [Figure 1](#). The steps in this section are still applicable unless otherwise stated.

Re-locate Scale Head to Left or Right Hand Platform on Towed TMR Mixers

5. If desired, remove the scale head and display holder from the mount arm.

Note: Only remove the scale head and display holder if the extended display holder will be used. This extended display holder allows for the scale head to be adjusted based on your needs.

- a. For units built prior to 2024, the extended display holder is not compatible with the scale head support arm and therefore cannot be used.
- b. For units built in 2024:
 - i. Remove the scale head from the mounting bracket and remove the mounting bracket from the display holder.
 - ii. Remove the hex bolt (1) and flange lock nut (6) securing the display holder (9); see **Figure 2**.
 - iii. Remove the display holder (9) and washers; see **Figure 2**.
 - iv. Set all hardware aside for reuse.

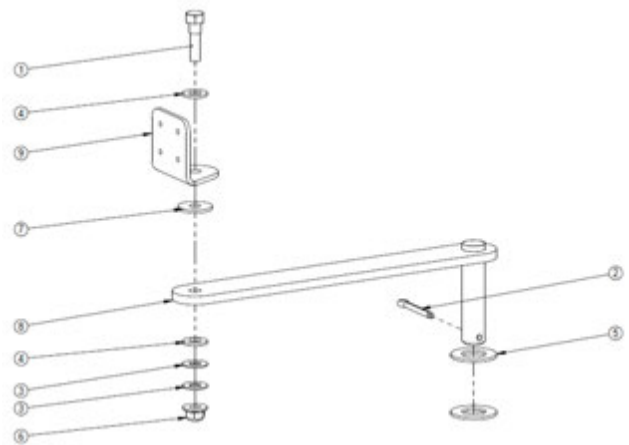

Figure 2: Remove the display holder

Install

1. If the scale head and display holder were removed:
 - a. Fasten the new extended display holder (9) onto the scale head mount arm (8), using the previously removed hardware; see **Figure 3**.
 - i. Install the spring washers (3) with the concave side facing inwards.
 - ii. Tighten the nut (6) as required to achieve the desired friction. Over tightening will prevent rotation of the scale head.
 - b. Fasten the mounting bracket onto the new extended display holder, using the previously removed hardware.
 - c. Fasten the scale head onto the mounting bracket, using the previously removed hardware.

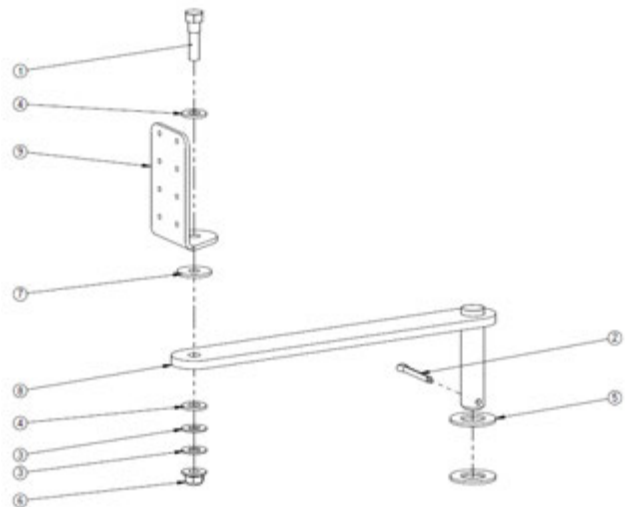

Figure 3: Install the display holder

Re-locate Scale Head to Left or Right Hand Platform on Towed TMR Mixers

2. Install the scale head mount bracket onto the LH or RH platform side rail; see *Figure 4*.
 - a. Place 2 U-bolts (1) around the platform side tube and fasten the scale head mount bracket (2) in place using $\frac{1}{2}$ " flange lock nuts.

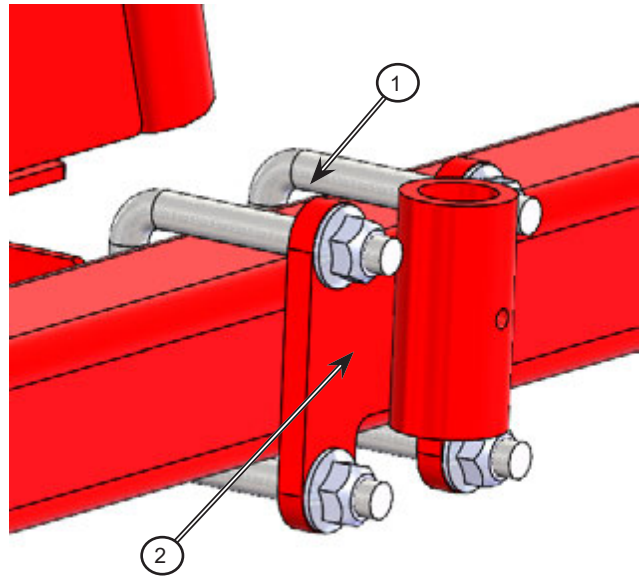

Figure 4: Install the scale head mount bracket

3. Install the previously removed scale head mount arm (1) and washer into the new swivel base (2); see *Figure 5*.

Note: The scale head mount arm and display holder on the unit may look different than what is shown in *Figure 5*. The below steps are still applicable.

- a. Replace the previously removed bottom washer and cotter pin.
- b. Install the grease zerk (3) onto the swivel base (2).
- c. Tighten the scale head mount arm in place using a $\frac{5}{16}$ " x $\frac{3}{4}$ " hex bolt and $\frac{5}{16}$ " hex nut (4).

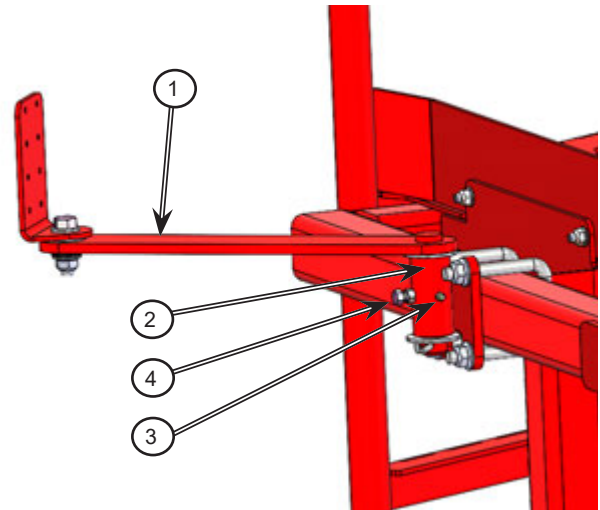

Figure 5: Install the scale head mount arm
(Scale head not shown for clarity)

4. Reconnect the cables to the scale head.
 - a. If the power cable is too short, use the provided extension cable shown in *Figure 6*.



Figure 6: Extension cable

5. Use cable ties to secure the cables to the platform tubing, ensuring to keep them away from moving parts.