

Installation of the Left Hand Hydraulic Folding Conveyor on Towed TMR Mixers



Shut down the tractor and remove the key before repairing, servicing, lubricating or cleaning the machine.

Relieve all hydraulic pressure in the hoses. Disconnect the hydraulic hoses from the tractor before going near the machine.

Securely block the machine to avoid any movement while doing the work.



Do not enter the tub while the mixers are turning.

Entering the tub when the mixers are turning will result in death or serious injury.

Do not contact the rotating screws.

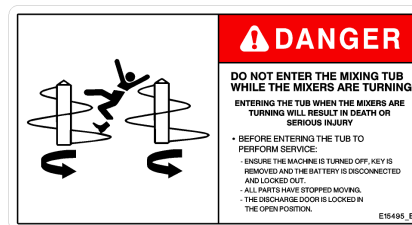
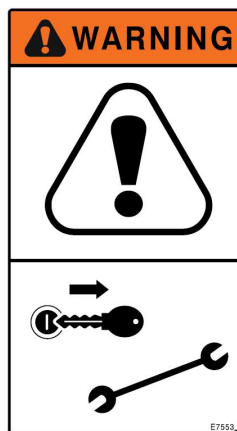

1. If there is a conveyor installed on the machine, remove the conveyor.

- a. Remove the load cell junction box and bracket from the conveyor. This will be re-installed onto the new conveyor.

2. Remove the front conveyor support bracket (34), hydraulic hose clamps (19,20) and the rear conveyor support bracket (35) from the new hydraulic folding conveyor assembly, see **Figure 1**.

- a. Save all of the hardware for re-use.

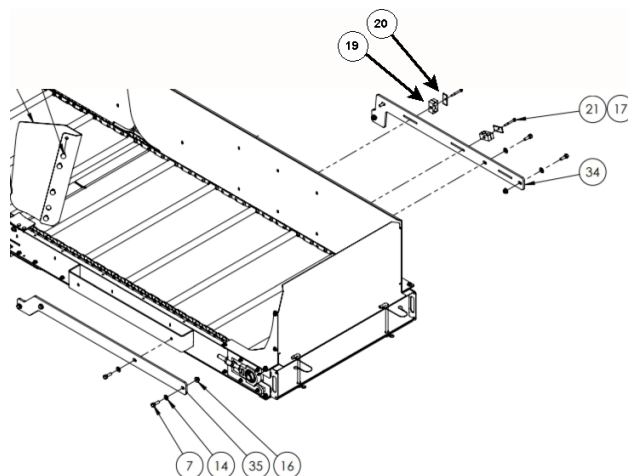

Figure 1: Remove the support brackets

48650_A1C

3. Install the rear conveyor support bracket (1) onto the platform uprights and below the tub door, as per **Figure 2**.

- a. Fasten the bracket with 2 of ½" x 1-½" hex bolts, flat washers and ½" flange lock nuts (2).

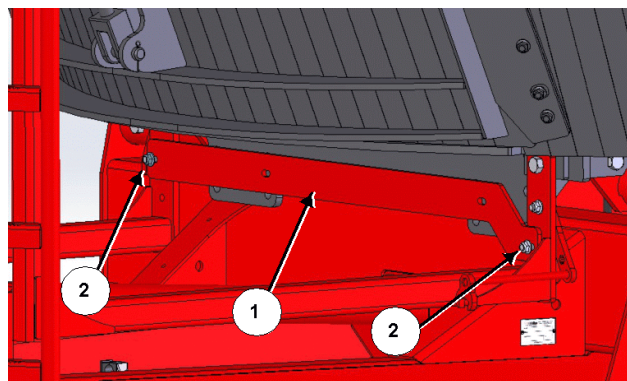

Figure 2: Install the rear conveyor support bracket

225016C

Installation of the Left Hand Hydraulic Folding Conveyor on Towed TMR Mixers

4. Install the front conveyor support bracket (1) onto the platform uprights, as per *Figure 3*.
 - a. Fasten the bracket with 2 of ½" x 1-½" hex bolts, flat washers and flange lock nuts (2).

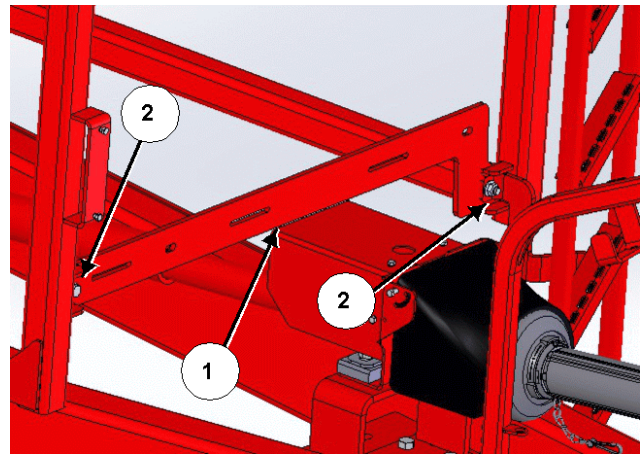

Figure 3: Install the front conveyor support bracket

225017C

5. The components of the left hand hydraulic folding conveyor assembly are assembled according to *Figure 4* and *Table 1*.
 - a. The following parts will need to be removed from the conveyor assembly and installed again later once the conveyor has been mounted onto the unit:
 - i. Front shield (24) and the rubber spill guard (20);
 - ii. Side shield (25);
 - iii. Cleanout door (8);
 - iv. Retainer pins (21);
 - v. End shield (26).

ITEM	DESCRIPTION
1	BOLT,HEX,5/16X1,UNC,GR5,ZP
2	WASHER,FLAT,5/16,ZP
3	BOLT,HEX,5/16X1-1/4,UNC,GR5,ZP
4	PIN,COTTER,1/8X1
5	BOLT,HEX,5/16X3/4,UNC,GR5,ZP
6	WASHER,FLAT,SAE,1/2,ZP
7	NUT,FLG,LOCK,5/16,UNC,GR5,ZP
8	WLDT,CLEANOUT DOOR,CONVEYOR
9	WLDT,FILLER PLATE
10	ASSY,CONVEYOR HYD DRIVE
11	PIN, HAIR, 1/8x2-9/16
12	ROPE,WIRE,1/16,COATED,14"
13	PC,DEFLECTOR
14	PC,SUPPORT
15	PC,SPACER
16	PC,BOTTOM PANEL
17	PC,BOTTOM PANEL
18	PIN,HINGE,DRILLED
19	BELTING,DROP CHUTE
20	BELTING, CONVEYOR DISCHARGE
21	PIN,SHIELD RETAINER,PLTD
22	PC,SHIELD
23	PC,SHIELD
24	PC,SHIELD
25	PC,SHIELD
26	PC,SHIELD

Table 1: Parts list for the conveyor assembly

Installation of the Left Hand Hydraulic Folding Conveyor on Towed TMR Mixers

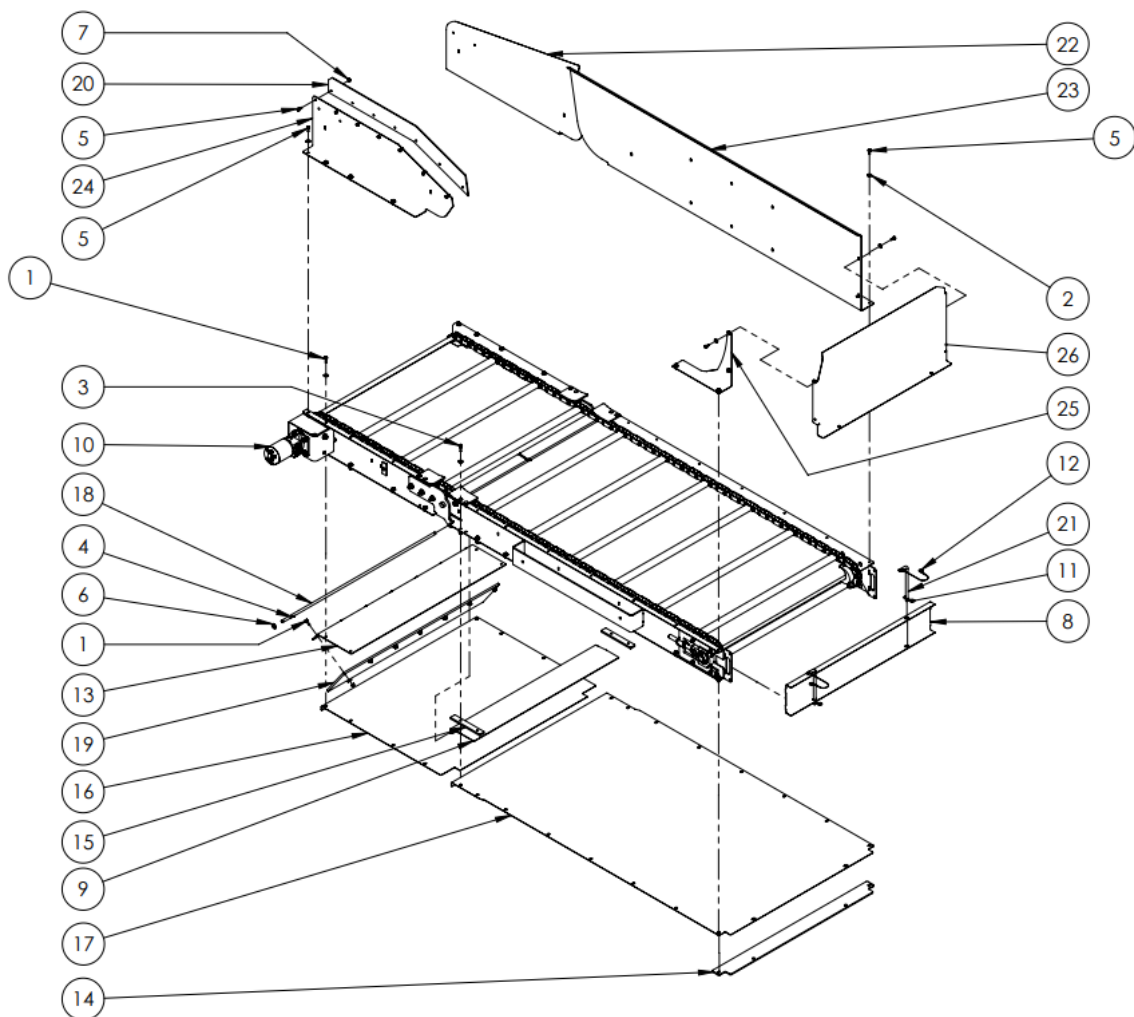

Figure 4: Left Hand Hydraulic folding Conveyor Assembly

48649_A1

6. To aid in the installation of the conveyor, place skids (1) between the lower support frame of the platform, as shown in *Figure 5*. Use either:
 - a. 3/4" x 36" wide x 72" long piece of plywood.
 - b. 2 of 1" x 4" x 72" long lumber, shown in *Figure 5*.

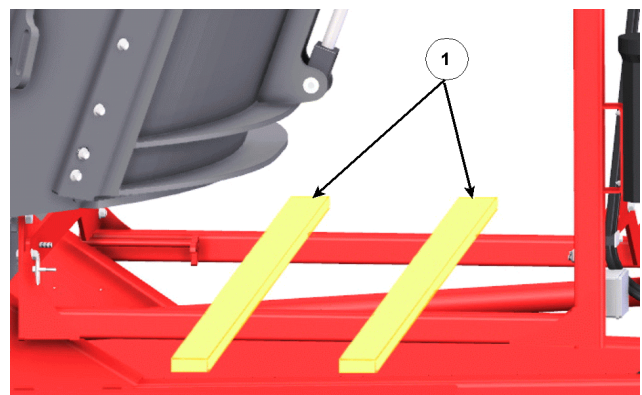

Figure 5: Skids to help with installation of Conveyor

223165C

Installation of the Left Hand Hydraulic Folding Conveyor on Towed TMR Mixers



There is a pinching/clamping hazard while handling the conveyor. The bed of the conveyor can fold. Avoid placing hands in a pinching/clamping area.



7. Place the assembled conveyor between the platform uprights and under the tub floor, see *Figure 6*.
 - a. Note: The conveyor is heavy. Use appropriate lifting devices.
 - b. Install from the left side of the machine otherwise the conveyor motor will not clear the tub.

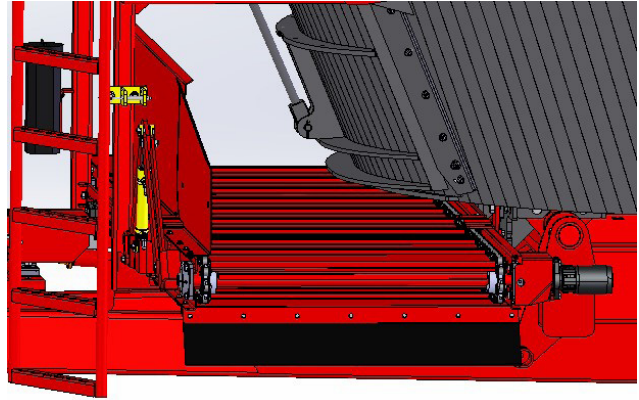
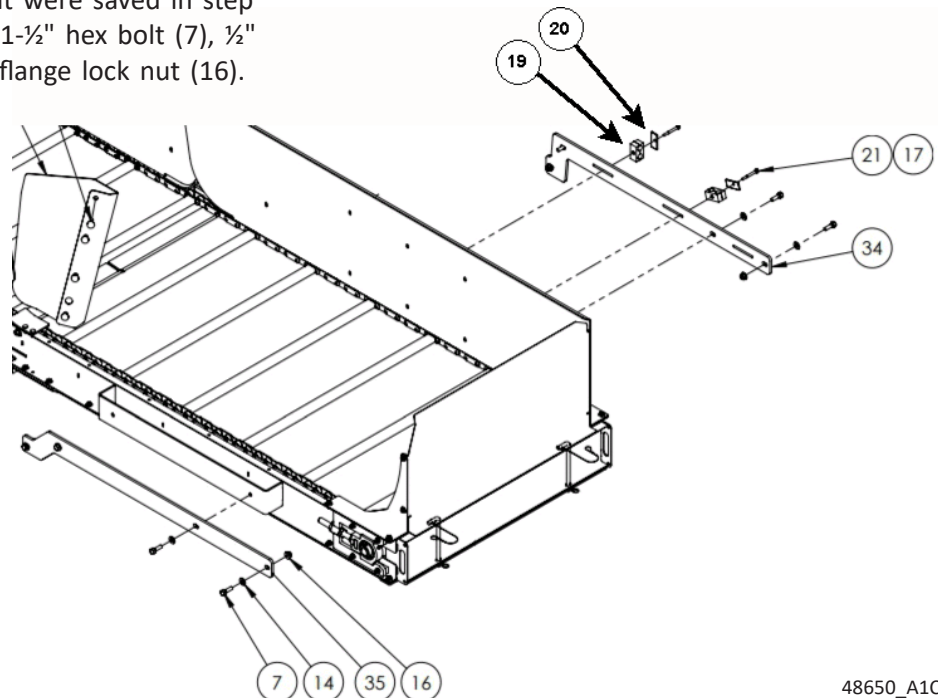

Figure 6: Put the hydraulic folding conveyor in place

225018

8. Fasten the rear support bracket (35) with $\frac{1}{2}$ " x $1\frac{1}{2}$ " hex bolts (7), $\frac{1}{2}$ " flat washers (14) and flange lock nuts (16), as per *Figure 7*.
9. Fasten the front support bracket (34), along with the hydraulic hose clamps (19, 20) that were removed in step 2, see *Figure 7*.
 - a. Use the fasteners that were saved in step 2, along with $1\frac{1}{2}$ " x $1\frac{1}{2}$ " hex bolt (7), $\frac{1}{2}$ " flat washer (14) and flange lock nut (16).
 - b. Remove the skids.



48650_A1C

Figure 7: Fasten the hydraulic folding conveyor to the support brackets

Installation of the Left Hand Hydraulic Folding Conveyor on Towed TMR Mixers

10. Re-install the load cell junction box bracket onto the front conveyor support bracket, as per *Figure 8*.
 - a. Line up the holes on the load cell junction box bracket (2) with those on the front conveyor support bracket (1), and fasten using existing hardware.
 - i. Hardware not shown in the diagram.

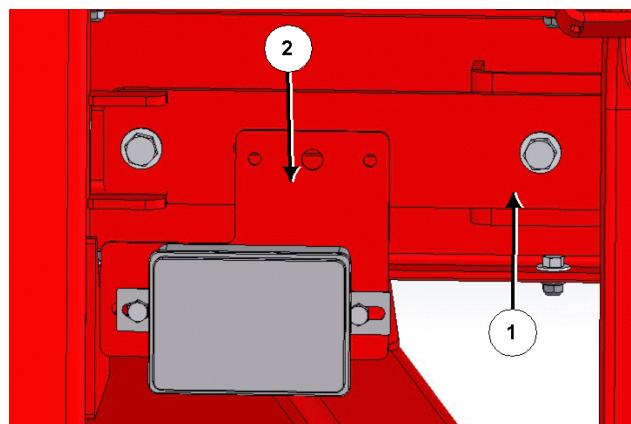

Figure 8: Install load cell junction box

225037C

11. Attach the left bent shield (1) to the tub, as per *Figure 9*.
 - a. Remove the bottom 4 lock nuts (2) on the left tub door slide cap.
 - i. Note: Do not remove the lock nut that is 2nd from the bottom.
 - ii. Keep the lock nuts for re-use.
 - b. Place the bent shield (1) over the 4 carriage bolts.
 - c. Fasten with the 4 lock nuts (2) removed earlier.

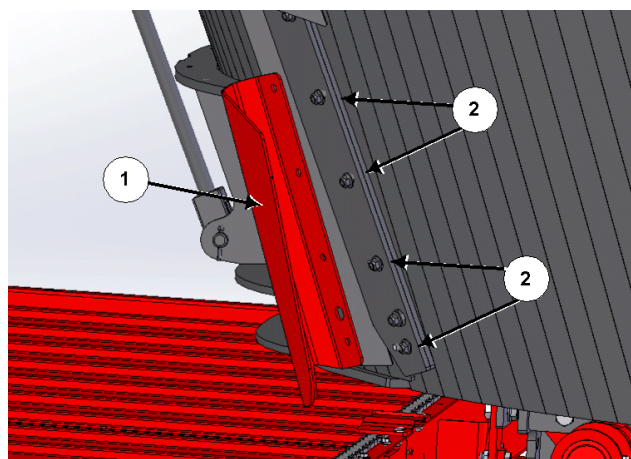

Figure 9: Attach the bent shield to the tub

225019C

12. Attach the front shield (1) and rubber spill guard (2) to the conveyor, as per *Figure 10*.
 - a. Fasten the front shield (1) to the conveyor with 4 of $\frac{5}{16}$ " x $\frac{3}{4}$ " hex bolts, flat washers and flange lock nuts (3).
 - b. Attach the rubber spill guard (2) to the shield with 7 of $\frac{5}{16}$ " x $\frac{3}{4}$ " hex bolts and flange lock nuts (4).
 - i. Place the flange lock nuts against the rubber.

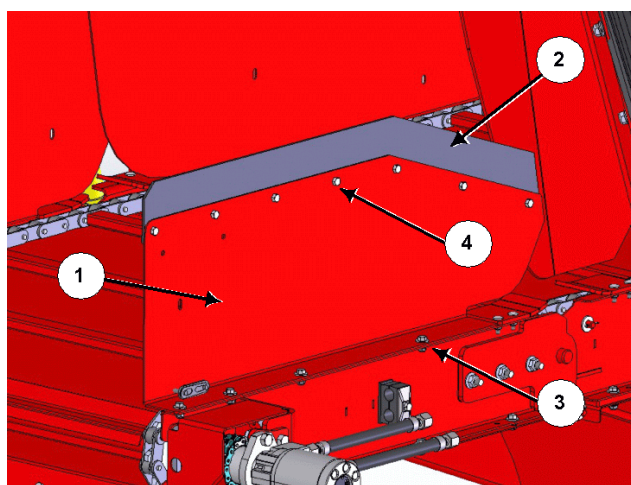
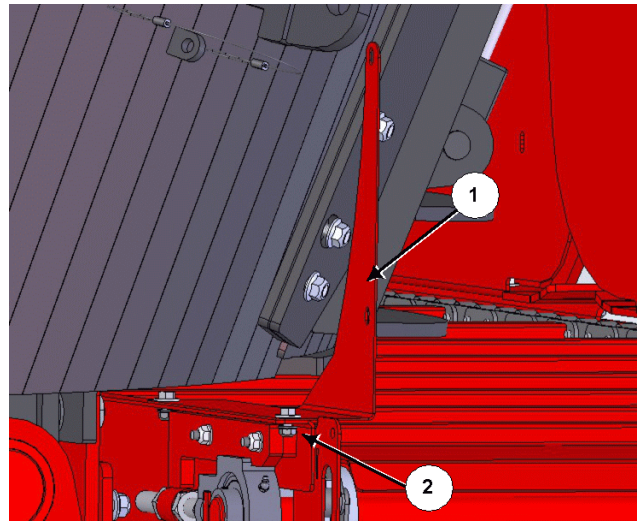

Figure 10: Attach the front shield and spill guard

225020C

Installation of the Left Hand Hydraulic Folding Conveyor on Towed TMR Mixers

13. Attach the right rear conveyor side shield (1) to the conveyor, as per *Figure 11*.
 - a. Fasten the shield (1) with $\frac{5}{16}$ " x $\frac{3}{4}$ " hex bolts, flat washers and flange lock nuts (2).



225021C

Figure 11: Attach the side shield

14. Attach the conveyor end shield (1) to the right front and rear side shields, as per *Figure 12*.
 - a. Fasten the shield with $\frac{5}{16}$ " x $\frac{3}{4}$ " hex bolts (2), flat washers and flange lock nuts.

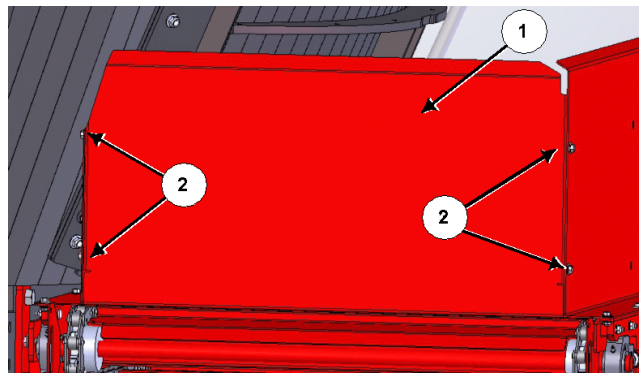

225022C

Figure 12: Attach the end shield

15. Install the conveyor clean out door (1), as per *Figure 13*.
 - a. Fasten in place with the shield retainer pins (2).

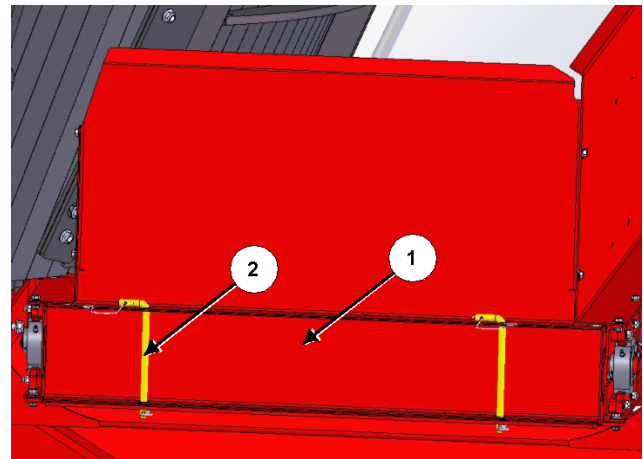

225023C

Figure 13: Attach the conveyor clean out door

Installation of the Left Hand Hydraulic Folding Conveyor on Towed TMR Mixers

16. Connect the hydraulic hoses and fittings to the conveyor motor according to *Figures 14* and *15*, and *Table 2*.

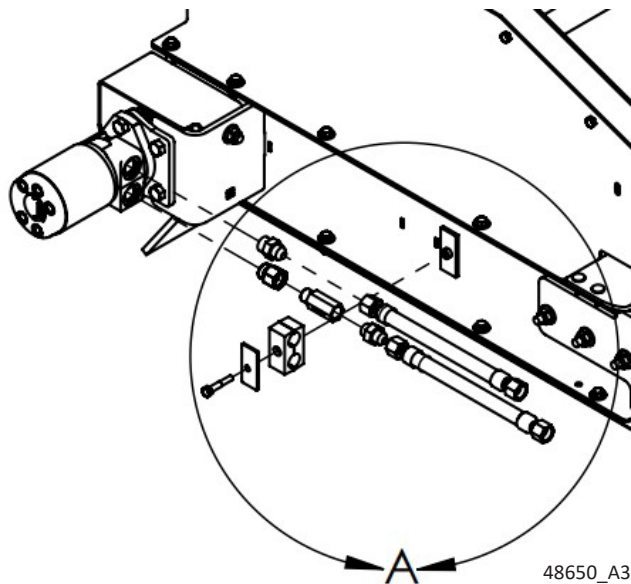

Figure 14: Attach hydraulic hoses and fittings to the motor

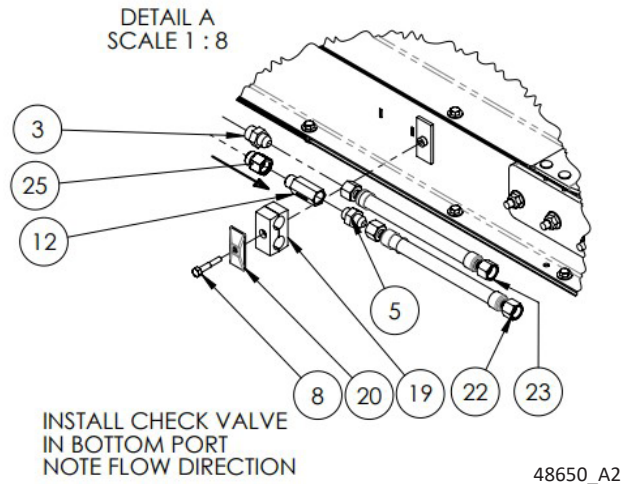

Figure 15: Hydraulic fittings

ITEM	DESCRIPTION
3	HYD,FIT,ADAPTER,10MB-8MJ
5	HYD,FIT,ADAPTER,8MB-8MJ
8	BOLT,HEX,5/16X1-3/4,UNC,GR5,ZP
12	HYD,VALVE,CHECK,08MB-08FB
19	HYD,CLP,22.0/22.0,3015-3,3,PA
20	HYD,CLAMP,CAP,DIN,3015-3,3
22	HYD,HOSE,1/2x57,8FJX-8FJX,2W
23	HYD,HOSE,1/2x60,8FJX-8FJX,2W
25	HYD,FIT,BUSHING,10MB-08FB

Table 2: Parts list for hydraulic hoses and fittings

17. Relocate the bulkhead fittings that are on the right-hand side (1) of the mixer frame to the left-hand side (2) of the mixer frame, as per *Figure 16*.

- a. Note: The conveyor is not shown in *Figure 16* for clarity.

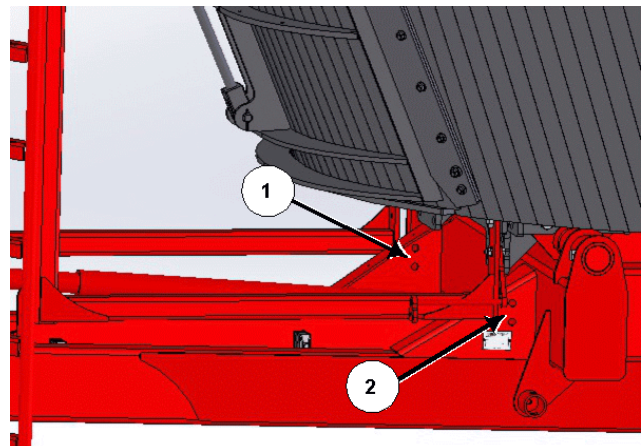

Figure 16: Relocate bulkhead fittings

Installation of the Left Hand Hydraulic Folding Conveyor on Towed TMR Mixers

18. Connect the hydraulic hoses that are connected to the conveyor motor to the bulkhead fittings on the left-hand side of the mixer frame.
 - a. The bulkhead fittings connect to hoses that go to the tractor.
 - b. Fasten the hoses to the side of the conveyor with the hose clamp.
19. Attach the $\frac{3}{8}$ " x 172" hydraulic hoses (1) to the restrictor fittings at the lower end (base) of the hydraulic cylinder (2), as per *Figure 17*.
20. Attach the hose couplings (3) onto the end of the hoses (1), as per *Figure 17*.

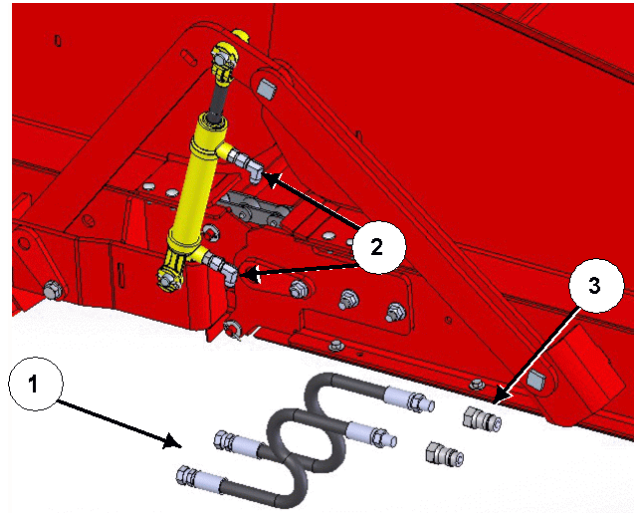

Figure 17: Attach the hydraulic hoses

225025C

21. Route the hoses towards the front of the unit, ensuring they do not come into contact with any moving parts.
 - a. Secure with zip ties as necessary.
22. Route the hoses through the abrasion sleeve, see *Figure 18*.
23. Route the hoses into the hose holder, see *Figure 18*.



222310

Figure 18: Route the hoses through the abrasion sleeve and into the hose holder

Installation of the Left Hand Hydraulic Folding Conveyor on Towed TMR Mixers

24. Install the transport lock on the left platform upright, see *Figure 19*. (Note: The right hand hydraulic folding conveyor is shown in the figure.)
- To position the transport lock, raise the conveyor.
 - Loosely attach the U-bolt (1) and lock bracket (2) to the platform upright.
 - Insert the lock pin (3) through the lock bracket and into the hydraulic fold arm (4).
 - Secure the U-bolt (1) and lock bracket (2) in place using flange lock nuts.

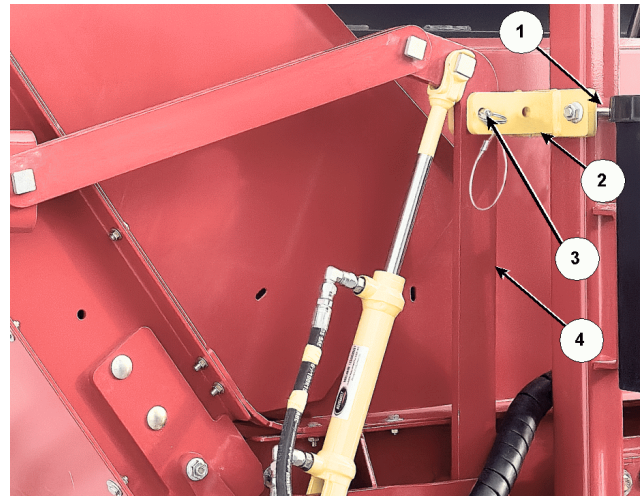

Figure 19: Install the transport lock

224087C2