

## Installation of the Front Table Full Indicator



Shut down the tractor and remove the key before repairing, servicing, lubricating or cleaning the machine.

Relieve all hydraulic pressure in the hoses. Disconnect the hydraulic hoses from the tractor before going near the machine.

Securely block the machine to avoid any movement while doing the work.



### Installation on FaStack 1200 Models

Note: For the Full Table Indicator to work on the FaStack 1200, the machine requires FaStack Controller software version \_29 or higher and FaStack Display software version 11 or higher.

1. Take note of the position of the front bale stop (1) on the front table.
  - Note which hole the bale stop has the fasteners into the tube under the table so the new indicator can be positioned in the same location.
2. Remove the front bale stop (1) from the front table.
  - Discard the stop.
  - Keep the fasteners for re-use.
3. Insert the full load indicator (2) into the holding tube under the table.
4. Position the new load indicator so it can be fastened in the same hole as noted in Step 1.
5. Tighten in place with the fasteners removed earlier.

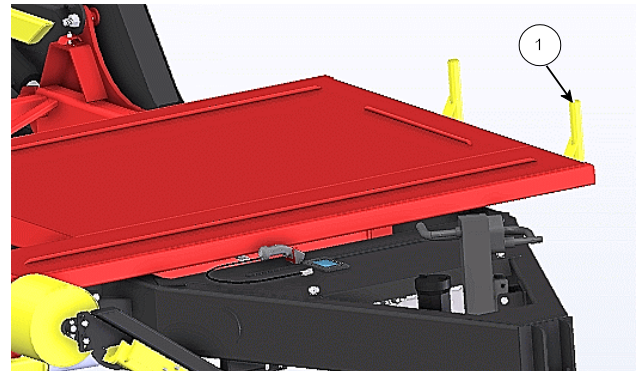

Note the Position of the Existing Bale Stop  
Remove the Bale Stop

224232C

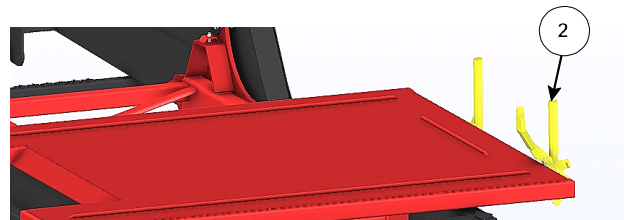

Install the New Full Table Indicator  
Place in the Same Position as Stop Removed

224233C

## Installation of the Front Table Full Indicator

6. Extend the wiring connector 5" past the end of the table to allow for adjustability of the indicator position.
  - Loop excess wire and zip tie at a hold down.
7. Route the wiring harness so that it follows the existing line to the back of the table.
8. Extend the harness to the valve block.
9. Tie down the cable with zip ties.
  - Add hold downs (3) if they are not available.

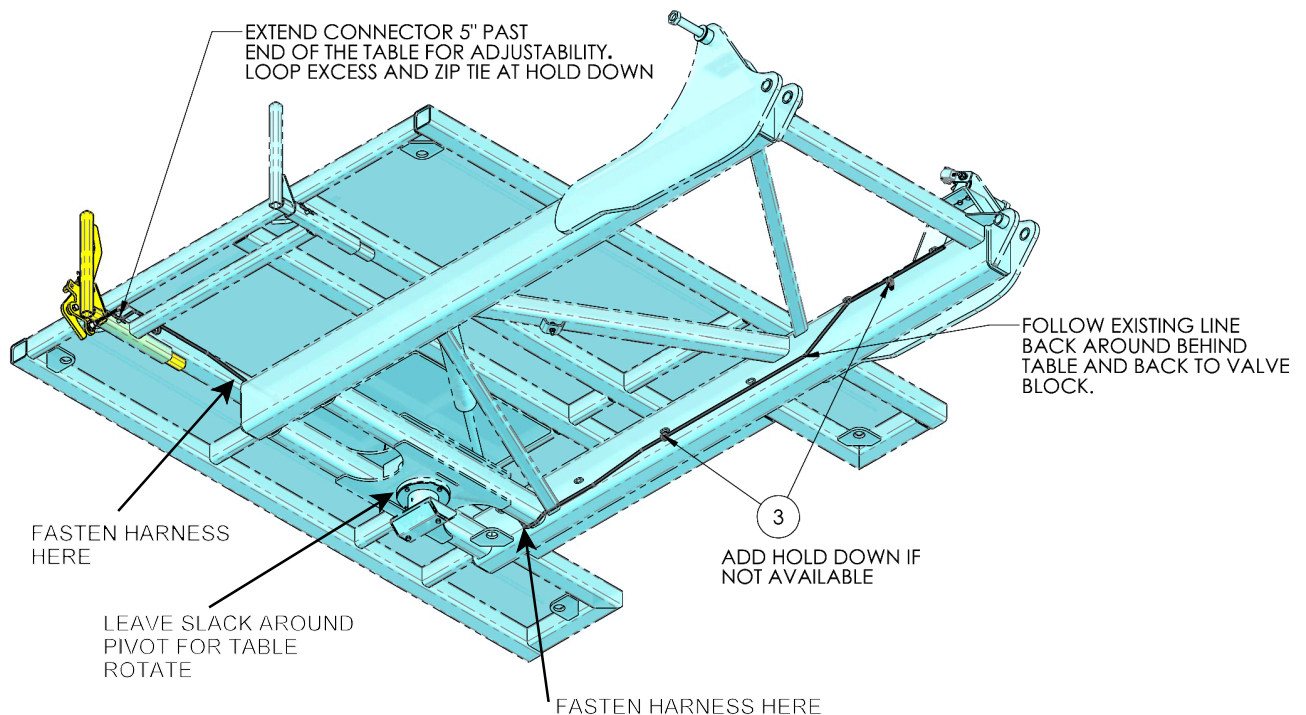

Wiring for the Full Table Indicator on a FaStack 1200 (Viewed from under the table.)

48338\_AC