



Shut down the tractor and remove the key before repairing, servicing, lubricating or cleaning the machine.

Relieve all hydraulic pressure in the hoses. Disconnect the hydraulic hoses from the tractor before going near the machine.

Securely block the machine to avoid any movement while doing the work.



Do Not Enter Tub While Parts Are Rotating

Before entering the tub:

- Turn off the tractor and remove the key.
- Wait for rotating parts to stop

Contact with the rotating flail drum will cause serious injury or death.



Note: The parts to be removed and installed are heavy. Use lifting straps and equipment rated to lift the parts.

1. If the long nozzle (1) is on the machine, remove it.
 - Place a lifting strap through the lifting hook (2) located on the top of the nozzle.
 - The nozzle weighs about 130 lbs. (59 kg). Use appropriate lifting straps.
 - Lift with the straps enough to take the weight of the nozzle to allow the fasteners to be removed.

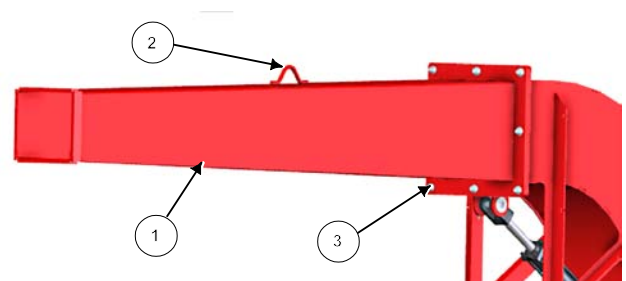

Lift Strap on Nozzle, Remove Fasteners

219193C

2. Remove the fasteners (3) holding the nozzle.
 - Keep the fasteners for re-use.
3. Remove the nozzle.

Installation of the BP 663 End Deflector for Curved Chute

4. Attach the chute bottom panels (1) one at a time starting from the nozzle flange.
 - Fasten the panels with 1/4" x 3/4" carriage bolts and flange locknuts (2).
 - Place the heads of the carriage bolts on the inside of the chute.
5. Turn the curved chute to have the lifting hook upwards.
6. Place the end deflector(10) between the sides of the chute.
 - Place the pin (14) through the side plate bushings and the pipe of the end deflector (10).
 - Place a flatwasher (2) on each end of the pin.
 - Place two of 3/16" x 2" (1) cotter pins into the long pin (14).
7. Connect the linkage and hydraulic cylinder according to the diagram and chart below.

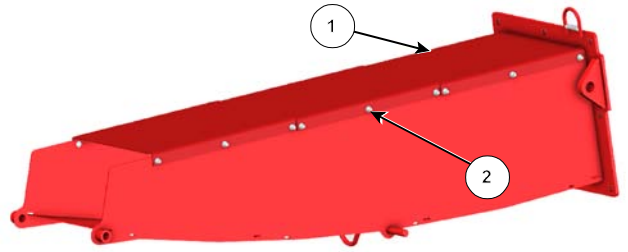

Attach the Bottom Panels to the Chute

223177C

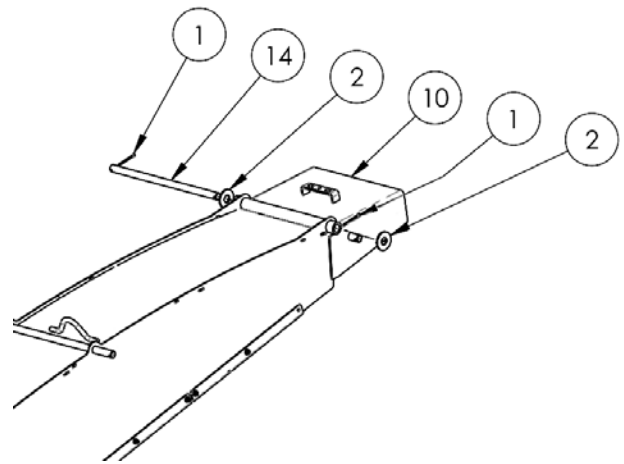

Attach End Deflector to Curved Chute

46599_A1

1	PIN,COTTER,3/16X2
2	WASHER,FLAT,3/4,ZP
5	HYD,CYL,2X8,1.125,8FB,90D
10	DEFLECTOR, TOP GUN
11	ARM,DISCHARGE CHUTE
12	DISCHARGE CHUTE,BTM BOLT
15	LINK,DEFLECTOR

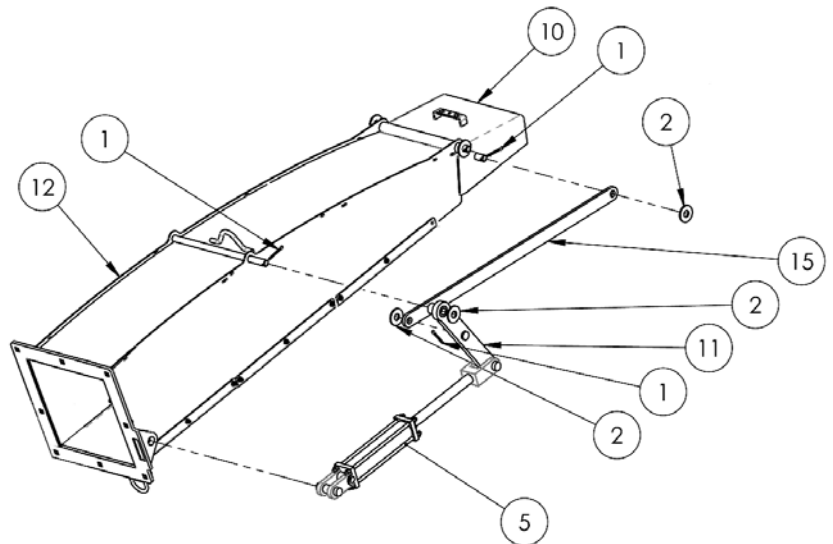

Connect Linkage and Hydraulic Cylinder

46599_A2

Installation of the BP 663 End Deflector for Curved Chute

8. Lift the curved discharge chute with a lifting strap through the lifting hook (1) on the chute.
 - The curved chute weighs about 120 lbs. (55 kg). Use appropriate lifting straps.
 - Lift the end deflector with a lifting strap through the lifting loop (1).
 - Position the deflector with the flange (2) aligned to the turret elbow flange.
9. Secure the new deflector to the turret elbow with the fasteners that had been removed earlier.
 - Torque to 85 lbft (115 Nm).
10. Install the hose holder (3) onto the angle at the base of the turret.
 - Fasten with two of 3/8" x 1" hex bolt and flange locknuts (4).

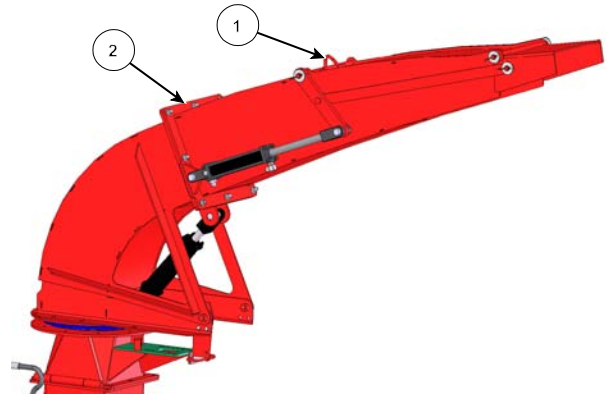

Lift Deflector, Align Flanges

219194C

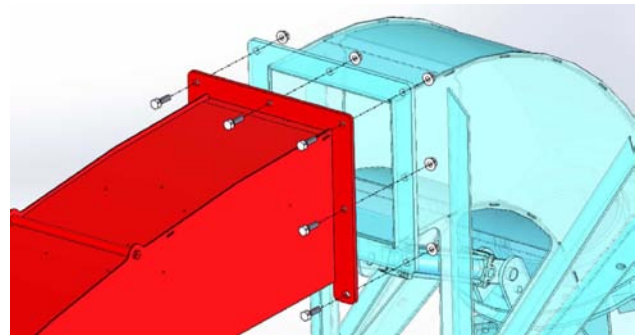

Use Fasteners to Secure Deflector to Elbow

219195

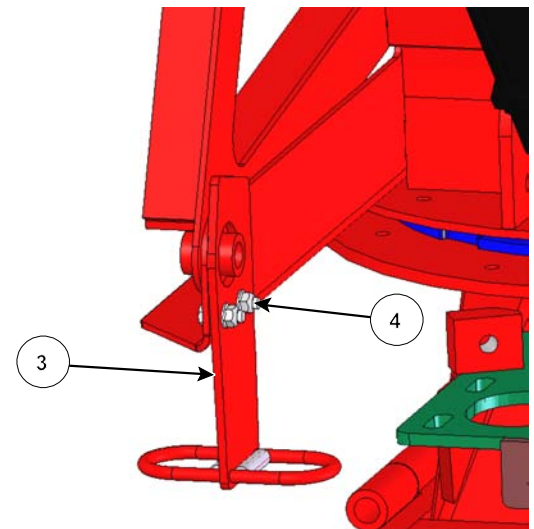

Install The Hose Holder to Turret Base

221051C

Installation of the BP 663 End Deflector for Curved Chute

11. Remove the three existing bolts (5) and locknuts on the rear turret flanges located closest to the tub.
 - Discard these fasteners.

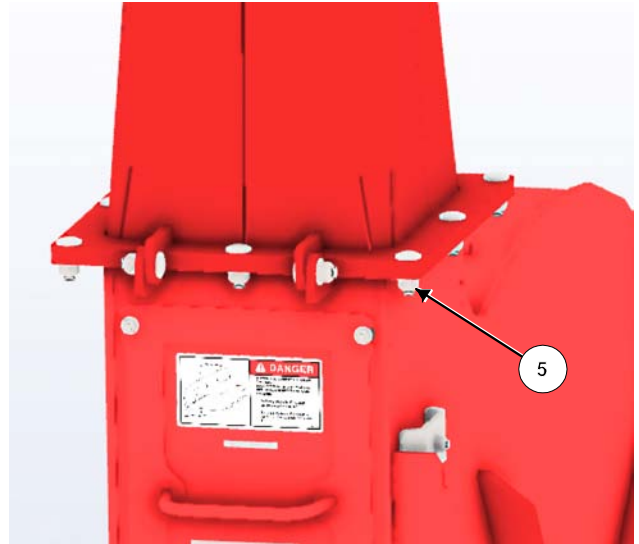

Remove Back 3 Turret Flange Bolts

223180C

12. Attach the hose holder (6) onto the bottom of the rear turret flanges with three of $\frac{1}{2}$ " x 1-3/4" carriage bolts and flange locknuts (4).
 - Torque to 85 lbft (115 Nm).

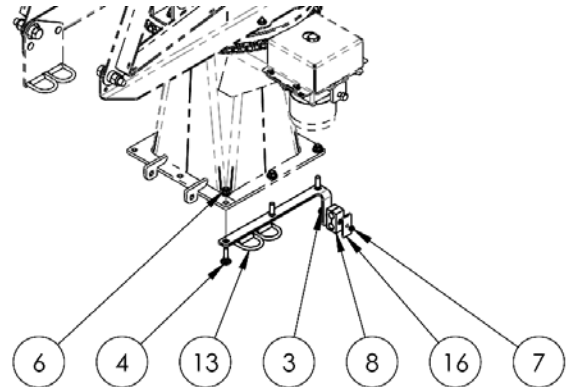

Attach Hose Holder to Underside of Turret Flange

40599_A3

13. Attach the hydraulic hose clamp (8) and the top plate (16) and a $\frac{1}{4}$ " x 2-1/2" carriage bolt (7) and flange locknut (3).



Hose Holder Under
Turret Flanges

223179

1 Remote - Joystick Controlled Top Gun

Hydraulic Connections and Operation

1. Attach the hydraulic fittings and hoses using the diagrams below as a guide.

Note: In this view the nozzle is shown facing the rear of the machine.

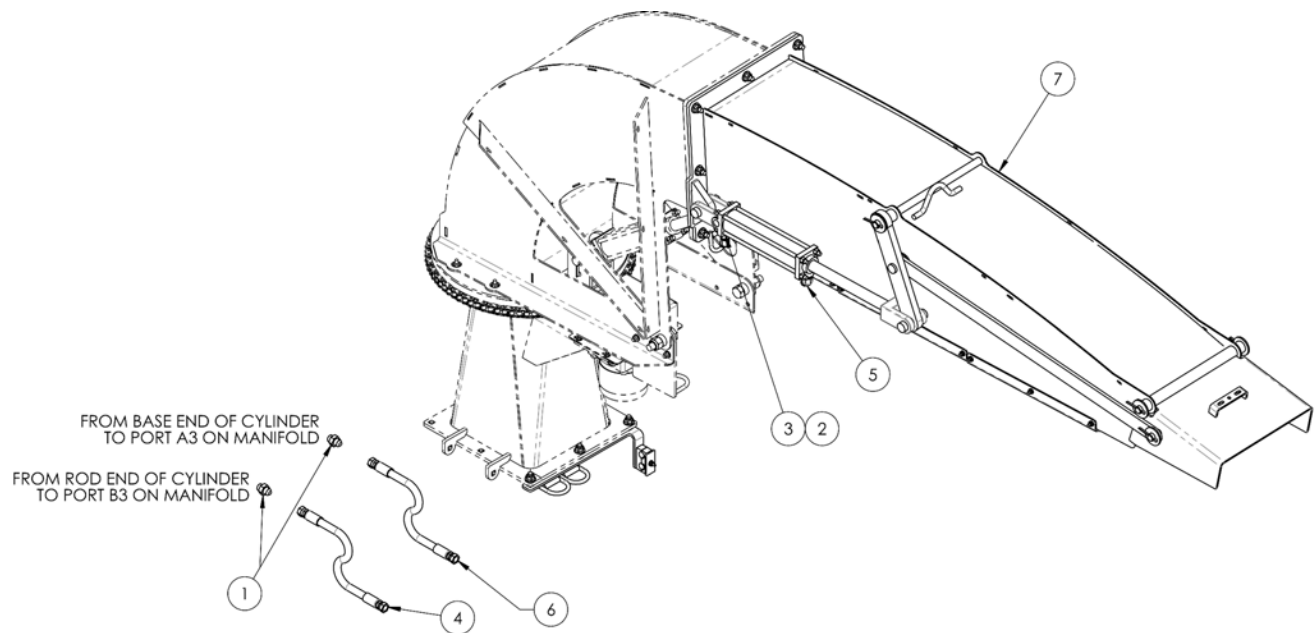

Attach Hydraulic Fittings and Hoses

46927_B

1	HYD,FIT,ADAPTER,8MB-8MJ
2	HYD,FIT,ELBOW,8FJX-8MJ45
3	HYD,FIT,ADAPTER,8MB-8MJ,031ORIFICE
4	HYD,HOSE,3/8X192,8FJX-8FJX,2W
5	HYD,FIT,ELBOW,8MB-8MJ45
6	HYD,HOSE,3/8X186,8FJX-8FJX,2W
7	ASSY,HYD_CHUTE,BTM_BOLT

Installation of the BP 663 End Deflector for Curved Chute

2. Route the hoses through the three loops (1-3) and the hose holder (4). (See the diagram below.)
 - Leave slack in the hoses to allow for the rotation of the turret.
3. Fasten the hoses to the front of the tub wall using the hose clamp.
4. Route the hoses over the guard to the center of the frame.
5. Route the hoses to the valve block/solenoid valve located under the front portion of the frame.
6. Use cables ties and hose wrap as necessary to prevent damage from screen and other components.

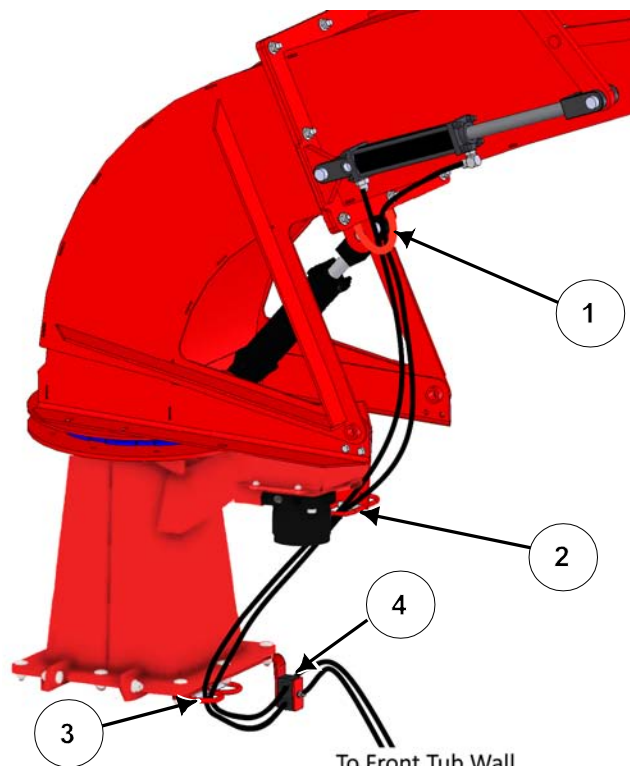

Route Hydraulic Hoses Through Loops and Hose Clamp

223181C

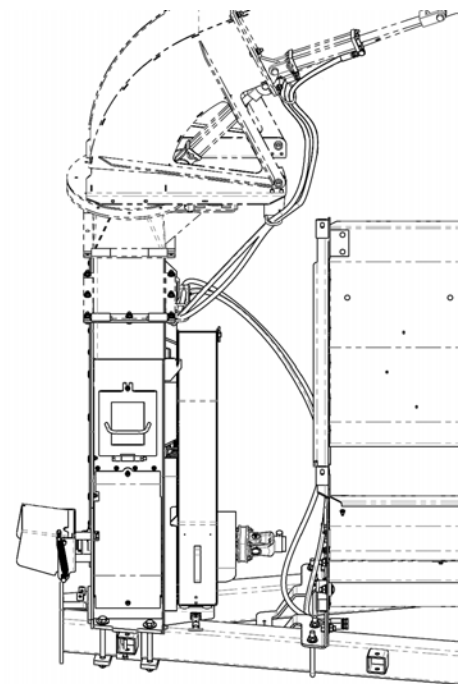

Route Hydraulic Hoses to the Hydraulic

82

7. Connect the hoses to the hydraulic block.
 - Remove the plugs from ports A3 and B3.
 - Connect the cylinder base hose to port A3.
 - Connect the rod end hose to port B3.

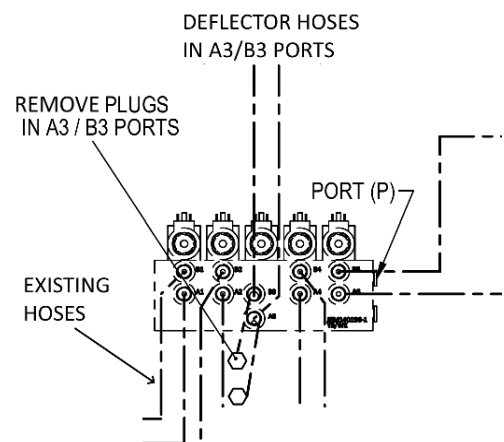

Connect Hoses to Hydraulic Block

42760_F

Installation of the BP 663 End Deflector for Curved Chute

8. Rotate the turret throughout the entire range of travel with the spout in the up position to ensure that the lines do not snag on any part of the machine and there is adequate slack in all parts of the hydraulic line.
9. Repeat this process with the spout in the down position.

Using the End Deflector with the Joystick

1. The joystick will control the operation of the end deflector.

The joystick decal indicates:

- Accessory (Raise) = Deflector Raise
- Accessory (Lower) = Deflector Lower
- Use the joystick with the trigger depressed to raise or lower the end deflector.

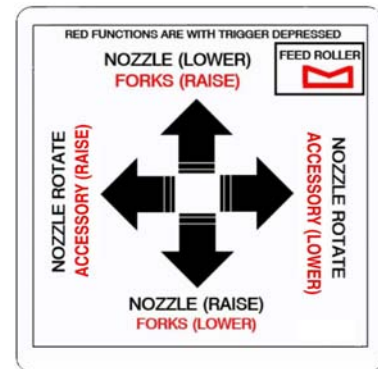

Joystick for Raise/Lower the
End Deflector E14915_A/Joystick Decal

Top Gun with 4 Remote - Hydraulic Connections and Operation

1. Attach the hydraulic fittings and hoses using the diagram below as a guide.

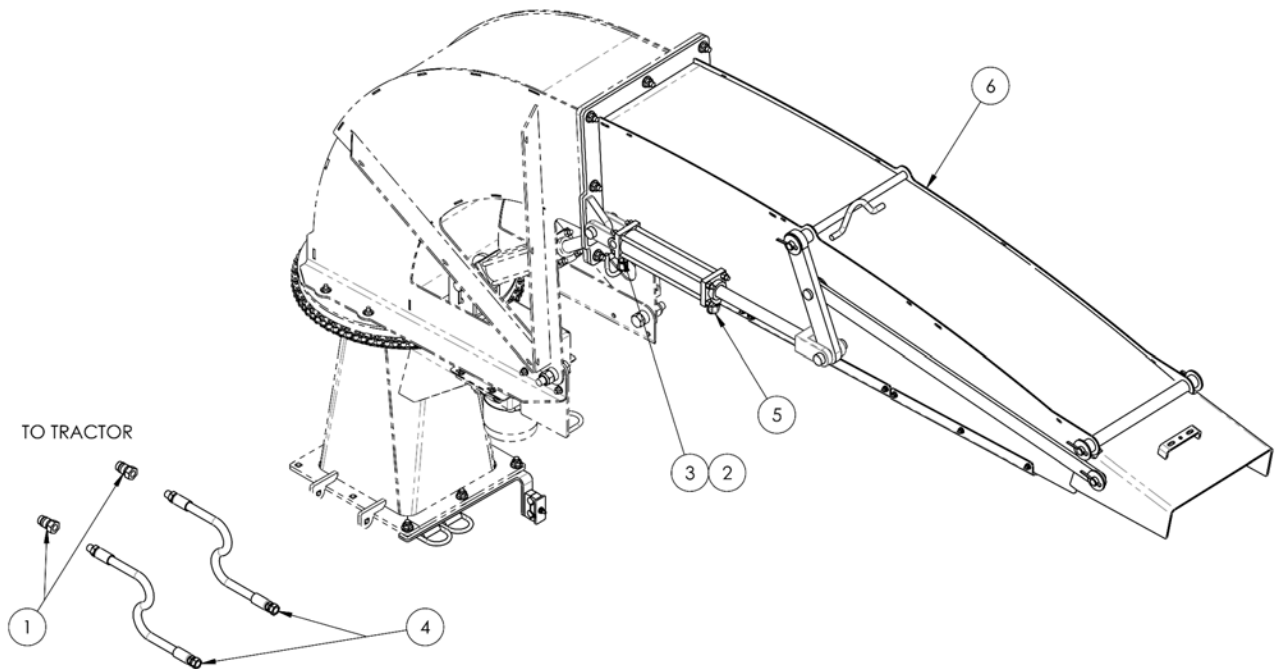

Attach Hydraulic Fittings and Hoses

46928_B

1	HYD,FIT,PIONEER,MALE,8FP
2	HYD,FIT,ELBOW,8FJX-8MJ45
3	HYD,FIT,ADAPTER,8MB-8MJ,031ORIFICE
4	HYD,HOSE,3/8X272,8MP-8FJX,2W
5	HYD,FIT,ELBOW,8MB-8MJ45
6	ASSY,HYD_CHUTE,BTM_BOLT

Installation of the BP 663 End Deflector for Curved Chute

2. Route the hoses through the three loops (1-3) and the hose holder (4). (See the diagram below.)
 - Leave slack in the hoses to allow for the rotation of the turret.

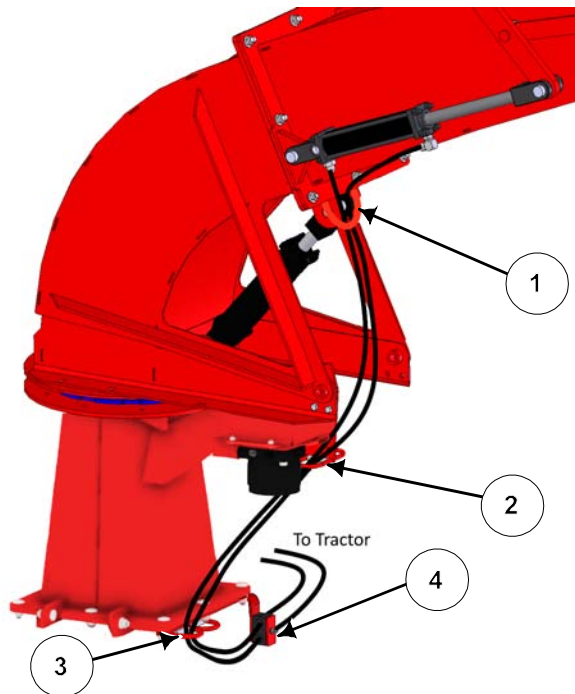

Route Hydraulic Hoses Through Loops and Hose Clamp
223183C

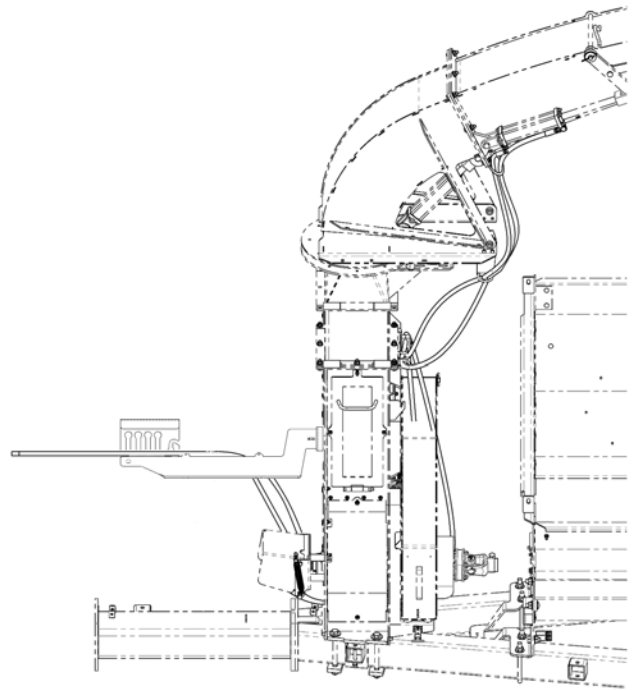

Route Hydraulic Hoses to the Hose Holder and to Tractor
45053_A3

3. Route the hoses to the hose holder on the hitch, into the hose holder and onto the tractor.
4. Connect the hoses to a tractor remote.
5. Rotate the turret throughout the entire range of travel with the spout in the up position to ensure that the lines do not snag on any part of the machine and there is adequate slack in all parts of the hydraulic line.
6. Repeat this process with the spout in the down position.
7. Use cables ties and hose wrap as necessary to prevent damage from screen and other components.