



Shut down the tractor and remove the key before repairing, servicing, lubricating or cleaning the machine.

Relieve all hydraulic pressure in the hoses. Disconnect the hydraulic hoses from the tractor before going near the machine.

Securely block the machine to avoid any movement while doing the work.



Do not enter the tub while the mixers are turning.

Entering the tub when the mixers are turning will result in death or serious injury.

Do not contact the rotating screws.



1. If there is a conveyor installed on the machine, remove the conveyor.
 - Remove the load cell junction box and bracket from the conveyor. This will be re-installed onto the new conveyor.
2. Remove the front conveyor support bracket and hose clamp, and the rear conveyor support bracket from the new hydraulic folding conveyor assembly.
 - Save all hardware for re-use.
3. Install the rear conveyor support bracket (1) onto the platform uprights and below the tub door, see *Figure 1*.
 - Fasten the bracket with 2 of ½" x 1-1/2" hex bolts and flange locknuts (2).
4. Install the front conveyor support bracket (3) onto the platform uprights, see *Figure 2*.
 - Fasten the bracket with 2 of ½" x 1-1/2" hex bolts and flange locknuts (4).

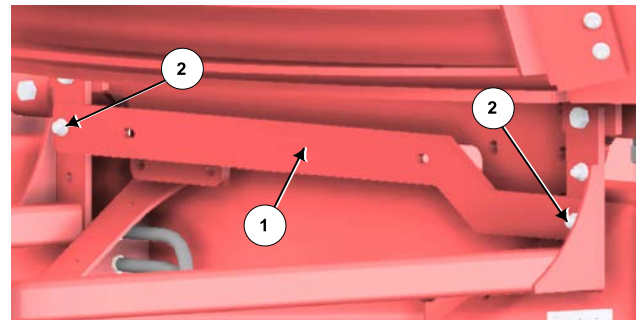

Figure 1: Install the Rear Conveyor Support Bracket

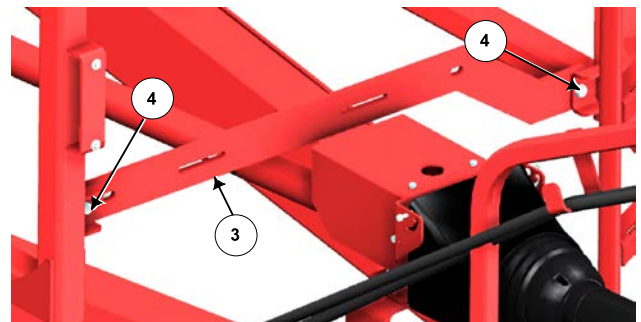

Figure 2: Install the Front Conveyor Support Bracket

5. The components to the hydraulic folding conveyor assembly are assembled according to the diagram (Figure 3) and chart (Table 1) below.

Note: The following will need to be removed and installed again later:

- front shield (23) and the rubber spill guard (24)
- side shield (11)
- cleanout door (6)
- retainer pins (14)
- end shield (22)

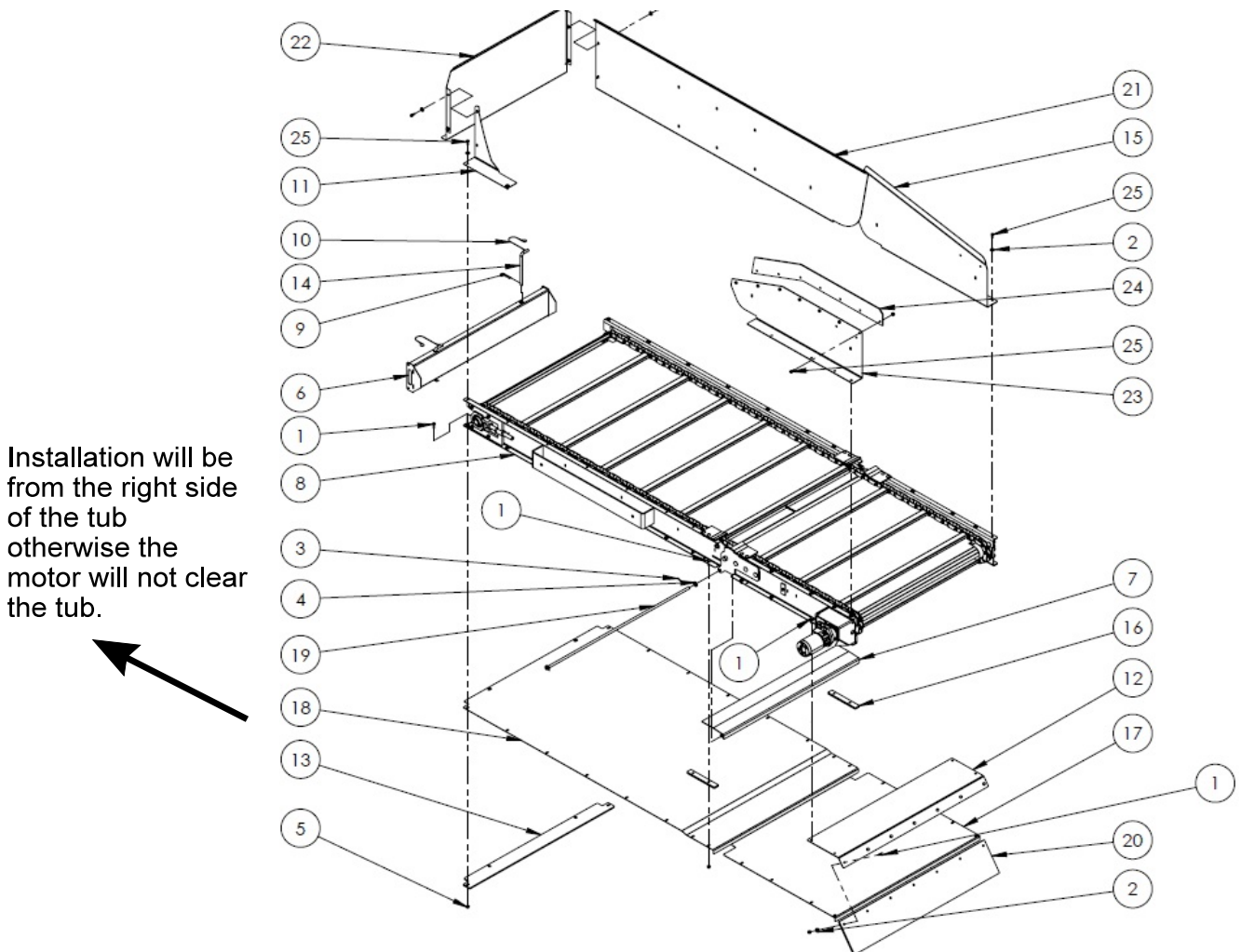

Figure 3: Right Hand Hydraulic Folding Conveyor Assembly

46862_BC2

ITEM	DESCRIPTION
1	BOLT,HEX,5/16X1,UNC,GR5,ZP
2	WASHER,FLAT,5/16,ZP
3	PIN,COTTER,1/8X1
4	WASHER,FLAT,SAE,1/2,ZP
5	NUT,FLG,LOCK,5/16,UNC,GR5,ZP
6	WLDT, CLEANOUT DOOR,CONVEYOR
7	WLDT, FILLER PLATE
8	ASSY,CONVEYOR HYD DRIVE
9	PIN,HAIR,1/8x2-9/16
10	ROPE,WIRE,1/16,COATED,14"
11	PC, SHIELD
12	PC, DEFLECTOR
13	PC, SUPPORT
14	PIN,SHIELD RETAINER,PLTD
15	PC, SHIELD
16	PC, SPACER
17	PC, BOTTOM PANEL
18	PC, BOTTOM PANEL
19	PIN,HINGE,DRILLED
20	BELTING,DROP CHUTE
21	PC, SHIELD
22	PC, SHIELD
23	PC, SHIELD
24	BELTING,CONVEYOR DISCHARGE
25	BOLT,HEX,5/16X3/4,UNC,GR5,ZP

Table 1: Parts list for the Right Hand Hydraulic Folding Conveyor assembly

6. To aid in the installation of the conveyor, place skids (1) between the lower support frame of the platform, see *Figure 4*. Use either:

- 3/4" x 36" wide x 72" long piece of plywood
- 2 of 1" x 4" x 72" long lumber.

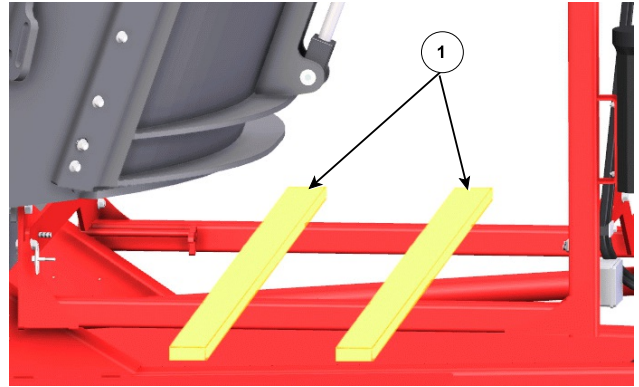

Figure 4: Skids To Help with Installation of Conveyor
(1" x 4" x 72" Skids Shown) 223165C

7. Place the assembled conveyor between the platform uprights and under the tub floor.



There is a pinching/clamping hazard while handling the conveyor. The bed of the conveyor can fold. Avoid placing hands in a pinching/clamping area.



Note: The conveyor is heavy. Use appropriate lifting devices

- Install from the right side of the machine otherwise the conveyor motor will not clear the tub.

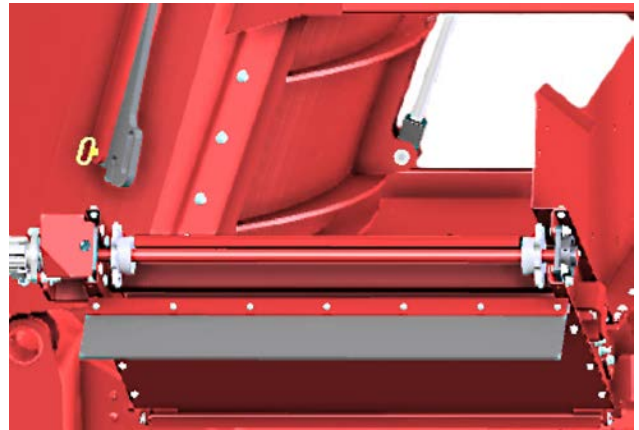

Figure 5: Put the Hydraulic Folding Conveyor in Place 222300

8. Fasten the conveyor to the support brackets (25 & 26) with 4 of 1/2" 1-1/2" hex bolt (6), 1/2" flatwasher (11) and flange locknut.
- See *Figure 6* below.
 - Remove the skids once fastened.
9. If not already attached, attach the hose clamp (16 & 17) with a 5/16" x 1-3/4" hex bolt (7) to the front of the conveyor, see *Figure 6*.

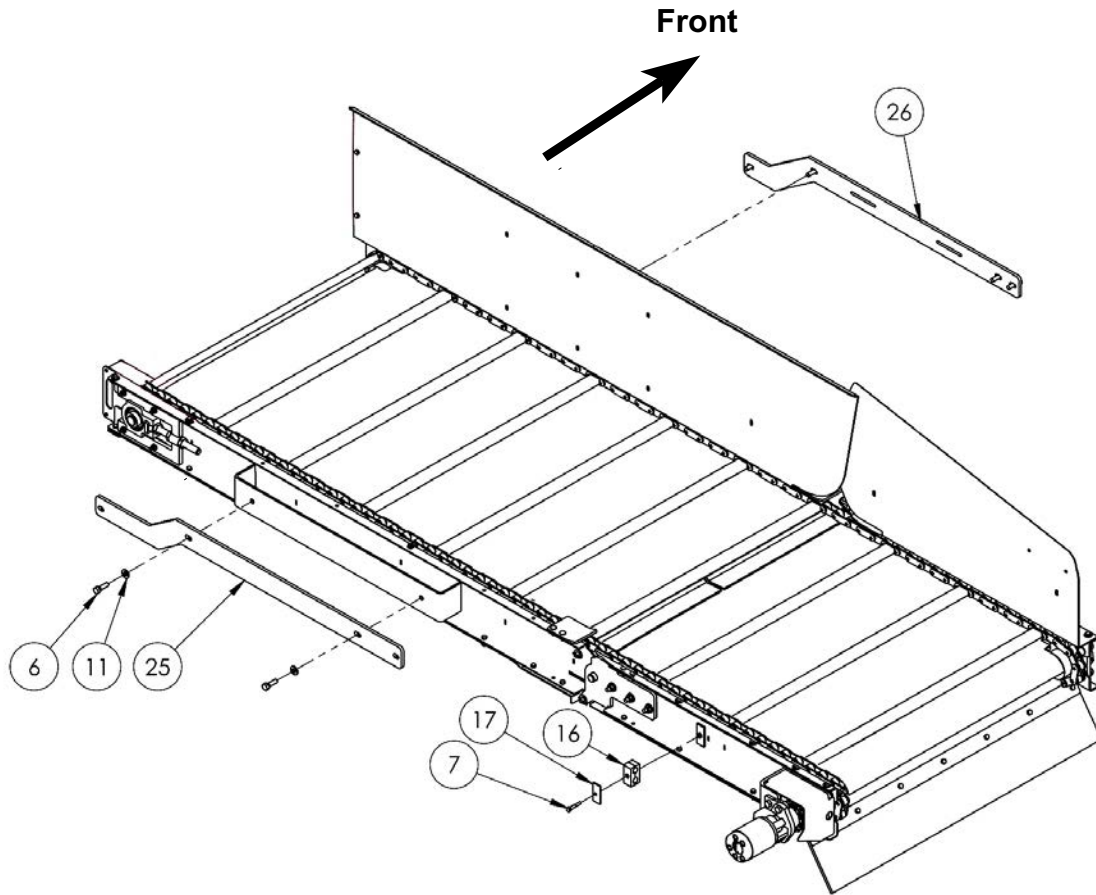

Figure 6: Fasten the Hydraulic Folding Conveyor

46863_A

10. Re-install the load cell junction box bracket onto the front conveyor support bracket using existing hardware.
11. Attach the right rear bent shield to the tub, see *Figure 7*.
 - Remove the bottom 4 locknuts (5) on the right tub door slide cap.
 - Note: Do not remove the locknut that is 2nd from the bottom.
 - Keep the locknuts for re-use.
 - Place the bent shield (6) over the 4 carriage bolts.
 - Fasten with the 4 locknuts (5) removed earlier.

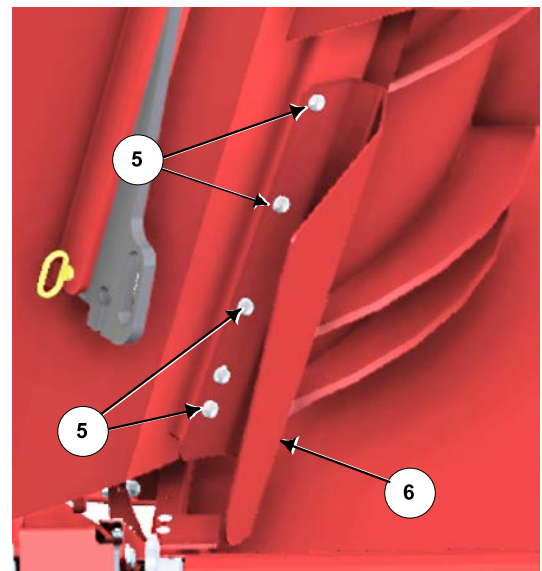

Figure 7: Attach the Bent Shield to the Tub

222301C1

12. Attach the front shield and rubber spill guard (3) to the conveyor, see *Figure 8*.

- Fasten the shield to the conveyor with 4 of 5/16" x 3/4" hex bolts (1), flatwashers and flange locknuts.
- Attach the rubber spill guard (2) to the shield with 7 of 5/16" x 3/4" hex bolts (4) and flange locknuts.
 - Place the flange locknuts against the rubber.

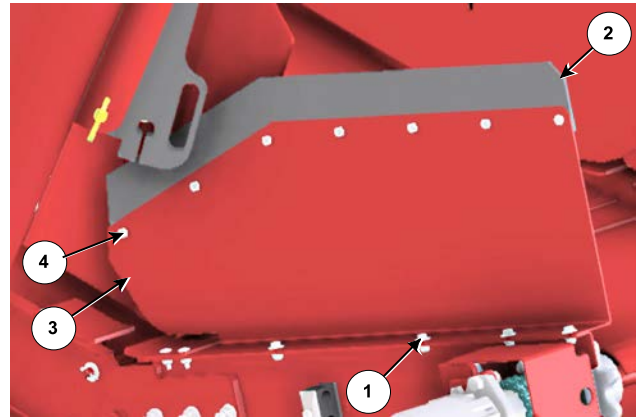

Figure 8: Attach the Front Shield and Spill Guard

222302C

13. Attach the left rear conveyor side shield to the conveyor, see *Figure 9*.

- Fasten the shield with 3 of 5/16" x 3/4" hex bolts (1), flatwashers and flange locknuts.

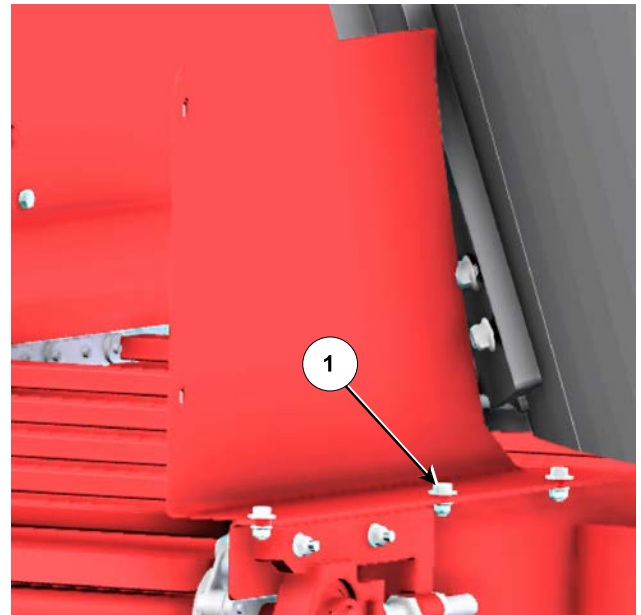

Figure 9: Attach the Left Rear Conveyor Side Shield

223167C

14. Attach the conveyor end shield to the left front and rear shields, see *Figure 10*.

- Fasten the shield with 5 of 5/16" x 3/4" hex bolts (2), flatwashers and flange locknuts.

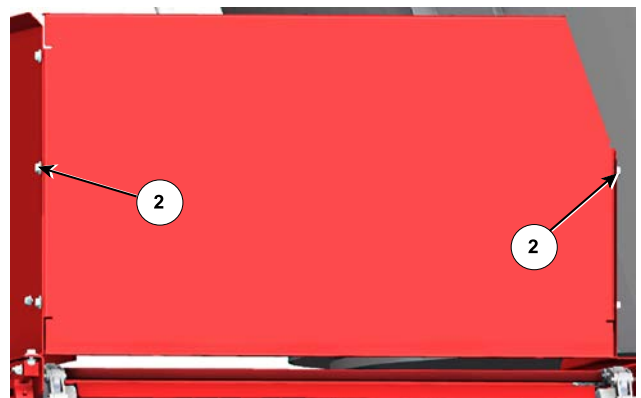

Figure 10: Attach the Conveyor End Shield

223168C

Installation of the Right Hand Hydraulic Folding Conveyor on Towed TMR Mixers

15. Install the conveyor clean out door (3), see *Figure 11*.
 - Fasten in place with the shield pin retainers (4).

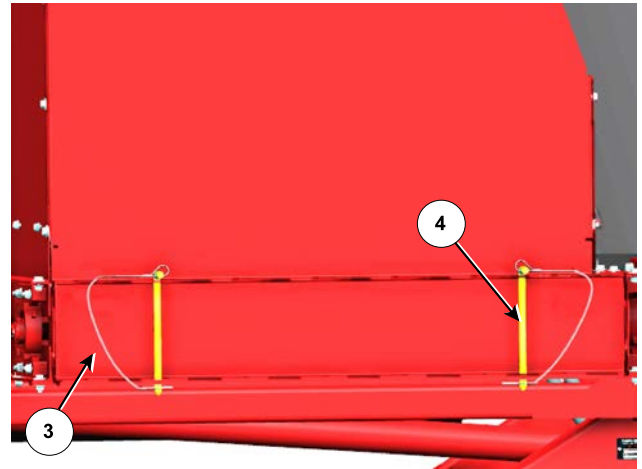

Figure 11: Install the Conveyor Clean Out Door ^{223169C}

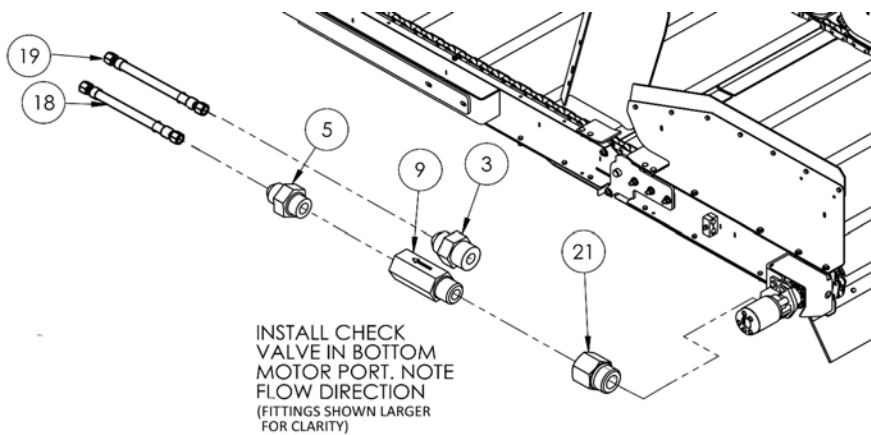

Figure 12: Attach Hydraulic Hoses and Fittings to Motor

ITEM	DESCRIPTION
3	HYD,FIT,ADAPTER,10MB-8MJ
5	HYD,FIT,ADAPTER,8MB-8MJ
9	HYD,VALVE,CHECK,08MB-08FB
18	HYD,HOSE,1/2x57,8FJX-8FJX,2W
19	HYD,HOSE,1/2x60,8FJX-8FJX,2W
21	HYD,FIT,BUSHING,10MB-08FB

46863_A2

Table 2: Parts list for the hydraulic hoses and fittings

16. Connect the hydraulic hoses and fittings to the conveyor motor according to the diagram (*Figure 12*) and chart (*Table 2*).

- Connect the other end of the hydraulic hoses to the bulkhead fittings (6) on the mixer frame, see *Figure 13*.
- The bulkhead fittings connect to hoses that go to the tractor.
- Fasten the hoses to the side of the conveyor with the hose clamp (7) and a 5/16" x 1-3/4" hex bolt.

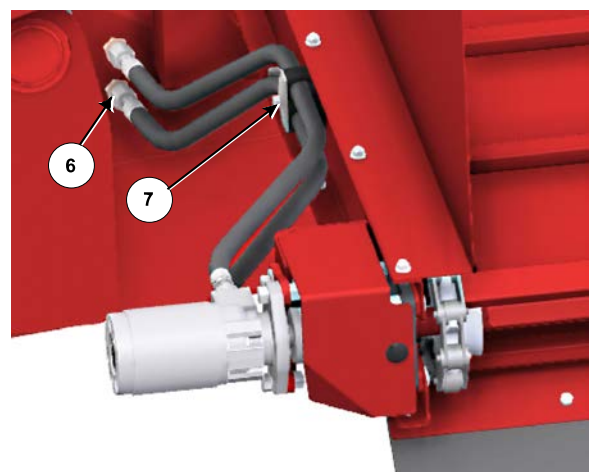

Figure 13: Connect the Hydraulic Hoses ^{223146C}

17. If not already installed, install the hydraulic fold linkage and hydraulic cylinder according to the diagrams (Figures 14, 15) and chart (Table 3) below.

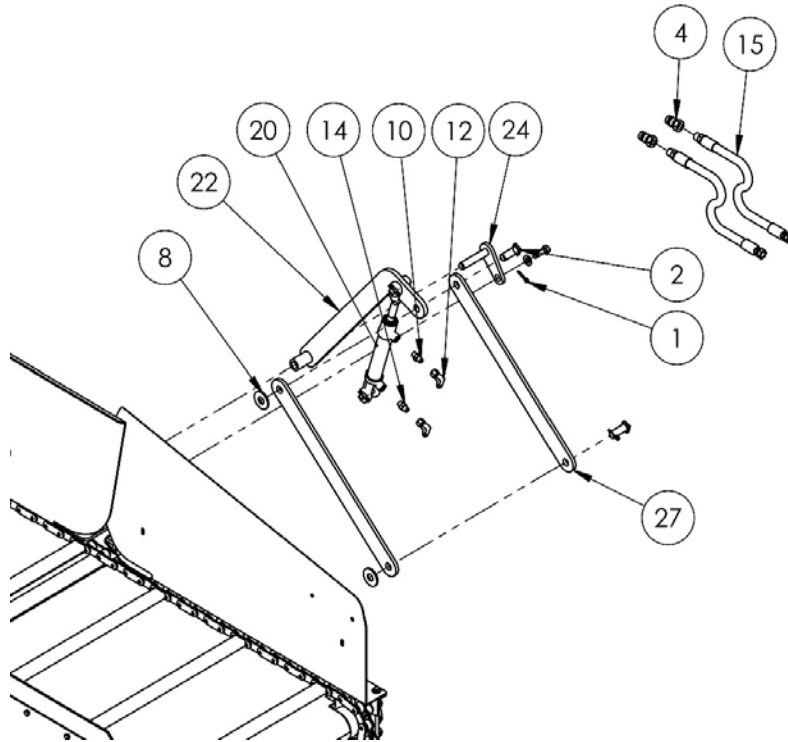
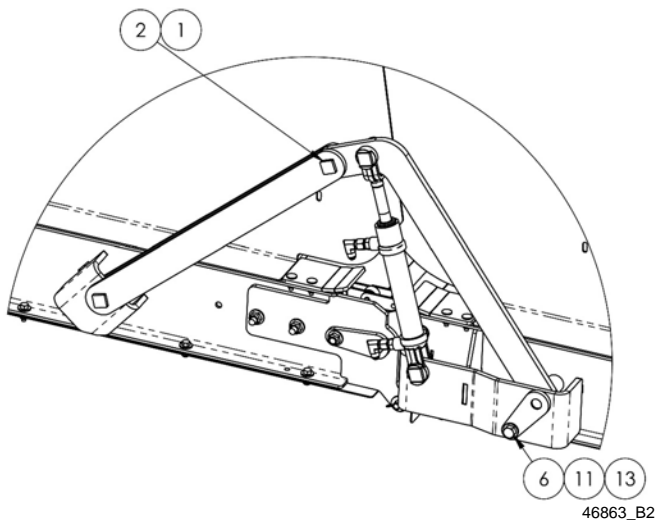

Figure 14: Install the Hydraulic Fold Linkage and Hydraulic Cylinder

46863_A3



46863_B2

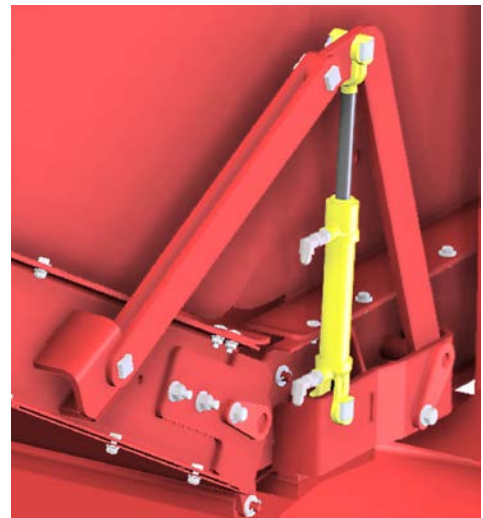

Figure 15: Assembled Hydraulic fold Linkage (Viewed From Front)

222303

ITEM	DESCRIPTION
1	PIN COT 3/16X1-1/4 PLD
2	PIN CYL 3/4X1-5/8 SQ HEAD FGD
4	HYD,FIT,PIONEER,MALE,8FP
6	BOLT,HEX,1/2X1-1/2,UNC,GR5,ZP
8	WASHER,FLAT,3/4,ZP
10	HYD,FIT,ADAPTER,6MB-6MJ
11	WASHER,FLAT,SAE,1/2,ZP
12	HYD,FIT,ELBOW,6MJ-6FJX90
13	NUT,FLG,LOCK,1/2,UNC,GR5,ZP
14	HYD,FIT,ORF,1/32,6MB-6MJ
15	HYD,HOSE,3/8X160,8MP-6FJX,2W
20	CYL HYD 1-1/4X6X16-1/4 OFFSHOR
22	WLDT, LIFT ARM
24	WLDT, PIN,3/4X3-5/8 USBL
27	PC, TENSION LINK

Table 3: Parts list for the Hydraulic Fold Linkage and Hydraulic Cylinder

18. Attach the hydraulic orifice (14) to the base of the hydraulic fold cylinder.
19. Attach the 160" hydraulic hoses (15) to the hydraulic fold cylinder.
 - Attach the hose couplings (4) onto the end of the hoses.
20. Route the hoses as shown in *Figure 16*.
21. Attach the hoses to the hose clamp (1) that is near the load cell junction box, see *Figure 16*.

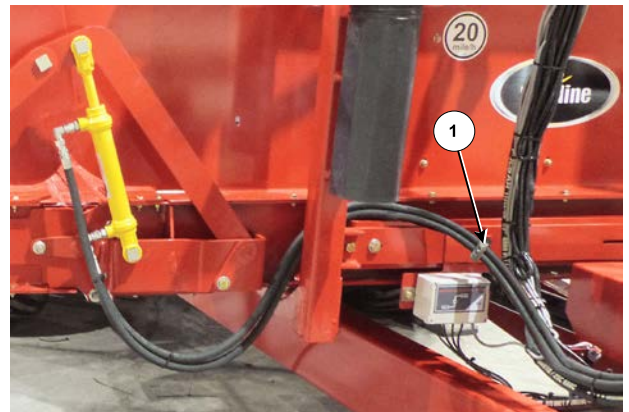

Figure 16: Route Hydraulic Hoses and Attach with the Hose Clamp

223147-2C

22. Route the hoses through the abrasion sleeve, see *Figure 17*.
23. Route the hoses into the hose holder, see *Figure 17*.



Figure 17: Route the Hoses Through the Abrasion Sleeve and Into the Hose Holder
222310

24. Install the transport lock on the right platform upright, see *Figure 18*.
 - To position the transport lock, raise the conveyor.
 - Loosely attach the U-bolt (1) and lock bracket (2) to the platform upright.
 - Insert the lock pin (3) through the lock bracket and into the lift arm (4).
 - Secure the U-bolt (1) and lock bracket (2) in place using flange lock nuts.

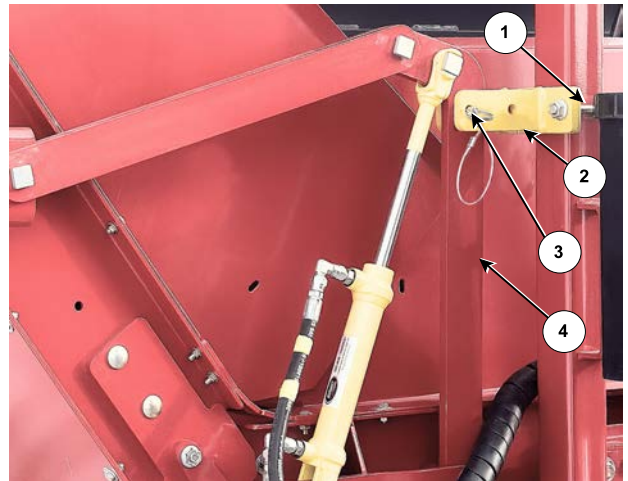

Figure 18: Install the transport lock
224087C2