



Park the BP 965 on level ground.

Lower the forks to the ground for additional stability.

Disconnect the drive shaft from the tractor before beginning any work.

Disconnect the BP 965 from the tractor hitch.



Shut down the tractor and remove the key before repairing, servicing, lubricating or cleaning the machine.

Relieve all hydraulic pressure in the hoses. Disconnect the hydraulic hoses from the tractor before going near the machine.

Securely block the machine to avoid any movement while doing the work.



**Do Not Enter Tub While Parts Are Rotating**

Before entering the tub:

- Turn off the tractor and remove the key.
- Wait for rotating parts to stop

Contact with the rotating flail drum will cause serious injury or death.

1. Ensure the BP 965 upper discharge door is locked in the upright position.



Raise Upper Discharge Door

221454

## Assembly Instructions for the Feed Chopper on the BP 965

### 2. Remove the lower discharge door from the BP 965.

- Remove the door handle (1) by removing the bolt and nut (2).
- Remove the lower door by removing the front and rear bolts and nuts (3) holding the door.
- Discard the door and fasteners.

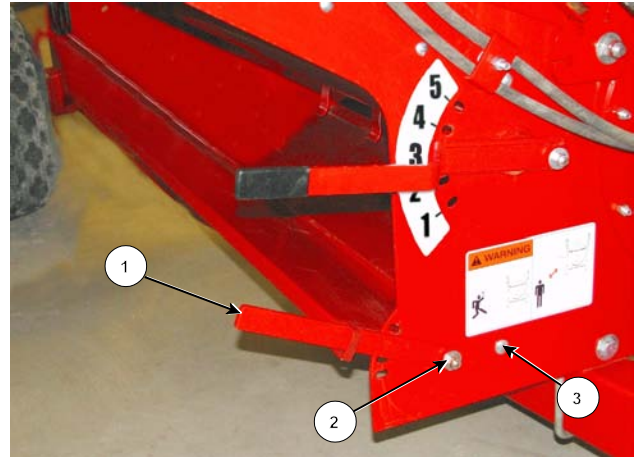

Remove the Lower Discharge Door

214087-2C

### 3. Extend the right axle.

- Jack up the right wheel.
  - Place the jack under the cylinder mount and support.
- Loosen the right axle u-bolt.
- Slide the axle to be 10" (254 mm) from the frame to the axle plate.
- Tighten the u-bolt to 200 ft-lb (271 Nm).

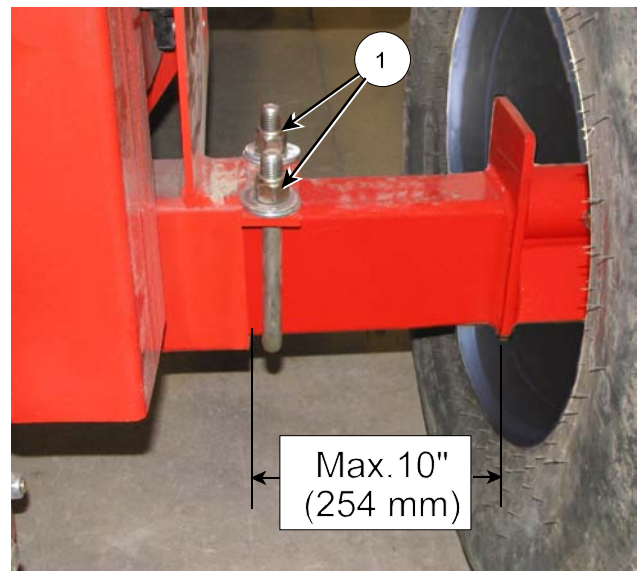

Extend the Right Axle

221440C2

4. Lift the feed chopper and slide the housing between the tub walls.

- Align the upper mounting holes of the chopper housing with the mount holes in the tub wall.
- Fasten both sides with  $\frac{3}{4}$ " x  $2\frac{1}{2}$ " carriage bolts and locking nuts (1).
- Align the lower mounting holes of the chopper housing with the mount holes in the tub wall.
- Fasten both sides with  $\frac{3}{4}$ " x  $2\frac{1}{2}$ " carriage bolts and locking nuts (2).

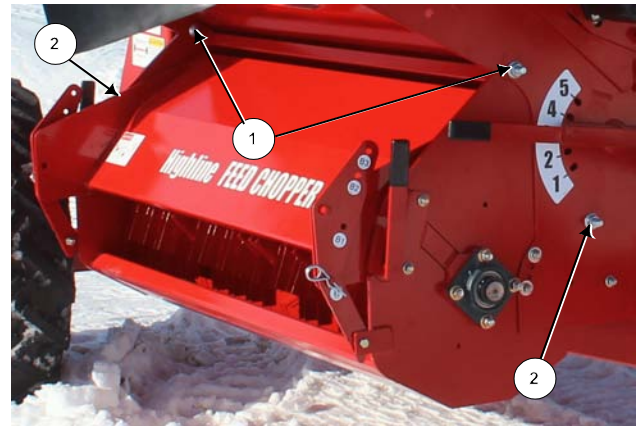

Slide the Housing into the Tub Walls

221441C

5. Align the lower portion of the chopper housing with the upper and lower mounting slots (3) in the tub wall.

- Fasten both sides with 2 of  $\frac{1}{2}$ " x  $1\frac{3}{4}$ " carriage bolts, flatwashers against the slots and locknuts (3).

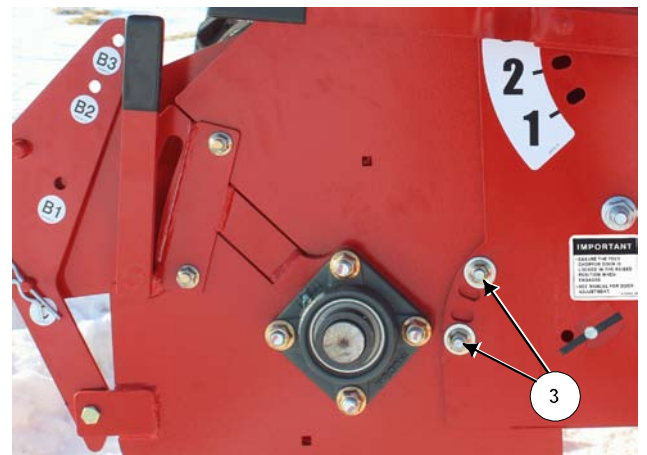

Fasten Lower Portion of the Housing

221312-1C

6. On the back tub wall remove the flail drum lock mechanism.

- Remove the inner roll pin (1).
- Remove the spring.
- Remove the large lock pin (2) from the tab.

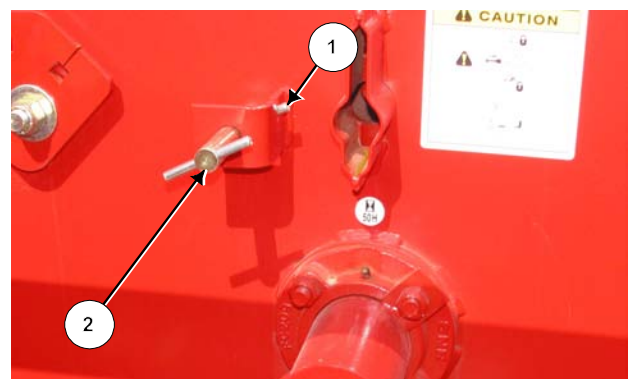

Remove Flail Drum Lock From Back Wall

212024C

7. On the front tub wall install the flail drum lock mechanism.

- Place the spring (1) between the tab and the front tub wall.
- Insert the large pin (2) into the tab and through the spring and into the hole in the tub wall.
- Insert the roll pin (3) into the pin hole to keep pressure on the spring.

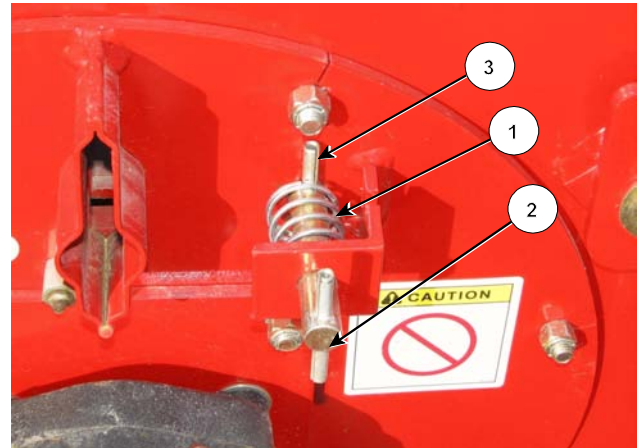

Install Flail Drum Lock On Front Wall

221364C

8. Lock the flail drum.

- Turn the lock pin to release the roll pin from the slot.
- Allow the spring to push the lock pin into the processing chamber.
- Manually rotate the driveline until the lock pin snaps into place locking the flail drum.

9. Remove the rear flail drum shaft cover located on the back tub wall.

- Remove the 2 nuts holding the cover tabs (4) onto the bearing bolts.
- Replace the nuts onto the bearing bolts.
- Discard the cover.

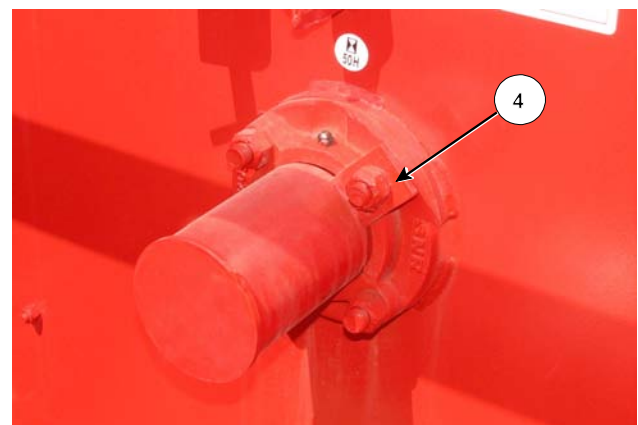

Remove Rear Flail Shaft Cover

212025C

10. Prepare the large sheave by engaging the clutch lock on the large feed chopper sheave.

- Rotate the clutch pin until the roll pins go into the slots.
- Push the clutch pin in and rotate until the middle roll pin (5) is behind the front plate.

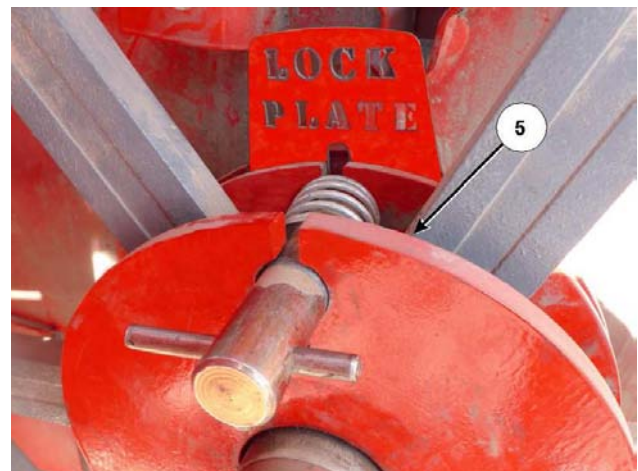

Engage Clutch Lock

217159C



## Assembly Instructions for the Feed Chopper on the BP 965

11. Install the large sheave according to the chart, diagram and instructions.

ITEM	DESCRIPTION
1	ASSY,CLUTCH FC
4	PLT,FC SHEAVE
5	TUBE,BUSHING
6	SPACER,FC
7	BOLT,HEX,1/2X1-3/4,UNC,GR5,ZP
9	WASHER,LOCK,1/2,ZP

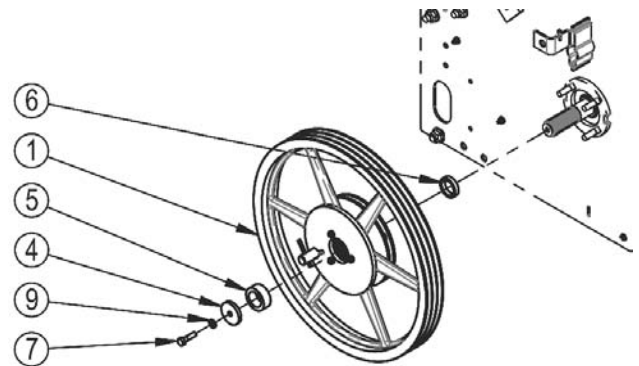

Components For Sheave Installation

43762\_A

12. Slide the sheave spacer (6) onto the rear flail drum shaft.
13. Position the sheave so that the twine cutter opening (1) on the rear tub wall is between spokes.
14. Slide the sheave onto the splines of the rear flail drum shaft.
15. Slide the bushing tube (5) over the spline and into the clutch.
16. Place the sheave plate (4) on the end of the drum shaft.
17. Place Loctite Blue onto the 1/2" x 1-3/4" bolt (7).
18. Fasten the sheave to the shaft with the bolt (7) and lockwasher (9).  
- Torque to 78 ft-lb (106 Nm).



Align Sheave Spokes for Twine Cutter

212026C

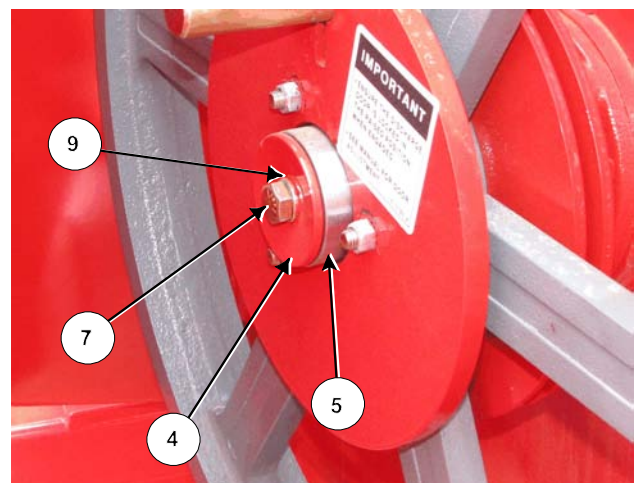

Install the Sheave on the Drum Shaft

212027-2C

## Assembly Instructions for the Feed Chopper on the BP 965

19. Mount the spring belt tensioner onto the rear tub wall.

ITEM	DESCRIPTION
2	ASSY,TENSIONER,SPRING,FC
8	BOLT,HEX,1/2X1-1/2,UNC,GR5
10	NUT,FLG,LOCK,1/2,UNC,GR5,ZP
11	NUT,FLG,LOCK,3/4,UNC,GR5,ZP

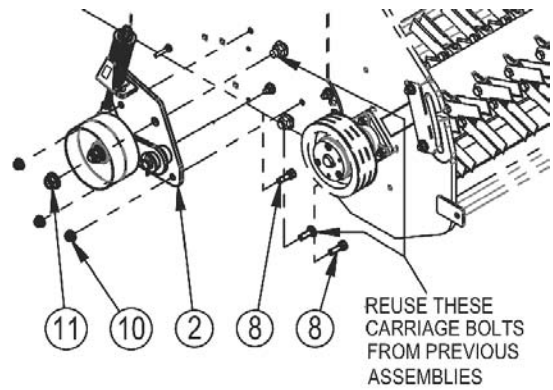

Mount Belt Spring Tensioner

43762\_A

20. Install the drive belt around the large sheave, over the tensioner and around the small chopper sheave.



Install The Drive Belt

221453

21. Tighten the belt tensioner.
- Turn the nut (4) next to the spring washer (1) to adjust the spring.
  - Tighten until the bottom of the spring washer (1) is flush with the bottom of the tension gauge window (2).
  - Tighten the jam nut (3).

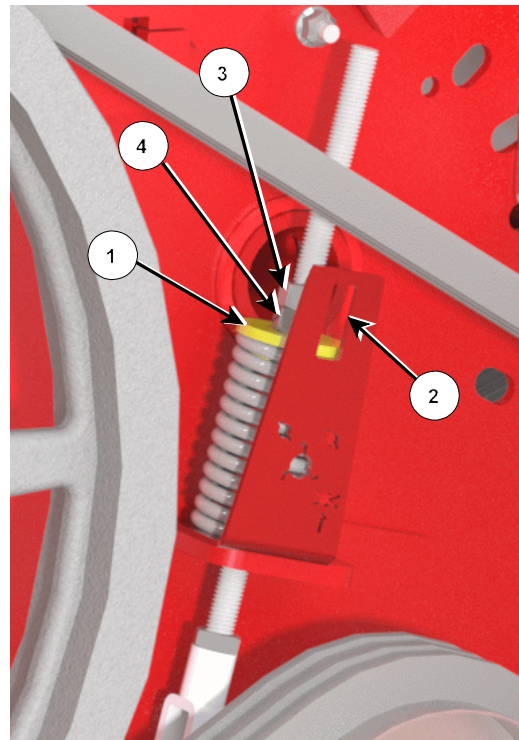

Belt Tension Spring Adjustment

219058C

## Assembly Instructions for the Feed Chopper on the BP 965

22. Install the lower shield over the chopper small sheave.

ITEM	DESCRIPTION
5	BOLT,HEX,3/8X1,UNC,GR5,ZP
7	BOLT,CARR,3/8X1-1/4,GR5,ZP
8	NUT,FLG,LOCK,3/8,UNC,GR5,ZP
10	NUT,FLG,LOCK,5/16,UNC,GR5,ZP
13	GUARD,FC,LOWER

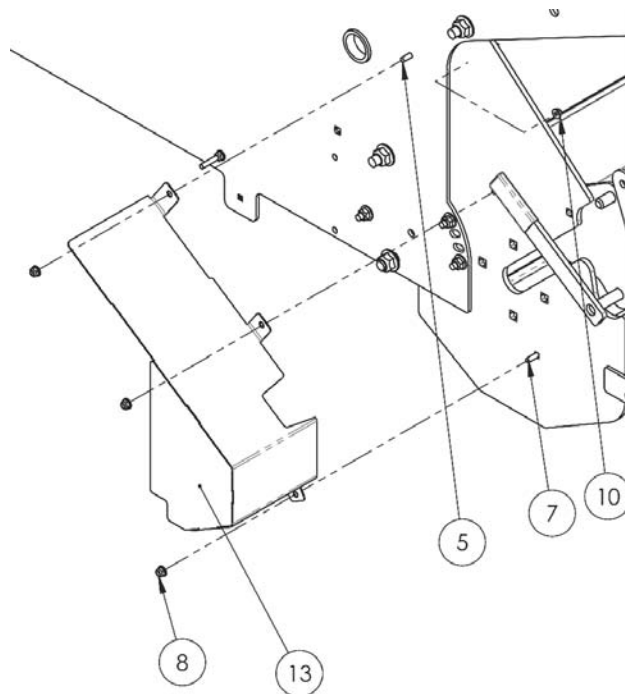

Install the Lower Shield

46126\_C1

23. Install the rubber door fastener (1) to the rear of the tub.
- Place on the hole above the middle shield holder.
  - Fasten with 5/16" x 1" bolt and flange locknut.

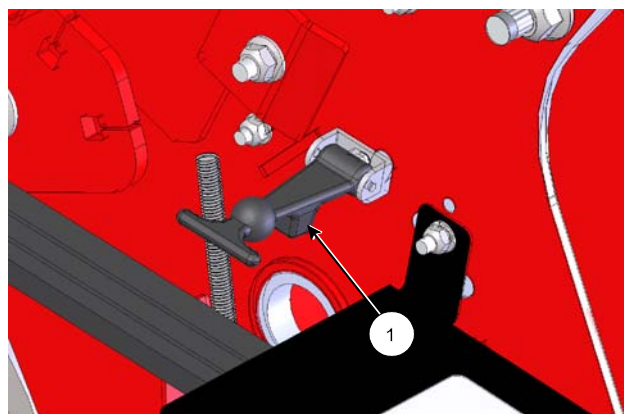

Install the Rubber Latch

221443C

## Assembly Instructions for the Feed Chopper on the BP 965

24. Install the rear upper shield to the rear tub wall



Install the Rear Upper Shield

221444

- Attach the shield with 2 of 3/8" x 1-1/4" carriage bolts and flange locknuts (2).

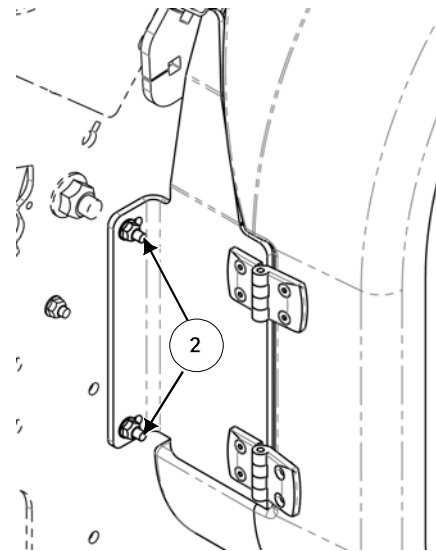

Fasten Shield to Rear Tub Wall

46126\_C2C

25. Install the chopper door front and rear support brackets according to the chart and diagram.

Note: Tighten the locknut but allow the bracket to freely move around the bolt.

ITEM	DESCRIPTION
1	BOLT, HEX, 1/2X1-3/4, UNC, GR5, ZP
2	NUT, NYLOCK, 1/2, UNC, ZP
3	WASHER, FLAT, 1/2, ZP
7	BRACKET, FC DOOR

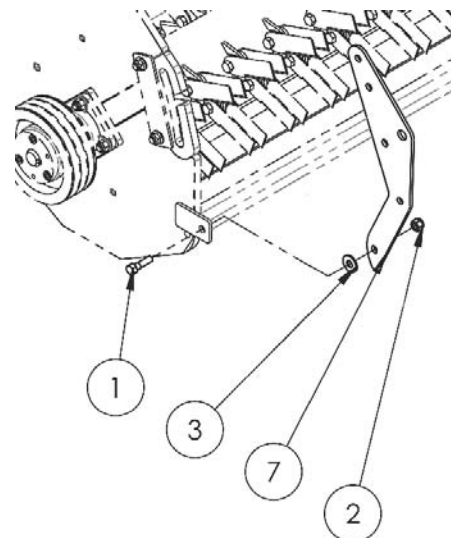

Install the Door Supports

46318\_A



## Assembly Instructions for the Feed Chopper on the BP 965

26. Slide the chopper door into the housing.
- Place the rods of the door handles (2) into the slots.
  - Allow the door to go to the bottom of the slots.

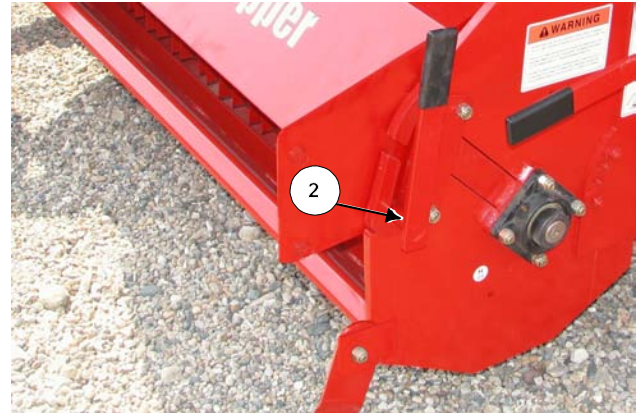

Install the Feed Chopper Door

221445C

27. Rotate the chopper door to the Feed Chopper operating position.
- Fasten with the door support brackets into the hole marked "C".
  - Secure in place with the spring pins .



Rotate the Door to the Operating Position

221311