



Park the BP 660 on level ground.

Lower the forks to the ground for additional stability.

Disconnect the drive shaft from the tractor before beginning any work.

Disconnect the BP 660 from the tractor hitch.



Shut down the tractor and remove the key before repairing, servicing, lubricating or cleaning the machine.

Relieve all hydraulic pressure in the hoses. Disconnect the hydraulic hoses from the tractor before going near the machine.

Securely block the machine to avoid any movement while doing the work.



Do Not Enter Tub While Parts Are Rotating

Before entering the tub:

- Turn off the tractor and remove the key.
- Wait for rotating parts to stop

Contact with the rotating flail drum will cause serious injury or death.

1. Ensure the BP 660 upper discharge door is locked in the upright position.



Raise the Upper Discharge Door

221439

Assembly Instructions for the Feed Chopper on the BP 660

2. Remove the lower discharge door from the BP 660.
 - Remove the door handle (1) by removing the bolt and nut (2).
 - Remove the lower door by removing both bolts and nuts (3) that are holding the door.
 - Discard the door, handle and all fasteners.

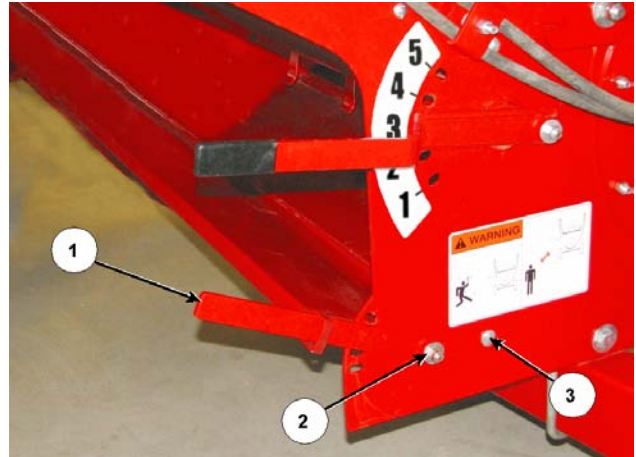

Remove the Lower Discharge Door

201208C

3. Extend the right axle.
 - Jack up the right wheel.
 - Place the jack under the frame near the cylinder mount and support.

Note: The wheel and spindle do not need to be removed.

- Loosen the right axle u-bolt (1).
- Slide the axle to be 8" (203) from the frame to the axle plate.
- Tighten the u-bolt to 200 ft-lb (270 Nm).
- Lower the right wheel.

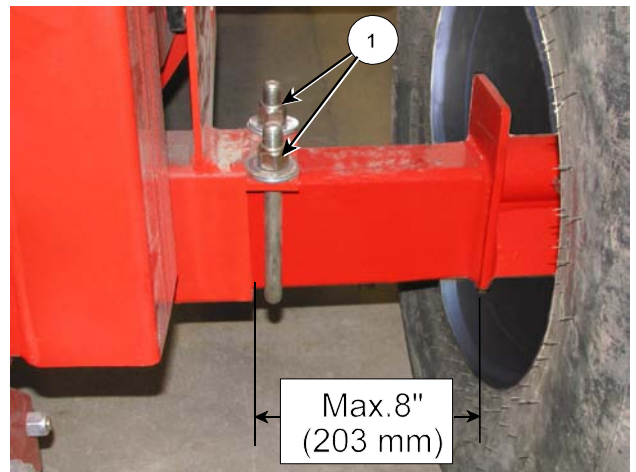

Extend the Right Axle

221440C

4. Lift the feed chopper and slide the housing into the BP 660.
 - Place the chopper between the tub walls.
 - Align the upper mounting holes of the chopper housing with the mount holes in the tub wall.
 - Fasten both sides with 3/4" x 2 1/2" carriage bolts and locking nuts (1).
 - Align the lower mounting holes of the chopper housing with the mount holes in the tub wall.
 - Fasten with both sides with 3/4" x 2 1/2" carriage bolts and locking nuts (2).



Slide Housing into the Tub Walls

221441C

Assembly Instructions for the Feed Chopper on the BP 660

5. Align the lower portion of the chopper housing into the mounting slots in the tub wall.

- Fasten both sides with 2 of $\frac{1}{2}$ " x $1 \frac{3}{4}$ " carriage bolts, flatwashers against the slots and locknuts (3).

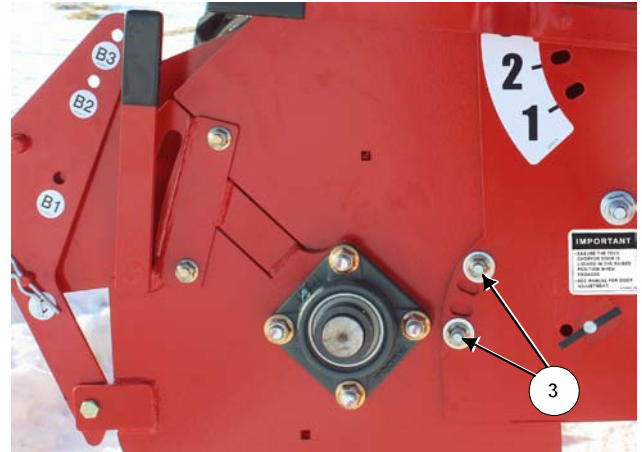

Fasten Lower Portion of the Housing

221312-1C

6. Remove the flail drum lock mechanism from the back tub wall.

- Remove the inner roll pin (1).
- Remove the spring.
- Remove the large lock pin (2) from the tab.

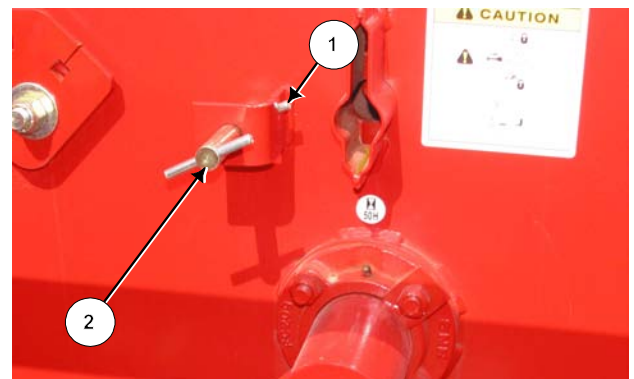

Remove Flail Drum Lock From Back Wall

212024C

7. Install the flail drum lock mechanism on the front tub wall.

- Place the spring (1) between the tab and the front tub wall.
- Insert the large pin (2) into the tab and through the spring and into the hole in the tub wall.
- Insert the roll pin (3) into the hole to keep pressure on the spring.

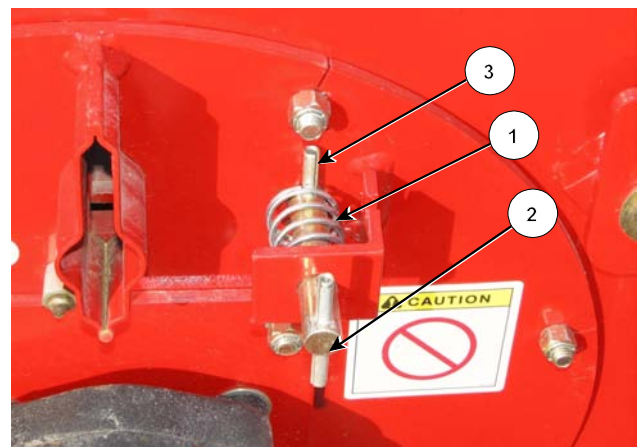

Install Flail Drum Lock On Front Wall

221364C

8. Lock the flail drum.

- Turn the lock pin to release the roll pin from the slot.
- Allow the spring to push the lock pin into the processing chamber.
- Manually rotate the driveline until the lock pin snaps into place locking the flail drum.

Assembly Instructions for the Feed Chopper on the BP 660

9. Remove the rear flail drum shaft cover located on the back tub wall.

- Remove the 2 nuts holding the cover tabs (4) onto the bearing bolts.
- Replace the nuts onto the bearing bolts.
- Discard the cover.

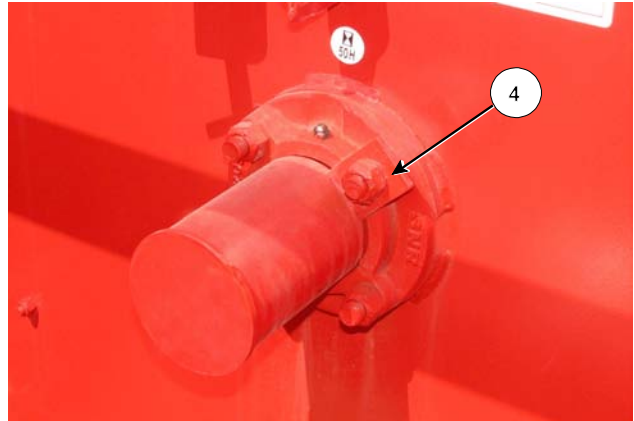

Remove Rear Flail Shaft Cover

212025C

10. To install the sheave, engage the clutch lock on the large feed chopper sheave.

- Rotate the clutch pin until the roll pins go into the slots.
- Push the clutch pin in and rotate until the middle roll pin (5) is behind the front plate.

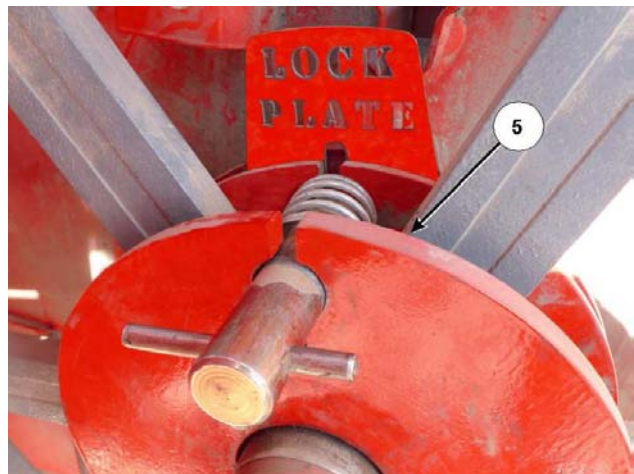

Engage Clutch Lock

217159C

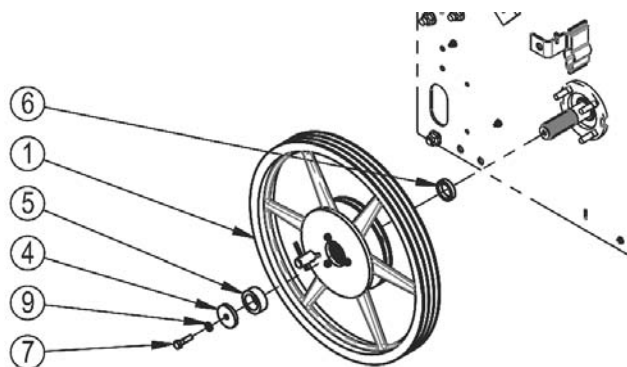

Components For Sheave Installation

43762_A

ITEM	DESCRIPTION
1	ASSY,CLUTCH FC
4	PLT,FC SHEAVE
5	TUBE,BUSHING
6	SPACER,FC
7	BOLT,HEX,1/2X1-3/4,UNC,GR5,ZP
9	WASHER,LOCK,1/2,ZP

Assembly Instructions for the Feed Chopper on the BP 660

11. Slide the sheave spacer (6) onto the rear flail drum shaft.
12. Position the sheave so that the twine cutter opening (1) on the rear tub wall is between spokes.
13. Slide the sheave onto the splines of the rear flail drum shaft.
14. Slide the bushing tube (5) over the spline and into the clutch.
15. Place the sheave plate (4) on the end of the drum shaft.
16. Place Loctite Blue onto the 1/2" x 1-3/4" bolt (7).
17. Fasten the sheave to the shaft with the bolt (7) and lockwasher (9).
 - Torque to 78 ft-lb (106 Nm).



Align Sheave Spokes for Twine Cutter

212026C

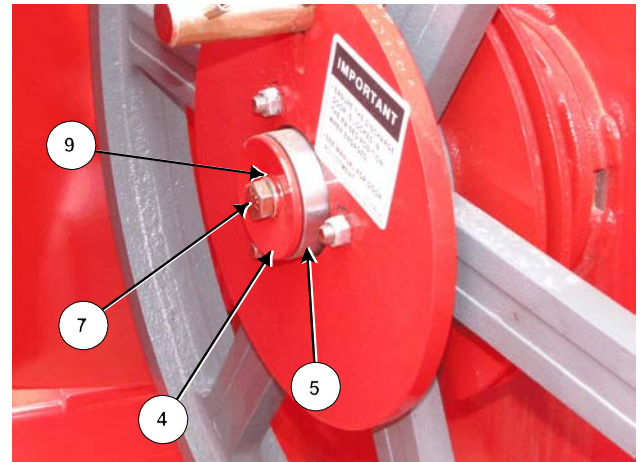

Install the Sheave on the Drum Shaft

212027-2C

18. Mount the belt tensioner onto the rear tub wall.

ITEM	DESCRIPTION
2	ASSY,TENSIONER,SPRING,FC
8	BOLT,HEX,1/2X1-1/2,UNC,GR5,ZP
10	NUT,FLG,LOCK,1/2,UNC,GR5,ZP
11	NUT,FLG,LOCK,3/4,UNC,GR5,ZP

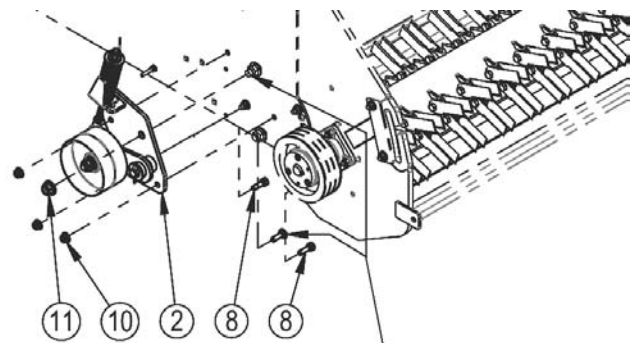

REUSE THESE CARRIAGE BOLTS
FROM PREVIOUS ASSEMBLIES

Install Spring Tensioner

43762_A2

19. Install the drive belt around the large sheave, over the tensioner and around the small chopper sheave.



Install The Drive Belt

219060

20. Tighten the belt tensioner.
- Turn the nut (4) next to the spring washer to adjust the spring.
 - Tighten until the bottom of the spring washer (1) is flush with the bottom of the tension gauge window (2).
 - Tighten the jam nut (3).

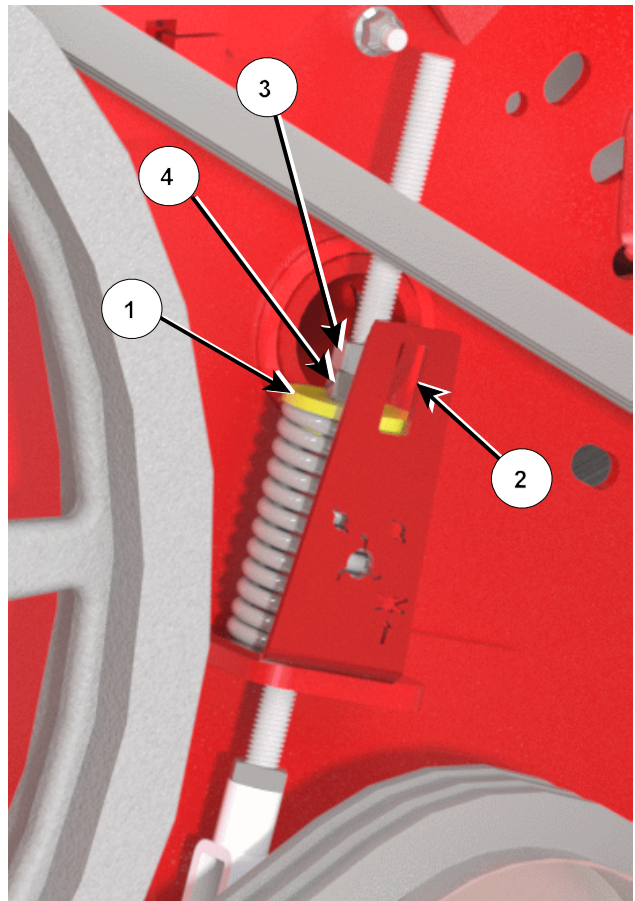

Belt Tension Spring Adjustment

219058C

Assembly Instructions for the Feed Chopper on the BP 660

21. Install the chopper door lock on the lower right front tub wall.
- Place the lock pin (1) into the lock bracket.
 - Place the spring (2) over the lock pin.
 - Place the 3/16" x 1-1/2" spring pin (3) into the lock pin.
 - Pull the lock pin back and install the 5/16" x 3" spring pin (4).

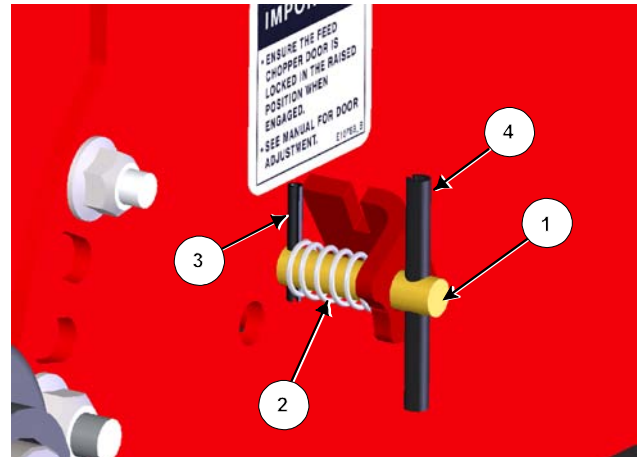

Install the Chopper Door Lock Pin

221314C

22. Install the lower shield over the small sheave.

ITEM	DESCRIPTION
5	BOLT,HEX,3/8X1,UNC,GR5,ZP
7	BOLT,CARR,3/8X1-1/4,GR5,ZP
8	NUT,FLG,LOCK,3/8,UNC,GR5,ZP
10	NUT,FLG,LOCK,5/16,UNC,GR5,ZP
13	GUARD,FC,LOWER

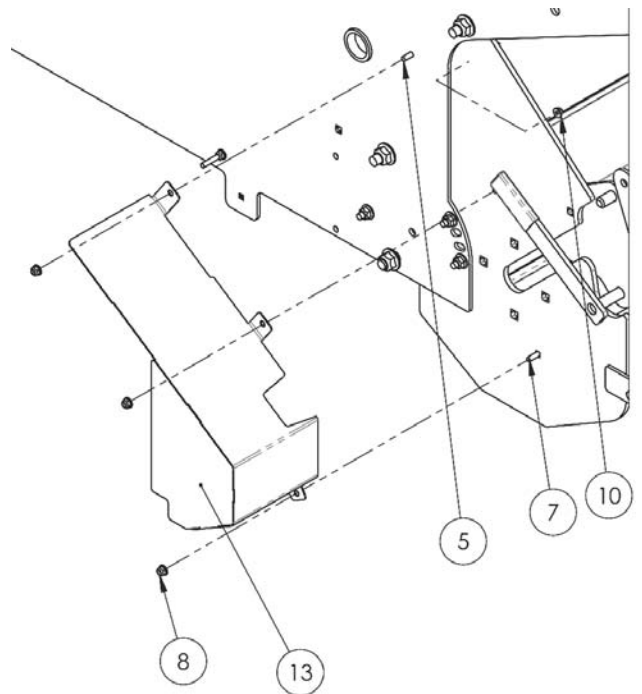

Install Lower Shield

46126_C1

23. Install the rubber door fastener (1) to the rear of the tub. Place on the hole above the middle shield holder.
- Fasten with 5/16" x 1" bolt and flange locknut.

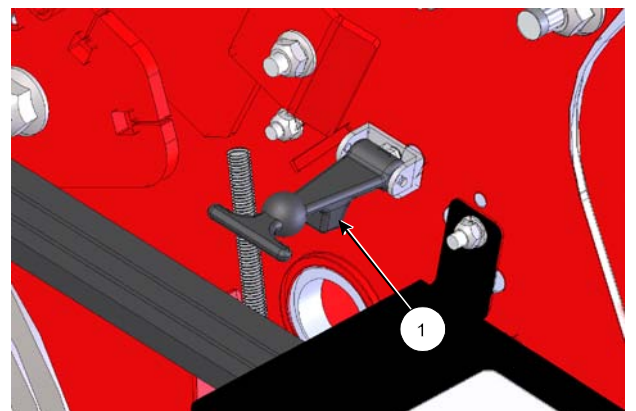

Install the Rubber Latch

221443C

Assembly Instructions for the Feed Chopper on the BP 660

24. Install the rear upper shield to the rear tub wall



Install the Rear Upper Shield

221444

- Attach the shield with 2 of 3/8" x 1-1/4" carriage bolts and flange locknuts (2).

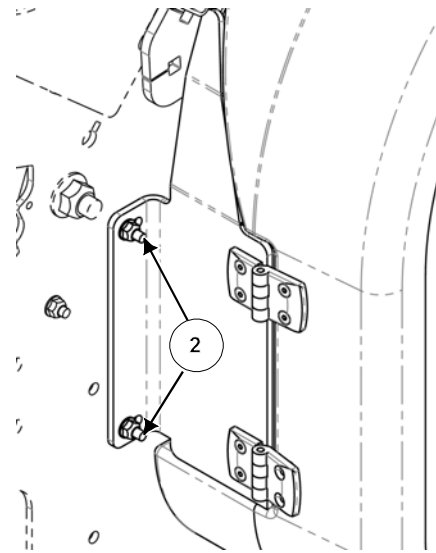

Fasten Shield to
Rear Tub Wall

46126_C2C

25. Install the door front and rear support brackets according to the chart and diagram.

Note: Tighten the locknut but allow the bracket to freely move around the bolt.

ITEM	DESCRIPTION
1	BOLT, HEX, 1/2X1-3/4, UNC, GR5, ZP
2	NUT, NYLOCK, 1/2, UNC, ZP
3	WASHER, FLAT, 1/2, ZP
7	BRACKET, FC DOOR

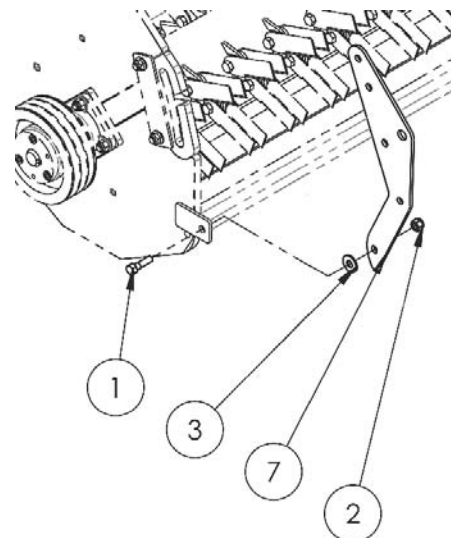

Install the Door Supports

46318_A

26. Slide the chopper door into the housing.

- Place the rods of the door handles (2) into the slots.
- Allow the door to go to the bottom of the slots.

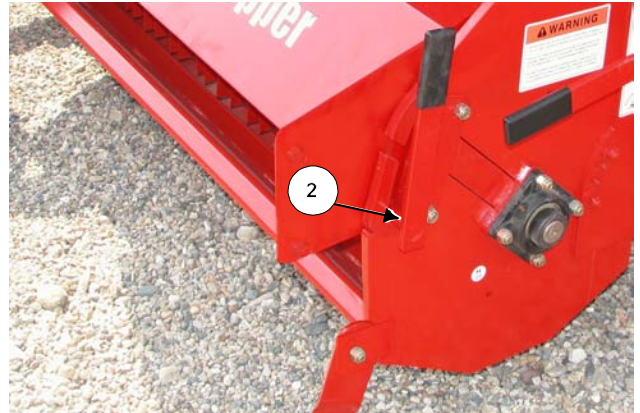

Install the Feed Chopper Door

221445C

27. Rotate the chopper door to the Feed Chopper operating position.

- Fasten with the door support brackets into the hole marked "C".
- Secure in place with the spring pins .



Rotate the Door to the Operating Position

221311