

## Installation of the Electric Selector Valve On The BP 661

The electric selector valve is used to switch the hydraulic flow between the bale lift/dump cylinders and the discharge door cylinder.



Shut down the tractor and remove the key before repairing, servicing, lubricating or cleaning the machine.

Relieve all hydraulic pressure in the hoses. Disconnect the hydraulic hoses from the tractor before going near the machine.

Securely block the machine to avoid any movement while doing the work.



**Do Not Enter Tub While Parts Are Rotating**

Before entering the tub:

- Turn off the tractor and remove the key.
- Wait for rotating parts to stop

Contact with the rotating flail drum will cause serious injury or death.



Installed Electric Selector Valve

221436



1. Install the selector valve (1) onto the top of the bracket between the front hitch members.

- Mount the valve with the electrical connections facing upward and toward the tub wall.
- Use 2 of 1/4" X 3 1/2" carriage bolts (2), and flange locknuts (3) to mount the valve.

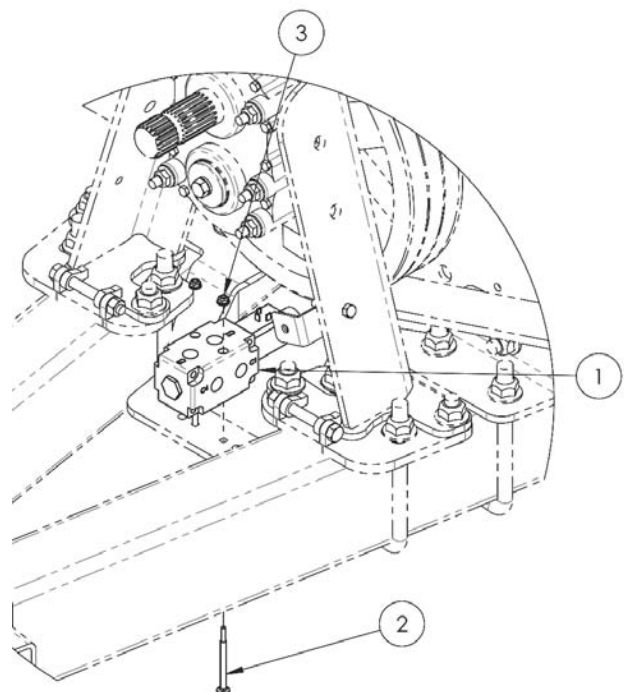

## Installation of the Electric Selector Valve On The BP 661

2. Remove both hydraulic hoses that are connected to the discharge door cylinder.
  - Leave the orifice and elbow in the rod end of the cylinder.
  - Leave the elbow in the base end of the cylinder.
  - Discard the hoses.



Remove Door Cylinder Hydraulic Hoses

221121

3. Connect the new hydraulic fittings and hoses according to the table and drawings shown below.

ITEM	DESCRIPTION
1	HYD,FIT,PIONEER,MALE,8FP
2	HYD,FIT,ADAPTER,8MB-8MJ
3	HYD,FIT,ELBOW,8FJX-8MJ90
4	HYD,HOSE,3/8X62,8FJX-8FJX,2W
5	HYD,HOSE,3/8X144,8MP-8FJX,2W
6	HYD,HOSE,3/8X76,8FJX-8FJX,2W

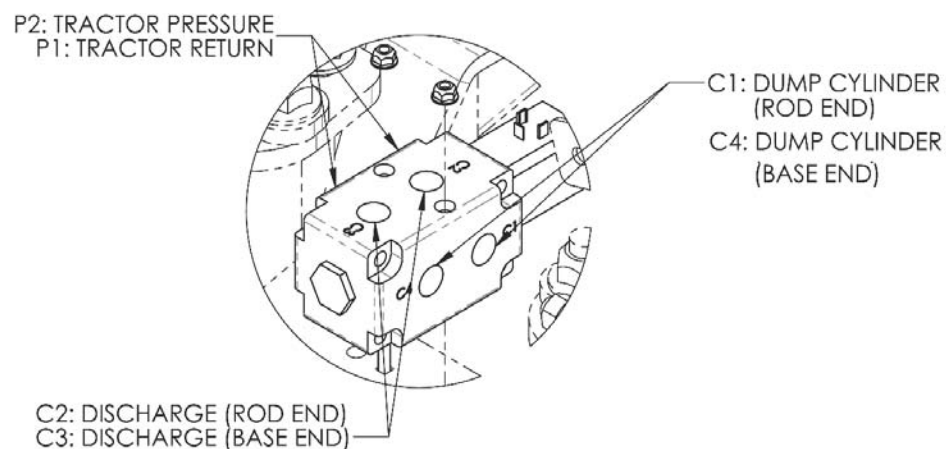

Selector Valve Connections

46601\_A2

## Installation of the Electric Selector Valve On The BP 661

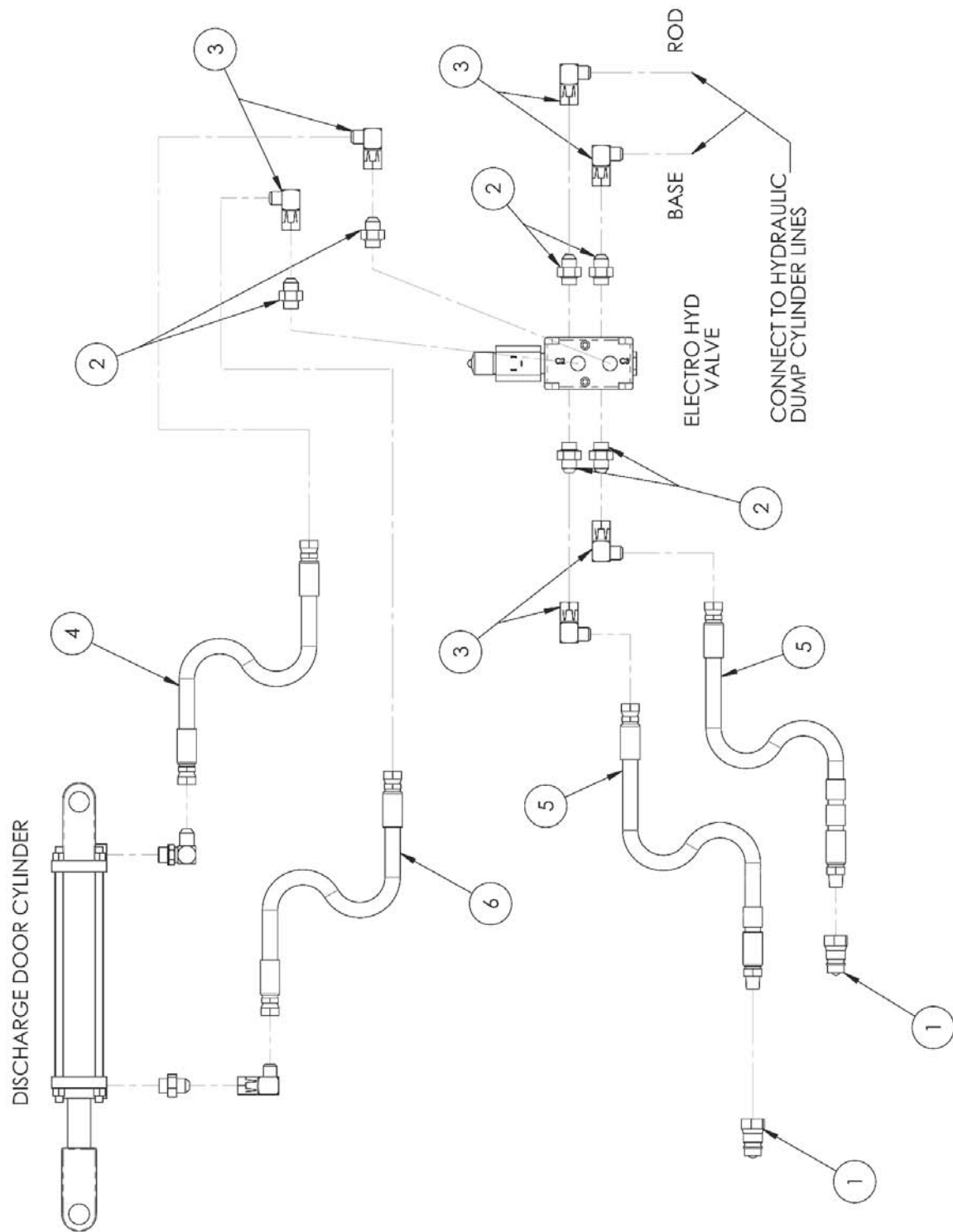

Hydraulic Fittings and Hoses

46586\_A

## ***Installation of the Electric Selector Valve On The BP 661***

---

4. Route the hoses (5) that go to the tractor through the non-abrasion cover and through the hose holder.
5. Use zipties as required to keep the hose routing tidy and away from areas that may damage the hoses.
6. Route the electrical harness from the solenoid valve through the hose holder and to the tractor cab.
7. Connect the electrical harness to the solenoid valve connector.
8. Connect the electrical harness to the selector switch in the tractor cab.
9. Connect the harness to the positive and negative terminals of a 12 volt power supply.



Route Hoses through Non-Abrasion Cover  
and through Hose Holder

221380