



Park the BP 661 on level ground.

Lower the forks to the ground for additional stability.

Ensure the BP 661 upper discharge door is locked in the upright position.

Disconnect the drive shaft from the tractor before beginning any work. Disconnect the BP 661 from the tractor hitch.

Block the machine to prevent any movement while assembling.



Shut down the tractor and remove the key before repairing, servicing, lubricating or cleaning the machine.

Relieve all hydraulic pressure in the hoses. Disconnect the hydraulic hoses from the tractor before going near the machine.

Securely block the machine to avoid any movement while doing the work.



**Do Not Enter Tub While Parts Are Rotating**

Before entering the tub:

- Turn off the tractor and remove the key.
- Wait for rotating parts to stop

Contact with the rotating flail drum will cause serious injury or death.

1. Set the guard rod adjustment handle to the number 3 position.
2. Lock the flail drum by placing the lock pin into the tube on the front tub wall.
  - Rotate the flail drum and push the lock pin down firmly to ensure it is engaged.

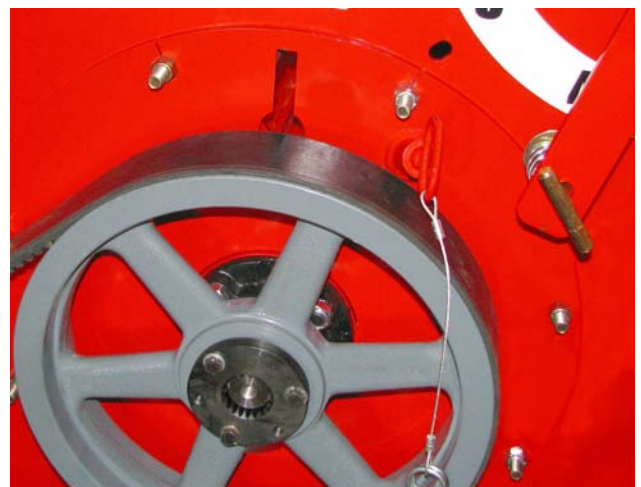

Lock the Flail Drum

221135

## Assembly of the Hydraulic Aggression Control on the BP 661

3. Inside the tub, place some wooden blocks between the flail drum and the guard rods to prevent the rods from falling when the adjustment handle is removed.



Block Up the Guard Rods

221416

4. At the front tub wall remove the fasteners (1) that hold the guard adjustment handle (2) to the adjustment rod.
  - Keep these fasteners to be re-used later.
  - Remove the adjustment handle (2) and lock by pulling them forward.
  - Discard the handle and lock..



Remove the Guard Rod Handle

221384C

5. Place the adjustment link (4) onto the adjustment rod.
  - Fasten in place with hardware removed earlier.

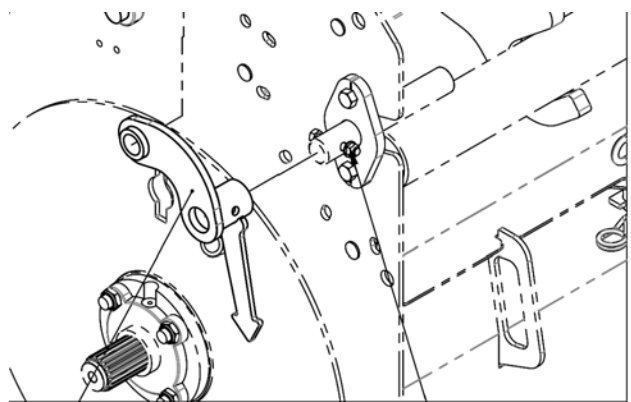

Place New Link Onto Adjustment Rod

43652

## Assembly of the Hydraulic Aggression Control on the BP 661

6. Fasten the cylinder support bracket (5) to the front tub wall with 2 of ½" x 1-1/2" carriage bolts and flange locknuts (6).

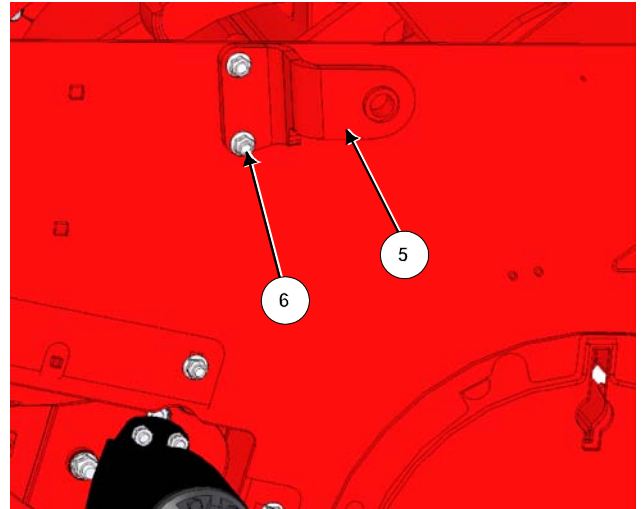

Fasten Cylinder Support Bracket to Tub Wall 46352-1C

7. Use the cylinder pins to attach the hydraulic cylinder to the support bracket and the adjustment link.
  - Attach the base of the cylinder to the support bracket on the tub wall.
  - Place the hydraulic cylinder with the ports facing downward.

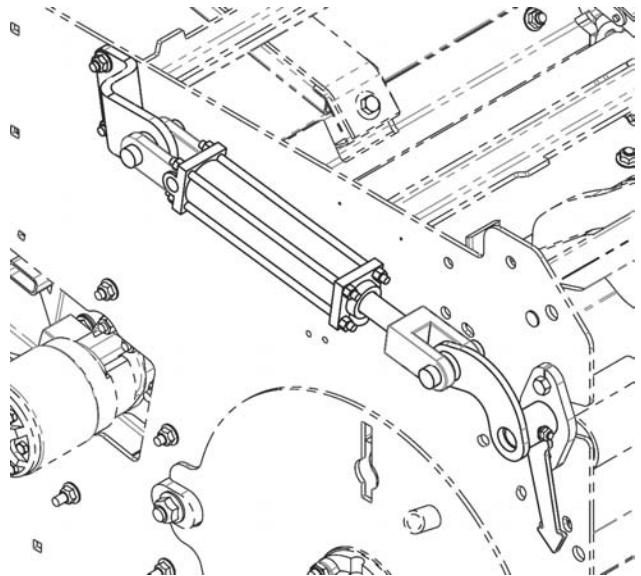

Attach the Cylinder to the Bracket and Link 43652-2

## Assembly of the Hydraulic Aggression Control on the BP 661

8. Install the hydraulic fittings and hoses according to the chart and diagram below.

ITEM	DESCRIPTION
1	HYD,FIT,PIONEER,MALE,8FP
2	HYD,FIT,ADAPTER,8MB-8MJ,031 ORIFICE
3	HYD,FIT,ELBOW,8MB-8MJ90
4	HYD,HOSE,3/8X120,8MP-8FJX,2W
5	HYD,HOSE,3/8X110,8MP-8FJX,2W
6	HYD,FIT,ELBOW,8FJX-8MJ90

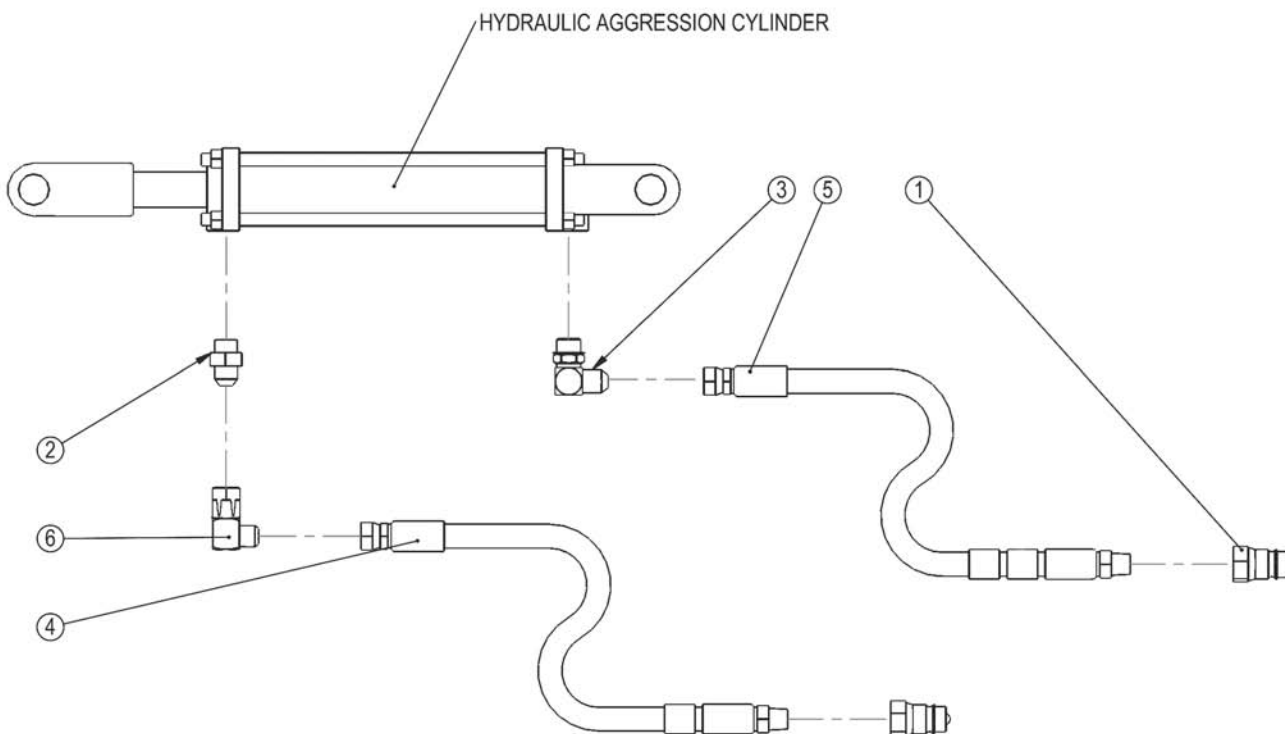

Attach Fittings and Hoses

46353\_A

## ***Assembly of the Hydraulic Aggression Control on the BP 661***

---

9. Route the hoses through the non-abrasion cover and the hose holder.



Route the Hoses through the Non-Abrasion Cover and the Hose Holder

221380

10. Remove the wooden blocks from between the flail drum and the guard rods.



Remove Wooden Blocks from Guard Rods

212072

