

Installation of the Top Gun End Deflector



Shut down the tractor and remove the key before repairing, servicing, lubricating or cleaning the machine.

Relieve all hydraulic pressure in the hoses. Disconnect the hydraulic hoses from the tractor before going near the machine.

Securely block the machine to avoid any movement while doing the work.



Do Not Enter Tub While Parts Are Rotating

Before entering the tub:

- Turn off the tractor and remove the key.
- Wait for rotating parts to stop

Contact with the rotating flail drum will cause serious injury or death.



Note: The parts to be removed and installed are heavy. Use lifting straps and equipment rated to lift the parts.

1. Attach a lifting strap to the lifting loop (1) on the top of the nozzle for supporting the weight and removing the nozzle.
2. Remove the eight bolts and nuts (2) that secure the nozzle to the base.
 - Remove the nozzle.
 - Keep the bolts and nuts for re-use.

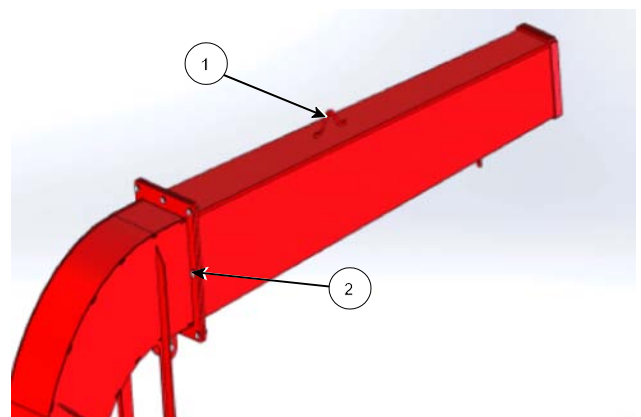

Lift Strap on Nozzle, Remove Fasteners

219193C

Installation of the Top Gun End Deflector

3. Lift the end deflector with a lifting strap through the lifting loop (1).
 - Position the deflector with the flange (2) aligned to the turret elbow flange.

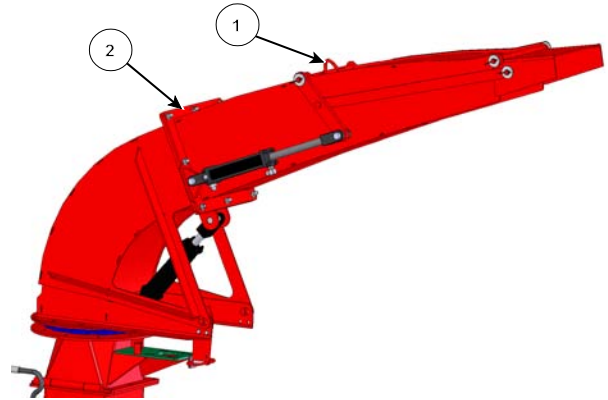

Lift Deflector, Align Flanges

219194C

4. Secure the new deflector to the turret elbow with the fasteners that had been removed earlier.

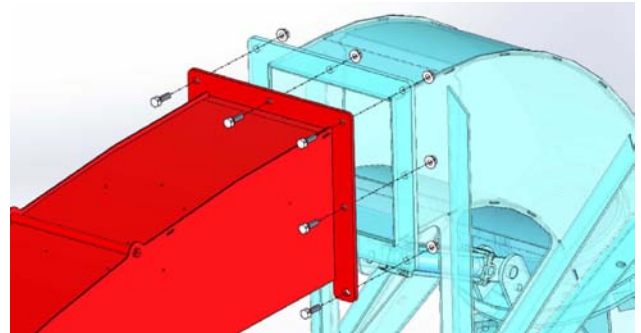

Use Fasteners to Secure Deflector to Elbow

219195

5. Install the hose holder (3) onto the angle at the base of the turret.
 - Fasten with 2 of 3/8" x 1" hex bolt and flange locknuts (4).

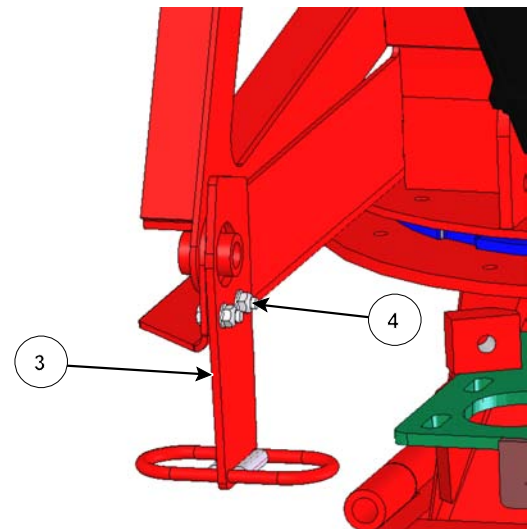

Install The Hose Holder to Turret Base

221051C

Installation of the Top Gun End Deflector

6. Attach the hose holder (5) onto the bottom of the turret extension.
 - Remove the existing bolts and locknuts. Discard these fasteners.
 - Attach the holder (5) to the bottom of the extension with 3 of $\frac{1}{2}$ " x $1\frac{3}{4}$ " carriage bolts and flange locknuts (6).

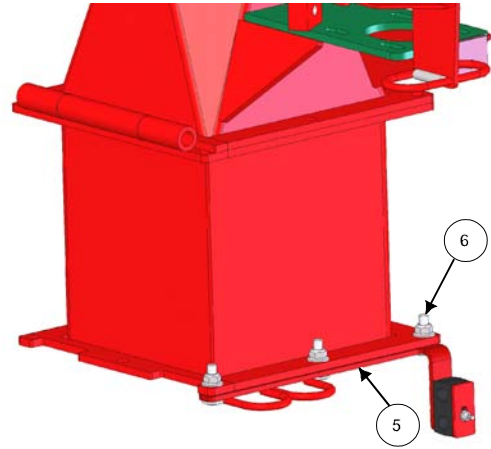

Attach Hose Holder to Bottom of Turret Extension

221052C

ITEM	DESCRIPTION
4	BOLT,CARR,1/4X2-1/2,UNC,GR5,ZP
5	BOLT,CARR,1/2X1-3/4,UNC,GR5,ZP
7	NUT,FLG,LOCK,1/2,UNC,GR5,ZP
8	NUT,FLG,LOCK,1/4,UNC,GR5,ZP
9	HYD,CLAMP,19/19,3015-3,3,PA
14	HOLDER,H0SE,TG
17	TOP PLATE,TWIN

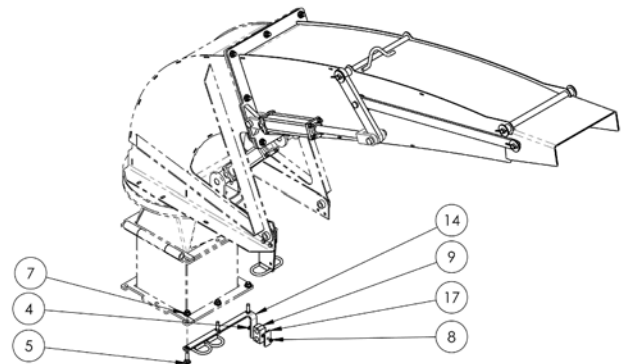

Installation of the Top Gun End Deflector

Joystick Controlled Top Gun - Hydraulic Connections and Operation

1. Attach the hydraulic fittings and hoses using the diagram below as a guide.

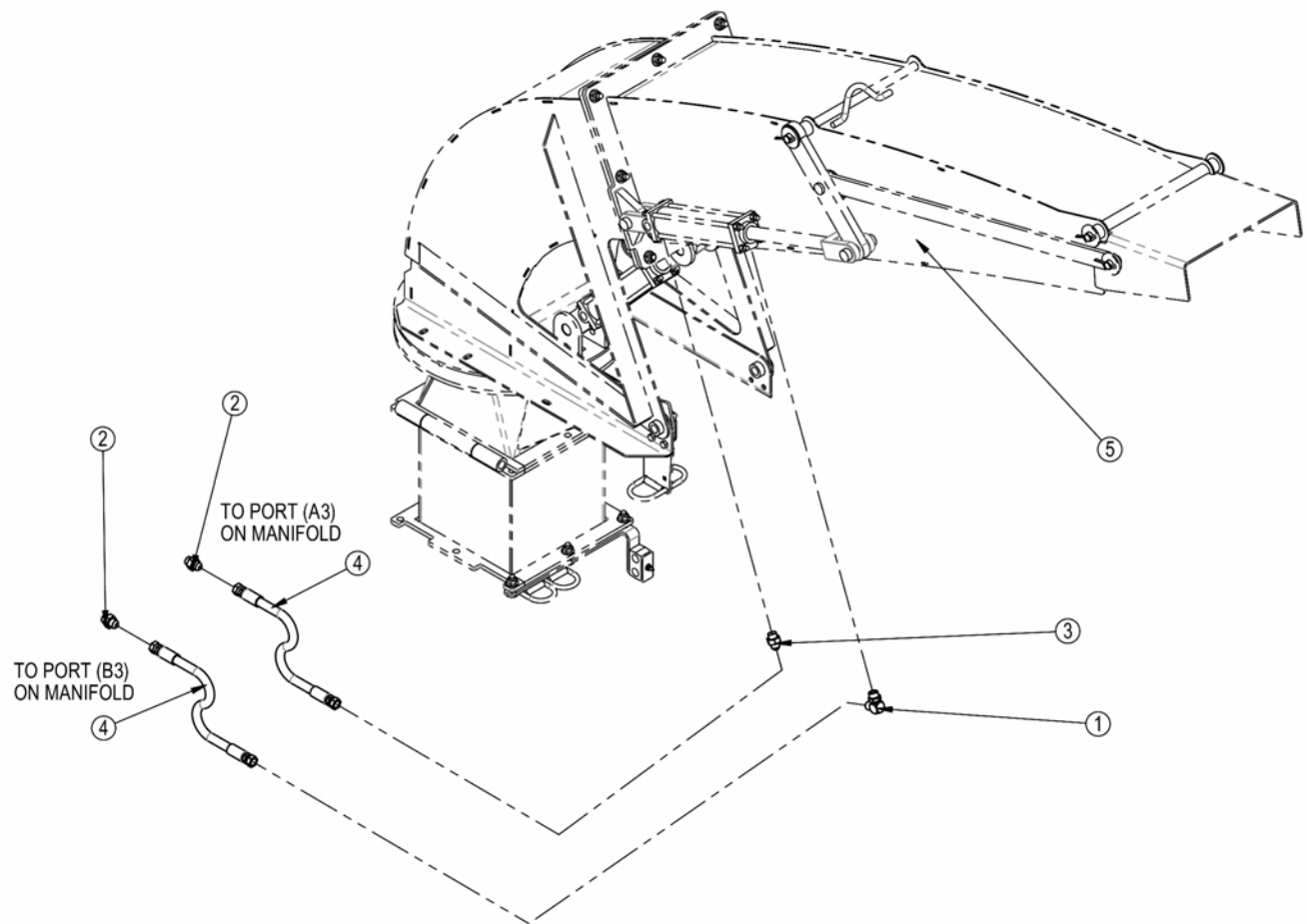

Attach Hydraulic Fittings and Hoses

219198

ITEM	DESCRIPTION	QTY.
1	HYD,FIT,ELBOW,8MB-8MJ90	1
2	HYD,FIT,ADAPTER,8MB-8MJ	2
3	HYD,FIT,ADAPTER,8MB-8MJ,031ORIFICE	1
4	HYD,HOSE,3/8X192,8FJX-8FJX,2W	2
5	ASSY,HYD END DEFLECTOR	1

Installation of the Top Gun End Deflector

2. Route the hoses through the loops and hose holders. (See diagrams below)
 - Leave slack in the hoses to allow for the rotation of the turret.
3. Fasten the hoses to the front of the tub wall using the hose clamp.
4. Route the hoses to the valve block/solenoid valve located under the front portion of the frame.

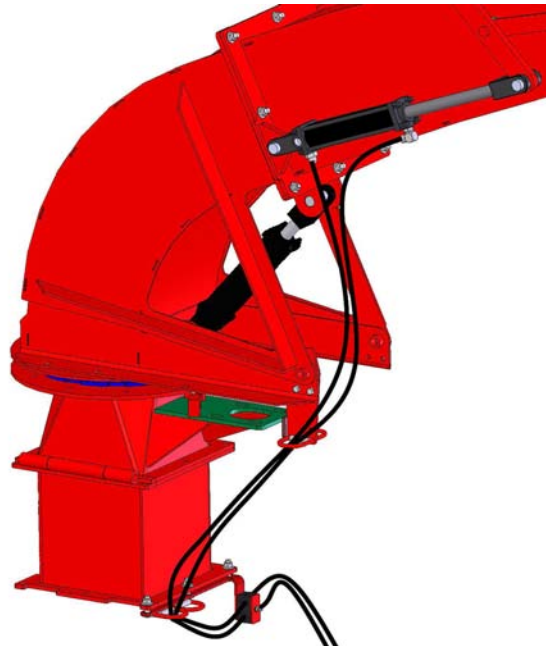

To Front Tub Wall

Route Hydraulic Hoses Through Loops and
Hose Clamp

219200

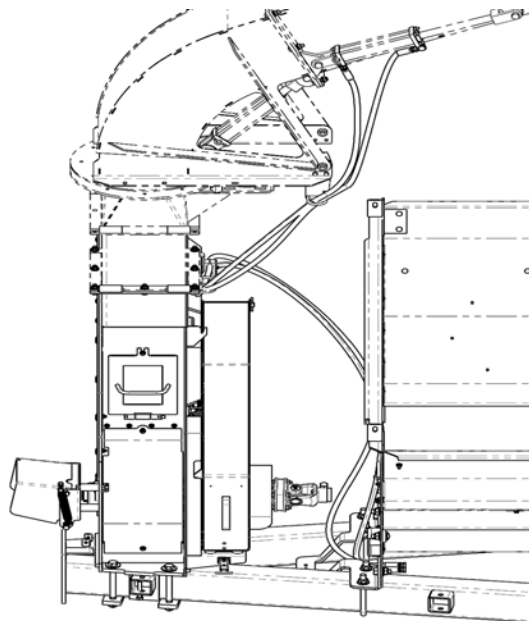

Route Hydraulic Hoses to the Hydraulic Block
Or Solenoid Valve Under Tub

219199

Installation of the Top Gun End Deflector

5. Connect the hoses to the hydraulic block.
 - Remove the plugs from ports A3 and B3.
 - Connect the cylinder base hose to port A3.
 - Connect the rod end hose to port B3.

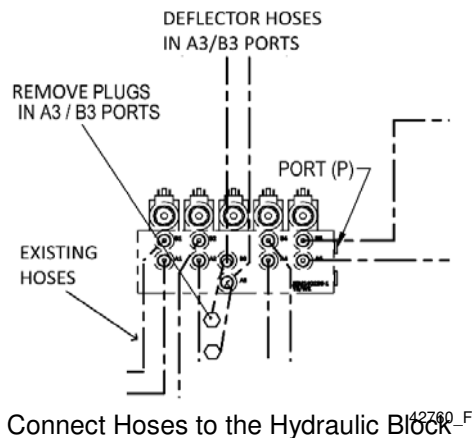

6. Rotate the turret throughout the entire range of travel with the spout in the up position to ensure that the lines do not snag on any part of the machine and there is adequate slack in all parts of the hydraulic line.
7. Repeat this process with the spout in the down position.
8. Secure the hoses with zip ties where necessary.

Using the End Deflector with the Joystick

1. The joystick will control the operation of the end deflector.

Some joystick decals indicate:

- Door (Raise) = Deflector Raise
- Door (Lower) = Deflector Lower
 - Use the joystick with the trigger depressed to raise or lower the end deflector.

Some joystick decals indicate:

- Accessory (Raise) = Deflector Raise
- Accessory (Lower) = Deflector Lower
 - Use the joystick with the trigger depressed to raise or lower the end deflector.

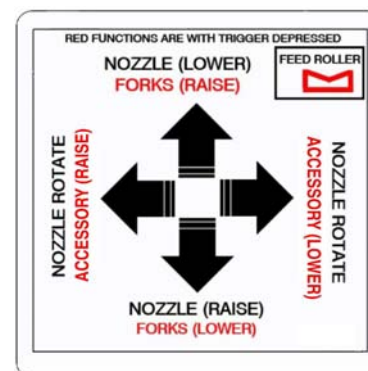
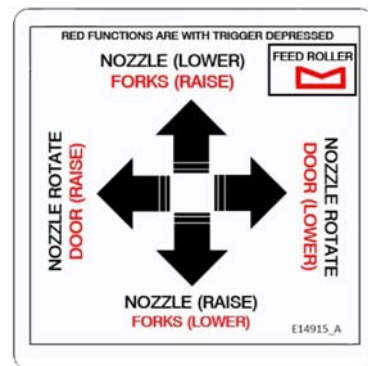

Joystick for Raise/Lower the
End Deflector E14915_A/Joystick Decal

Installation of the Top Gun End Deflector

Top Gun with 4 Remote - Hydraulic Connections and Operation

1. Attach the hydraulic fittings and hoses using the diagram below as a guide.

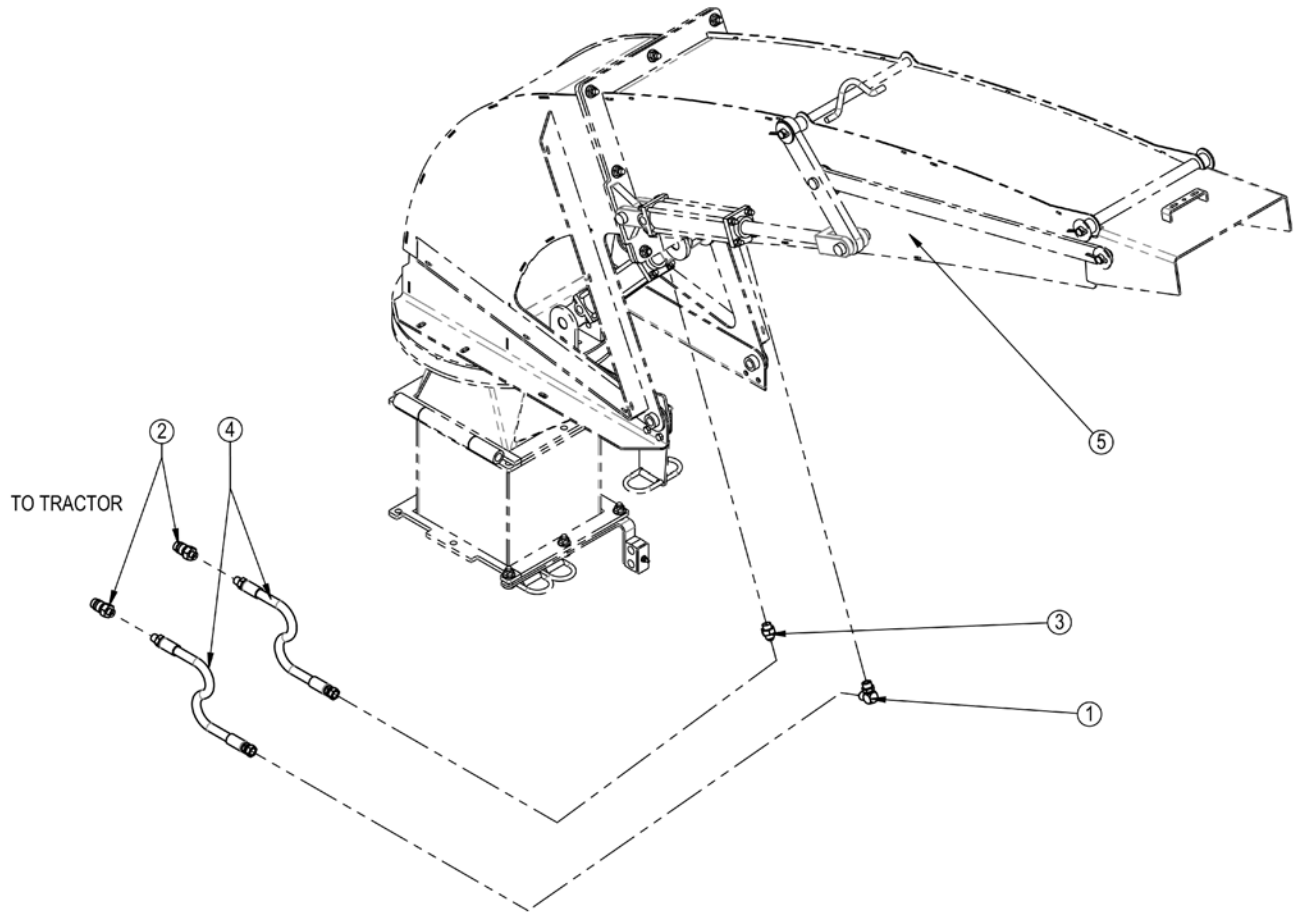

ITEM	DESCRIPTION	QTY.
1	HYD,FIT,ELBOW,8MB-8MJ90	1
2	HYD,FIT,PIONEER,MALE,8FP	2
3	HYD,FIT,ADAPTER,8MB-8MJ,031ORIFICE	1
4	HYD,HOSE,3/8X272,8MP-8FJX,2W	2
5	ASSY,HYDEND DEFLECTOR	1

Installation of the Top Gun End Deflector

2. Route the hoses through the loops and hose holders. (See diagrams below)
 - Leave slack in the hoses to allow for the rotation of the turret.

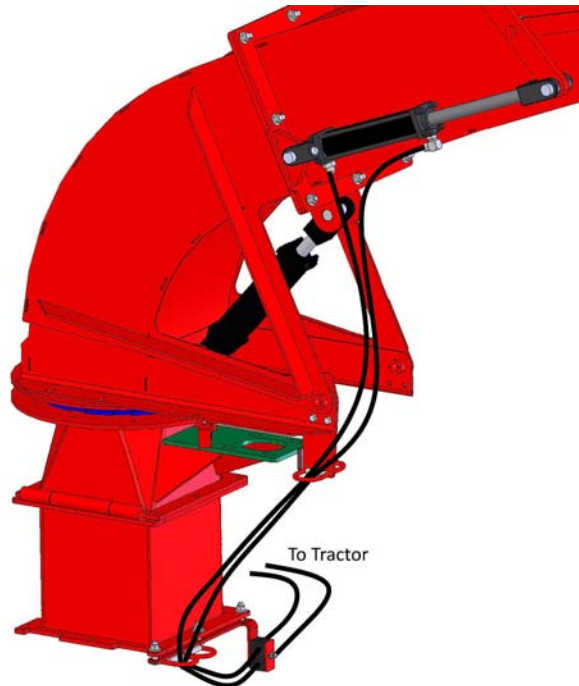

Route Hydraulic Hoses Through Loops and Hose Clamp
221053

3. Route the hoses to the hose holder on the hitch and onto the tractor.

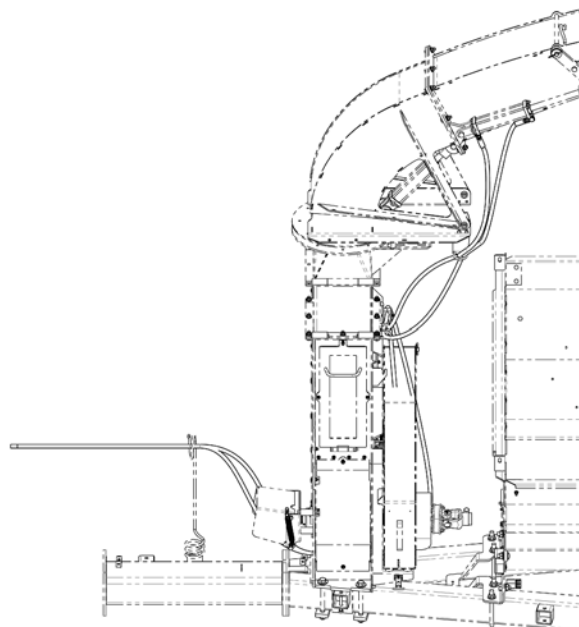

Route Hydraulic Hoses to the Tractor
45053_A2

Installation of the Top Gun End Deflector

4. Connect the hoses to a tractor remote.
5. Rotate the turret throughout the entire range of travel with the spout in the up position to ensure that the lines do not snag on any part of the machine and there is adequate slack in all parts of the hydraulic line.
6. Repeat this process with the spout in the down position.
7. Secure the hoses with zip ties where necessary.