

Installation of the Electric Hydraulic Valve On The CFR650

The electric hydraulic valve is used to switch the hydraulic flow between the feed rollers and the discharge door cylinder.



Shut down the tractor and remove the key before repairing, servicing, lubricating or cleaning the machine.

Relieve all hydraulic pressure in the hoses. Disconnect the hydraulic hoses from the tractor before going near the machine.

Securely block the machine to avoid any movement while doing the work.



Do Not Enter Tub While Parts Are Rotating

Before entering the tub:

- Turn off the tractor and remove the key.
- Wait for rotating parts to stop

Contact with the rotating flail drum will cause serious injury or death.

1. Remove the fasteners (1) from the hose clamp which is on the bottom of the bracket between the hitch tubes.

- Keep the clamp and fasteners to be re-used later.
- Move the hoses to the side to make room for installing the solenoid valve.

2. Install the solenoid valve (1) onto the top of the bracket.

- Mount the valve with the electrical connections facing upward and toward the tub wall.
- Use 2 of 1/4" X 3 1/2" carriage bolts (6), flatwashers (4) and locknuts (5) to mount the valve.



Remove the Front Hose Clamp

215092C

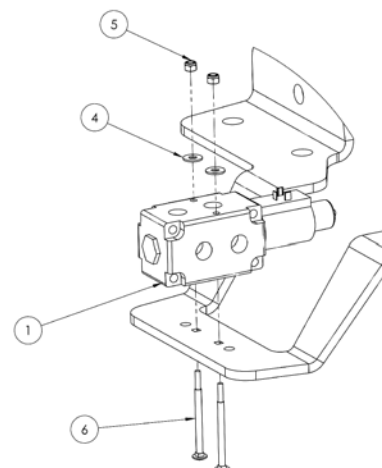

Install the Solenoid Valve

45580_A1

Installation of the Electric Hydraulic Valve On The CFR650

3. Remove the hydraulic hose (1) that comes out of the bottom of the flow divider and runs to the tractor.
 - Discard this hose.
4. Remove the hydraulic hose (2) that comes off the tee connection on the right feed roller motor. This hose runs to the tractor.
 - Discard this hose.
5. Remove both hydraulic hoses (3) that are connected to the discharge door cylinder.
 - Leave the orifice in the rod end of the cylinder.
 - Leave the elbow in the base end of the cylinder.
 - Discard these hoses.
6. Connect the new hydraulic fittings and hoses according to the table and drawing shown below.

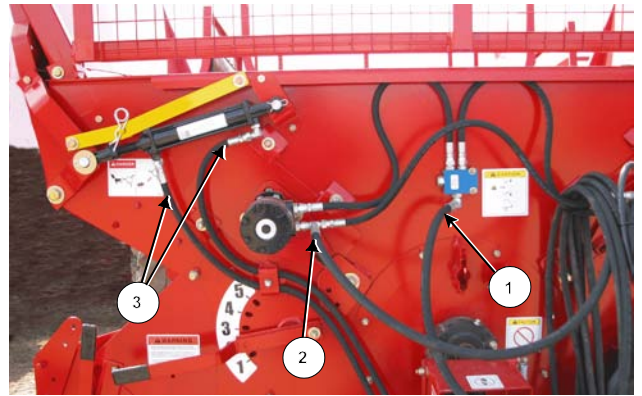

Remove Hydraulic Hoses

215093C

ITEM NO.	DESCRIPTION	QTY.
1	HYD,HOSE,3/8X57,8FJX-8FJX,2W	1
2	HYD,HOSE,3/8X62,8FJX-8FJX,2W	1
3	HYD,HOSE,1/2X96,8MP-8FJX,2W	2
4	HYD,HOSE,1/2X50,8FJX-8FJX90L,2W	1
5	HYD,HOSE,1/2X54,8FJX-8FJX90L,2W	1
6	HYD,FIT,ADAPTER,8MB-8MJ	6
7	HYD,FIT,PIONEER,MALE,8FP	2
8	HYD,FIT,ELBOW,8FJX-8MJ90	6
9	HYD,FIT,ELBOW,8FJX-8MJ45	1

Installation of the Electric Hydraulic Valve On The CFR650

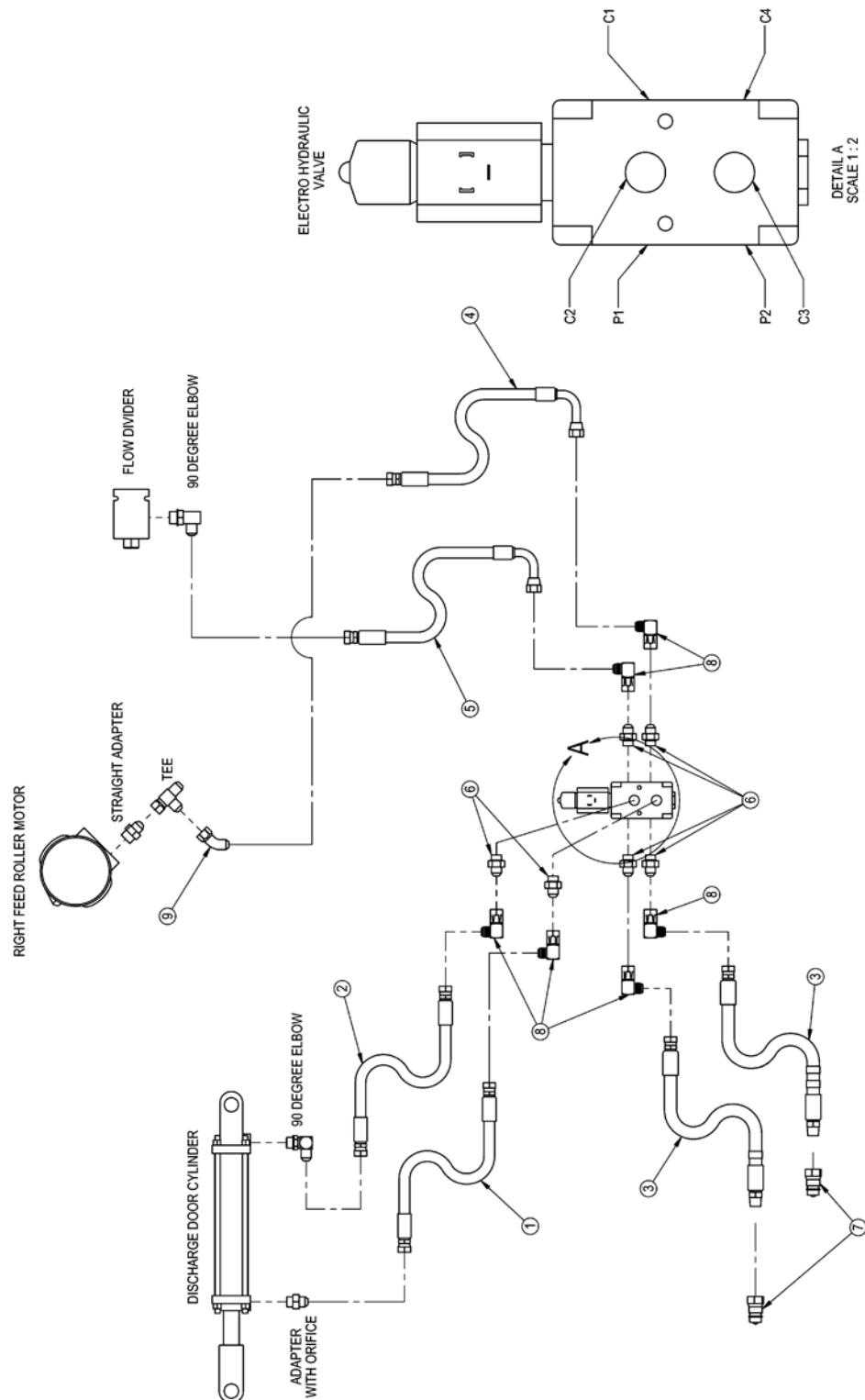

Fittings and Hoses

45578_A1

Installation of the Electric Hydraulic Valve On The CFR650

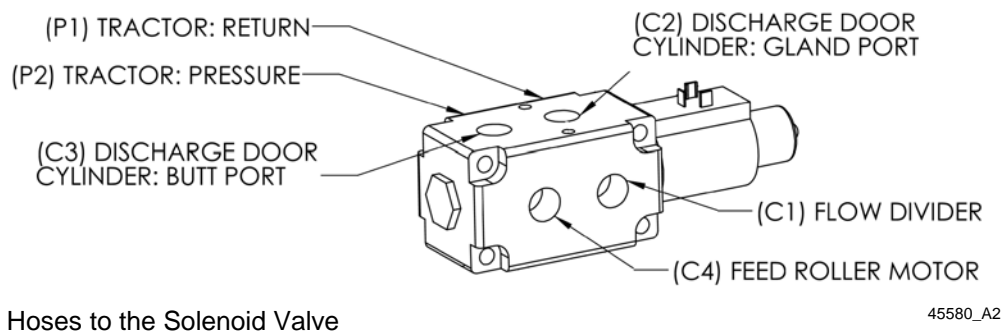

7. Use zipties as required to keep the hose routing tidy and away from areas that may damage the hoses.
8. Replace the hose clamp onto the hoses at the bottom of the bracket between the hitch tubes.
 - Connect the clamp with the fasteners removed in Step 1.
9. Route the electrical harness from the solenoid valve to the tractor cab.
10. Connect the electrical harness to the solenoid valve connectors.
11. Connect the electrical harness to the selector switch in the tractor cab.
12. Connect the harness to the positive and negative terminals of a 12 volt power supply.