

## Installation of the Right Rear Bale Deflector



Shut down the tractor and remove the key before repairing, servicing, lubricating or cleaning the machine.

Relieve all hydraulic pressure in the hoses. Disconnect the hydraulic hoses from the tractor before going near the machine.

Securely block the machine to avoid any movement while doing the work.



**Do Not Enter Tub While Parts Are Rotating**

Before entering the tub:

- Turn off the tractor and remove the key.
- Wait for rotating parts to stop

Contact with the rotating flail drum will cause serious injury or death.



## Installing the Right Rear Deflector

1. Place the top of the right rear deflector (1) on the outside of the tube of the rear right tub wall.
  - Place the lower lip of the deflector on the inside of the rear tub wall.
2. Attach the top of the deflector with a  $\frac{1}{2}$ " x  $2\frac{1}{2}$ " hex bolt (2) and flat washer (3) going into the slot of the deflector and through the tube from the outside of the machine.
  - Place a  $\frac{1}{2}$ " locknut (4) on the bolt.
  - Do not tighten at this time.

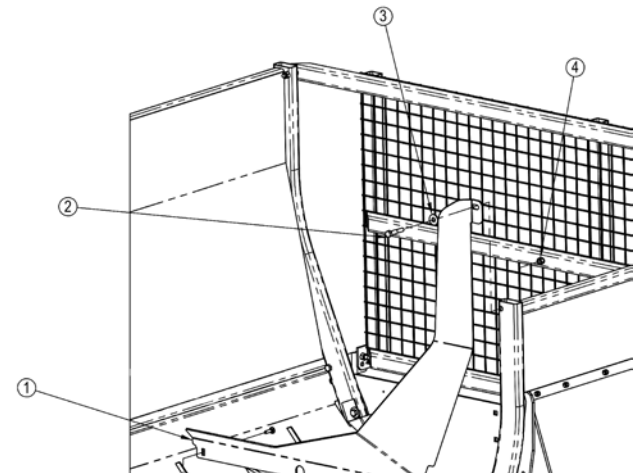

Attach the Top of the Deflector

45588\_A2

## Installation of the Right Rear Bale Deflector

---

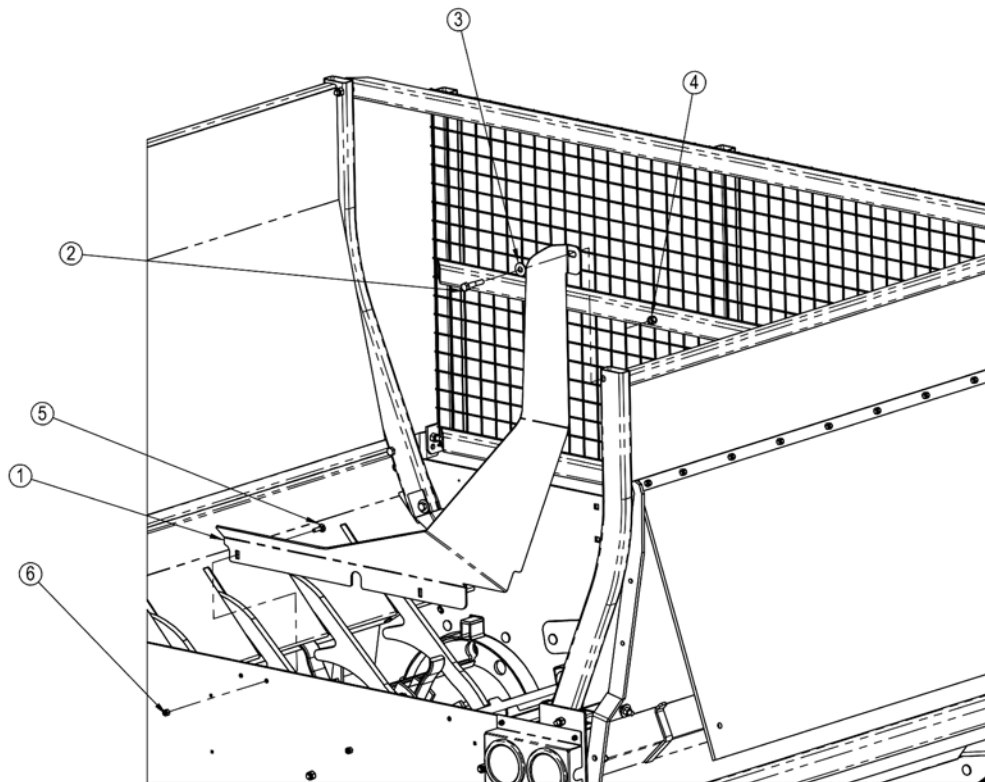

Installing the Right Rear Bale Deflector

45588\_A

3. Attach the lower lip of the deflector (1) to the inside of the rear tub wall with 2 of 3/8" X 1-1/4" carriage bolts (5).
  - Place the carriage bolts into the slots of the deflector and through the holes in the rear tub wall.
  - Place 3/8" locknuts (6) onto the bolts.
4. Adjust the position of the deflector.
5. Tighten all the fasteners.